

REFRIGERATION ACCESSORIES

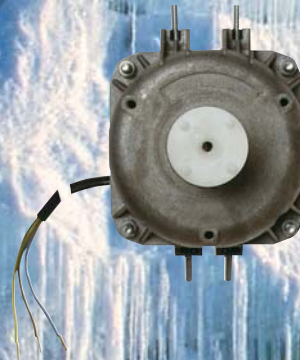

ACCESSORIES

MULTI-FIT MOTORS FOR VENTILATORS

VN--05-13/1056/V2	MULTI-FIT MOTOR FOR VENTILATOR 230/240V - 50/60Hz - 5/32W - 0.2 A - 1300/1550 RPM - cable length 550 mm.
VN--10-20/1103/V2	MULTI-FIT MOTOR FOR VENTILATOR 230/240V - 50/60Hz - 10/38W - 0.23 A - 1300/1550 RPM - cable length 540 mm.
VNT--18-30/46/V2	MULTI-FIT MOTOR FOR VENTILATOR 230/240V - 50/60Hz - 18/73W - 0.52 A - 1300/1550 RPM - cable length 530 mm.
VNT--25-40/25/V2	MULTI-FIT MOTOR FOR VENTILATOR 230/240V - 50/60Hz - 25/95W - 0.68 A - 1300/1550 RPM - cable length 520 mm.
VNT--34-45/25/V2	MULTI-FIT MOTOR FOR VENTILATOR 230/240V - 50/60Hz - 34/120W - 0.87 A - 1300/1550 RPM - cable length 510 mm.

DESCRIPTION

The 'VN'-series motors are shaded pole motors, a particular type of induction motor, coming from the permanent split capacitor (PSC) mode, where the start winding is substituted by a short break coil. The motors are particularly suitable for the refrigeration and ventilation sectors. The high technology used in manufacturing this motor and its particular mechanical structure give the motor robustness, low vibration and substantial efficiency. Especially designed to be coupled with axial fans, these motors are suitable to function in multi horizontal or multi vertical positions with a variety of fixings: rings, guards, stirrup brackets and flanges. All of the motors are supplied with aluminium alloy end-shields and black-painted stack. The shaft is mounted on self-aligning sleeve bearings with a lubrication reserve. The rotor is die-casted with a material which assures maximum electrical conductivity and the manufacturing process assures optimum electrical and mechanical balancing.

All motors are supplied with:

- 3 x M4 tapped front holes.
- Motor is closed with screws.
- 4 protruding screws on the shaft side for mounting a guard or a ring.
- Bottom/top fixing screw for bracket mounting.

TECHNICAL FEATURES

- All motors are CE marked, V.D.E. and U.L. certified.
- Single phase with 4 shaded poles, rated 230V and 50/60Hz.
- Power range from 5 W to 34 W output - relative to the stack length.
- Normally manufactured with class B materials, while internal protection is classified IP42. All motors are protected by their impedance or with a thermal cut-off in the windings.
- Operating temperature range from -35°C to +40°C.
- 5 fixations possible:
 - 3 tapped back holes Ø M4 at 120°, distance 72 mm.
 - 3 tapped front holes Ø M4 at 120°, distance 72 mm.
 - 4 protruding screws Ø M4
 - Base mounting, distance 18 mm (2 x M4 bolts)
 - Top mounting, distance 26 mm (screw + nut +O-ring)

Part number	A	B	C	E	F	G	H	I
VN--05-13/1056/V2	84	26	18	99	79	48	10	52
VN--10-20/1103/V2	84	26	18	99	87	49	11	59
VNT--18-30/46/V2	84	26	18	99	92	44	11	64
VNT--25-40/25/V2	84	26	18	99	112	53	10	84
VNT--34-45/25/V2	84	26	18	99	119	55	10	91

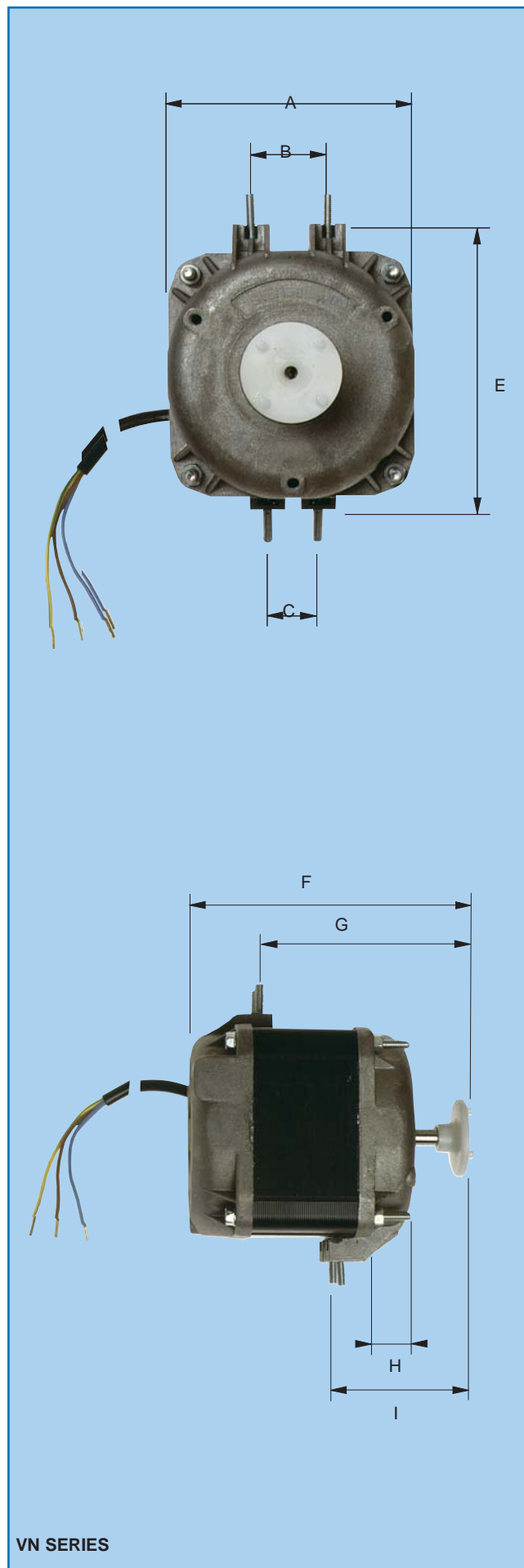

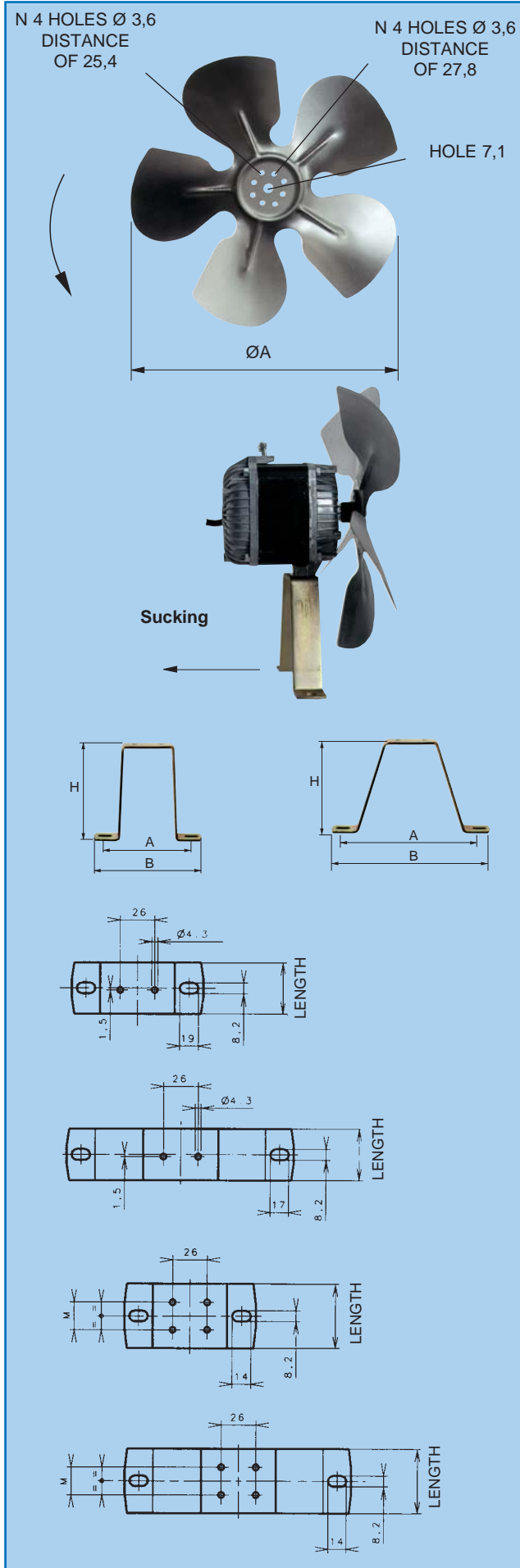

ALUMINIUM FANS

DESCRIPTION

- 5 blade aluminium axial.
- Shape and pitch especially created to maximise the aerodynamic efficiency.
- 2 main models:
 - Sucking** (air movement from fan to motor)
 - Blowing** (air movement from motor to fan)
- Fixation: 4 holes Ø 3,6 mm, distance 25,4 mm
4 holes Ø 3,6 mm, distance 27,8 mm
Centre hole Ø 7,1 mm
- Pitch: 28° (other pitch available on request)

1. ANTI-CLOCKWISE SUCKING FANS (AIR MOVEMENT FROM FAN TO MOTOR)

		X	Y	S
SF-28-154	Aluminium sucking fan, Ø 154 mm	34	17	0.8
SF-28-172	Aluminium sucking fan, Ø 172 mm	35	17	0.8
SF-28-200	Aluminium sucking fan, Ø 200 mm	37	18	0.8
SF-28-230	Aluminium sucking fan, Ø 230 mm	43	24	1
SF-28-254	Aluminium sucking fan, Ø 254 mm	45	24	1
SF-28-300	Aluminium sucking fan, Ø 300 mm	52	28	1.2

2. ANTI-CLOCKWISE BLOWING FANS (AIR MOVEMENT FROM MOTOR TO FAN)

		X	Y	S
BF-28-154	Aluminium blowing fan, Ø 154 mm	34	17	0.8
BF-28-172	Aluminium blowing fan, Ø 172 mm	35	17	0.8
BF-28-200	Aluminium blowing fan, Ø 200 mm	37	18	0.8
BF-28-230	Aluminium blowing fan, Ø 230 mm	43	24	1
BF-28-254	Aluminium blowing fan, Ø 254 mm	44	24	1
BF-28-300	Aluminium blowing fan, Ø 300 mm	57	34	1.2

Measurements in mm - tolerance: X = ± 2 mm, Y = ± 1.5 mm

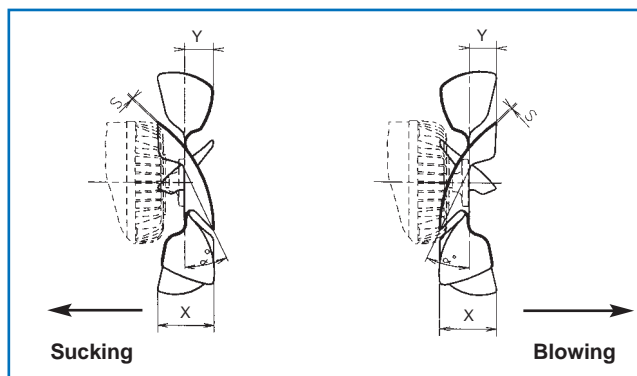

FAN BRACKETS

- Made out of zinc-coated steel.

1. STRAIGHT BRACKETS

PART NUMBER	TYPE	DIMENSIONS				
		A	B	LENGTH	H	M
SB-101	1	81	106	24	39	-
SB-103	1	81	106	24	52	-
SB-110	1	81	106	24	72	-
SB-113	1	81	106	24	84	-
SB-007	2	78	100	39	73	21
SB-049	2	78	100	39	84	21
SB-003	2	78	100	39	109	21
SB-002	2	78	100	49	109	31

2. DIVERGING BRACKETS

PART NUMBER	TYPE	DIMENSIONS				
		A	B	LENGTH	H	M
DB-152	1	130	152	24	52	-
DB-162	1	159	181	24	72	-
DB-157	1	142	164	24	84	-
DB-061	2	110	132	39	90	21
DB-009	2	150	172	49	112	31

FAN PULLER TOOL

MV-3570 COMPLETE CASE
Fan puller **KIT** containing all sizes

- A *PROFESSIONAL TOOL... FAST & EASY...*
- A simple method to remove fan from shaft without damage to fan, fan motor or shaft.



MV-3570



CONDENSATE REMOVAL PUMPS for general use

WCP-010/230V CONDENSATE PUMP, max capacity 10 l/h, for air-conditioners up to 10 kW
WCP-020/230V CONDENSATE PUMP, max capacity 20 l/h, for air-conditioners up to 20 kW

FEATURES

- Reciprocating piston water-pump and separate detection-module (3 levels) up to 2 m
- Compact and easy to conceal, suitable for residential and commercial installations
- Special mounting system permits fast, easy and reliable installation
- Suitable for wall mounting (splits, consoles, fan convectors) or ceiling mounting (ceiling units, double ceilings,...)

SPECIFICATIONS

- 3 detection levels: pump off (11mm)
pump on (16 mm)
alarm (19 mm) with relay
- Max. suction distance: 2 m
- Max. discharge distance: 6 m limited to a 2 m height difference
- 230V - 50/60Hz - 18W or 120V - 60Hz - 24 VA
- Alarm relay: NO – NC 8 A / 250V resistive
- Thermal overload protection: +70°C
- Noise level WCP-010: ≤ 30 dBA at 1 m
WCP-020: ≤ 34 dBA at 1 m
- Dimensions of pump-module: 78 x 60 x 36 mm (l x d x h)
- Dimensions of detection-module: 80 x 38 x 36 mm (l x d x h)
- Supplied with DHC-06x09/1M drain hose
- CE approved
- For accessories and spare parts, please consult us.

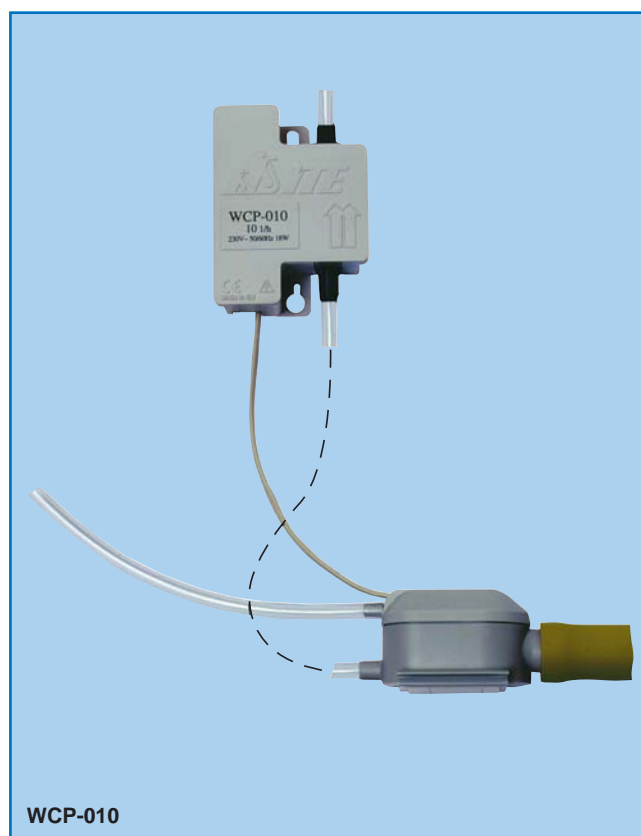

WCP-010

DRAIN HOSE

DHC-06x09 mm PVC CLEAR DRAIN HOSE, 6 x 9 mm dia, length 50 m
DHC-06x09/1M PVC CLEAR DRAIN HOSE, 6 x 9 mm dia, length 1m

FEATURES

- Flexible one layered PVC hose (non-reinforced)
- Applications include food products, medical labs and various industrial applications
- Food quality (PV IANESCO nr 10482 on 28/12/1990)
- Temperature: -15°C to +60°C
- For use at low pressures
- Weight: 44 gr/m

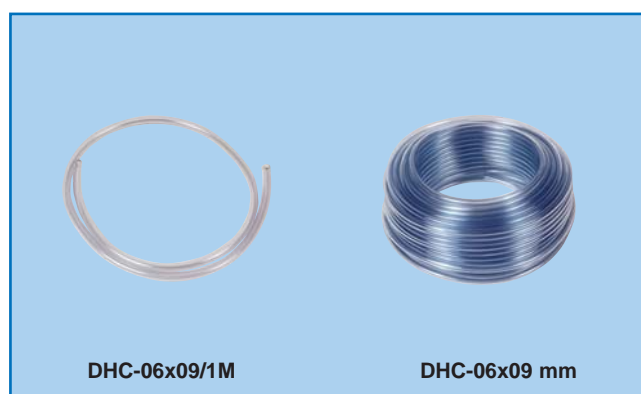

DHC-06x09/1M

DHC-06x09 mm

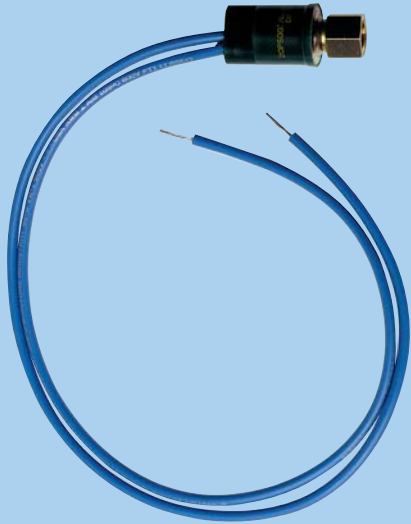

PS-LP-05

PRESSURE CONTROLS

- **UL** and **CSA** recognised easy Installation with the MV-8000 "solder on" valves or any $\frac{1}{4}$ " access fitting. All automatic reset controls have 46 cm leads for easy connection and core depressors to open access ports when installed.
- **CE approved.**

ADDING A LOW PRESSURE CONTROL

- Prevents compressor damage because of low refrigerant.
- Prevents ice-up or "slugging" the compressor with liquid refrigerant due to low ambient temperatures.
- Prevents the compressor from pumping air and thus, contaminating the system in the event of leaks.

PART NUMBER	OPEN		CLOSE		PROOF PRESSURE*	
	bar	Psi	bar	Psi	bar	Psi
PS-LP05-20	0.35	5	1.4	20	17.5	250
PS-LP25-80	1.75	25	5.6	80	35	500
PS-LP40-80	2.8	40	5.6	80	35	500
PS-HP200-150	14	200	10.5	150	35	500
PS-HP250-150	17.5	250	10.5	150	35	500
PS-HP300-200	21	300	14	200	42	600
PS-HP350-250	24.5	350	17.5	250	42	600
PS-HP400-200	28	400	14	200	42	600
PS-HP450-250	31.5	450	17.5	250	42	600

* Proof pressure: Pressure at which switch will be damaged.



PS-MF-HP

MANUAL RESET PRESSURE CONTROLS

PS-MF-HP-410	28,3 bar (410 Psi) cut-out (Open) $\pm 10\%$ Cut in (close) is manual reset 122 cm wire leads from electrical contacts $\frac{1}{4}$ " SAE female flare fitting
PS-MC-HP-440	29,3 bar (425 Psi) cut-out (Open) $\pm 10\%$ Cut-in (close) is manual reset 122 cm wire leads from electrical contacts / capillary tube Length and diameter: 91 cm of 2,4 mm (36" of $\frac{3}{32}$ " dia copper

PRESSURE SWITCHES

FEATURES

- Used to protect the compressor against excessive low or high pressures
- Possibility to start or stop the compressor, fans, etc
- SPDT (single pole double throw) switch to provide maximum contact options after installation
- Standard accessories include mounting bracket and screws to permanently fix the switches
- Factory set switches also available for OEM applications
- For use with all CFC, HFC and HCFC refrigerants as well as with air and water (allowable fluid temperature: -45°C to +135°C)
- Type HPS for universal application
- Micro-switch ensures reliable switching
- Various contact functions available
- **CE, TÜV, GS** approved



SINGLE TYPE - SPECIFICATIONS

PART NUMBER	PRESSURE RANGE (bar)		DIFFERENTIAL (bar)		FACTORY SETTING (bar)		Wt (kg)
	Min	Max	Min	Max	Off (On)	On (Off)	
PSBS-02*	-0.5	3	0.35	2	0.5	1.5	0.42
PSBS-04*	-0.5	6	0.6	4	2	3	
PSBS-03*	1	10	1	3	4	6	
PSBS-05*	5	20	3	5	15	12	
PSBS-10*	5	30	3	10	20	15	

* For manual model, add M to the part number. Example: PSBS-02 (auto) PSBS-02M (manual)

SINGLE TYPE - ELECTRICAL RATING

RATED AMPS (A)	RATED VOLTAGE (V)	
	AC 125V	AC 250V
Non-inductive current	10A	5A
Full load	8.5A	4.5A
Starting	40A	20A

SINGLE TYPE - DIMENSIONS

PART NUMBER	A	B	C
PSBS-02	38.5	38.9	22.4
PSBS-04	34.4	36	22.4
PSBS-03	34.4	36	22.4
PSBS-05	22	32.7	18.5
PSBS-10	22	32.7	18.5

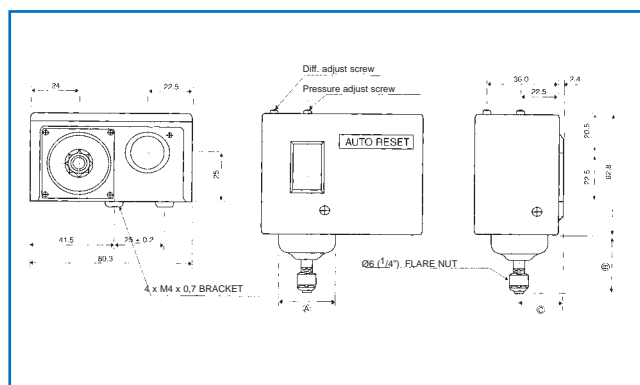

DUAL TYPE - SPECIFICATIONS

PART NUMBER		PRESSURE RANGE (bar)		DIFFERENTIAL (bar)		FACTORY SETTING (bar)		Wt (kg)
		Min	Max	Min	Max	Off (On)	On (Off)	
PSBD-606	Low side	-0.5	6	0,6	4	2	3	0.61
	High side	8	30	approx. 4 fixed		20	16	
PSBD-606M	Low side	-0.5	6	0,6	4	2	3	
	High side	8	30	manual reset		20	manual reset	

DUAL TYPE - ELECTRICAL RATING

RATED AMPS (A)	RATED VOLTAGE (V)	
	AC 125V	AC 250V
Non-inductive current	10A	5A
Full load	8.5A	4.5A
Starting	40A	20A

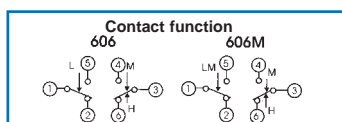

DIMENSIONS - DUAL TYPE

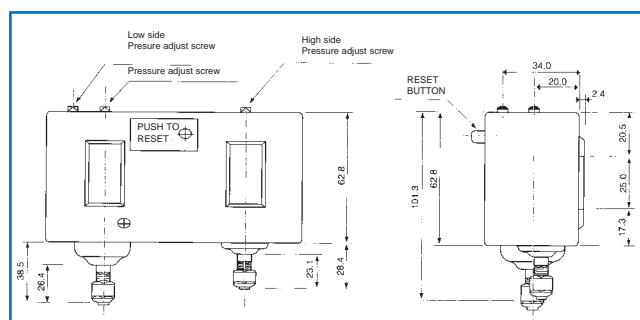



33490



33492

HEAT PUMP DEFROST THERMOSTATS

33490 **HEAT PUMP DEFROST THERMOSTAT**
for $\frac{3}{8}$ " tube mounting
Operating temperature +27°C (80°F) open
- 1°C (30°F) close

33492 **HEAT PUMP DEFROST THERMOSTAT**
for $\frac{1}{2}$ " tube mounting
Operating temperature +27°C (80°F) open
- 1°C (30°F) close

Heat pump defrost thermostats are designed for direct replacement of most existing controls of this type.

The temperature settings and tubing sizes have been carefully selected from the most popular OEM settings.

Each thermostat comes complete with extra long 1,38 m (54") leads, mounting clamp, and installation instructions for fast and simple field installation.

FEATURES

- Four controls cover most requirements
- Tapered mounting edge for maximum heat transfer
- Extra long 1,38 m (54") lead for simple wiring
- Individually boxed with mounting clamp and instructions.

SOLID STATE RELAY OVERLOAD

RO-41 **RELAY** 120 Volt, $\frac{1}{4}$, $\frac{1}{3}$ H.P.
RO-42 **RELAY** 220 Volt, $\frac{1}{4}$, $\frac{1}{3}$ H.P.
RO-62 **RELAY** 220 Volt, $\frac{1}{6}$, $\frac{1}{5}$ H.P.
RO-82 **RELAY** 220 Volt, $\frac{1}{12}$, $\frac{1}{10}$ and $\frac{1}{8}$ H.P.

APPLICATION

- **Replaces all** hermetic refrigerator compressor relay and overload units from $\frac{1}{12}$ H.P. through $\frac{1}{3}$ H.P., **115-220 Volts**.
- Can be used in conjunction with a start capacitor.

FEATURES

- Relay & overload is **now** in one combination unit. Pre-wired for **fast, simple** installation. Attached mounting clip makes installation easy.
- Superior locked rotor protection eliminates start winding over-heating.

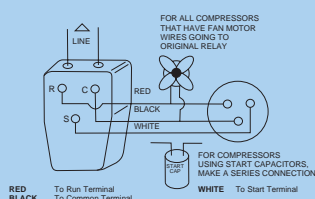

RO-42

SOLID STATE TIMERS

1. SOLID STATE TIMERS DELAY-ON-MAKE

32399 **SOLID STATE TIMERS DELAY-ON-MAKE,**
230V, 50/60Hz, 10 amp max.
5V volt drop at 10A steady current

FEATURES

- Easy two-wire installation
- Proven reliability, all solid state
- 6 mm quick connect terminals
- Mounts in any position
- Compact size
- High accuracy
- Totally enclosed and encapsulated for proper heat dissipation
- Time delay range: dial adjustable 10 - 1000 sec
- Heavy duty execution for high amperage up till 10A

SPECIFICATIONS

- 0,04 amp min. latch current

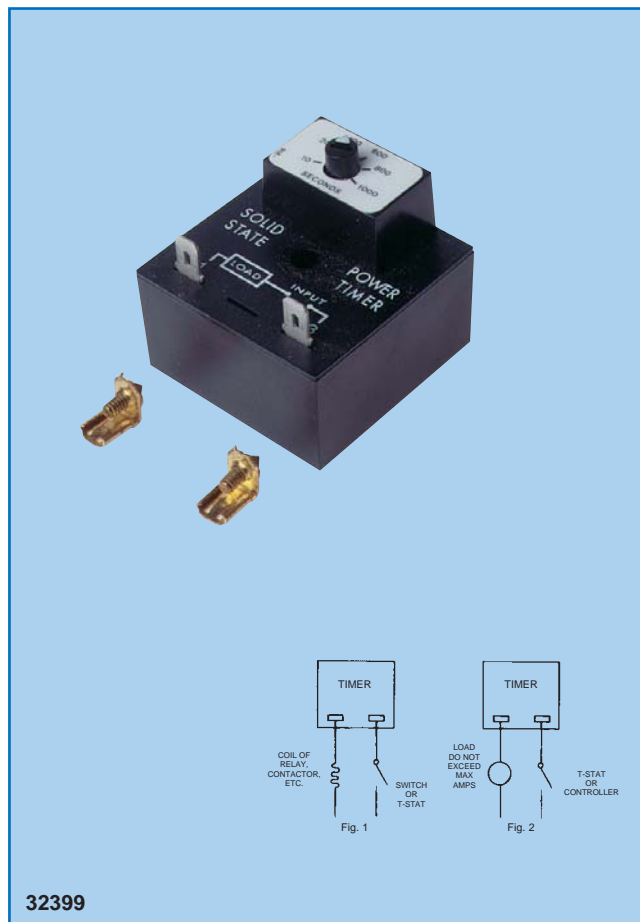

2. SOLID STATE TIMERS DELAY-ON-BREAK

Solid state delay on break timers are designed to prevent short cycling of air conditioning, refrigeration and heat pump compressors.

32392 **ADJUSTABLE SOLID STATE DELAY-ON-BREAK,**
19-288V, 50/60Hz
32387 **ADJUSTABLE SOLID STATE DELAY-ON-BREAK,**
24V, 50/60Hz

The 32392 is a versatile three wire timer that features adjustable timing and can be used with any voltage from 19 through 288 AC, 50 or 60Hz. The 32387 features easy to install two wire connection. It incorporates circuitry to allow continuous current flow through the thermostat anticipator.

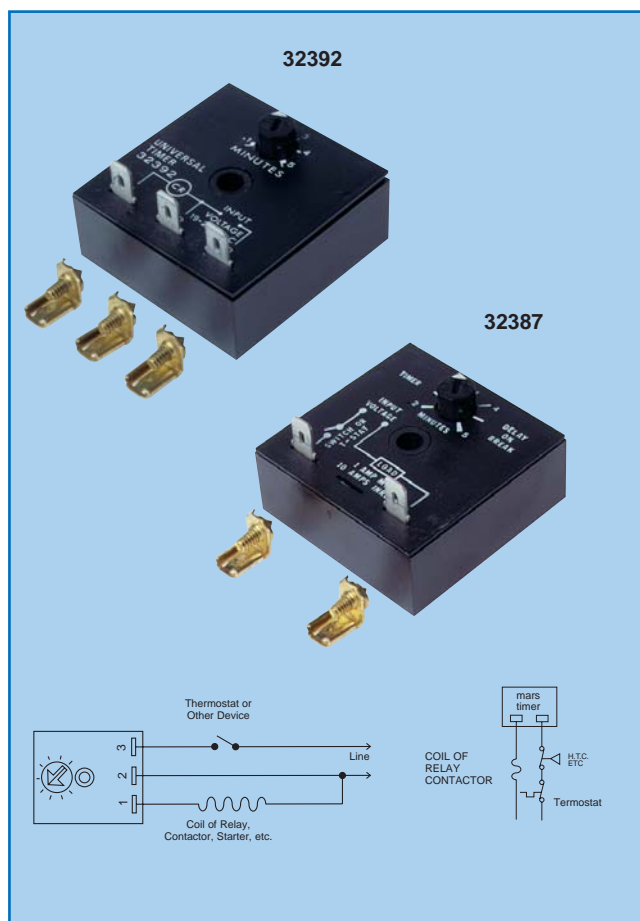



RSC-20

ICG-220

RELAYS

ICG-220

Can be mounted on the fence of a compressor with quick "snap-on-bracket" or installed using the fixing holes. 230V model

PO-230

Replaces all push-on current type relays on compressors with pin type terminals. It is the lowest resistance relay available with the FASTEST COOL DOWN TIME. 230V model

FEATURES

- One size for all compressors from $\frac{1}{12}$ - $\frac{1}{2}$ HP
- Can be used with or without a starting capacitor
- Easy to install

HARD START RELAYS + CAPACITORS

RSC-20

230 VAC applications from $\frac{1}{12}$ to $\frac{1}{2}$ HP (2000-4000 BTU)

Provides added boost for hard start and unbalanced systems

RCO-420

230 VAC - $\frac{1}{4}$ and $\frac{1}{3}$ HP

Completely prewired all-in-one unit replaces all 3 electrical components - relay, overload and start capacitor, on all capillary systems

SBS-1483

115-280 VAC applications from $\frac{1}{2}$ to 10 HP (4000-120000 BTU) Increased torque of 1,48 Nm

SBS-1907

115-280 VAC applications from $\frac{1}{2}$ to 10 HP (4000-120000 BTU) Increased torque of 1,90 Nm

SBS-2754

115-280 VAC applications from $\frac{1}{2}$ to 10 HP (4000-120000 BTU) Increased torque of 2,75 Nm

SBS-3178

115-280 VAC applications from $\frac{1}{2}$ to 10 HP (18000-120000 BTU) Increased torque of 3,18 Nm

SBS-3672

115-280 VAC applications up till 10 HP (120000 BTU) Increased torque of 3,67 Nm

FEATURES

- For all low voltage start problems
- Easy to install across the run capacitor terminals
- Various models with different increased torque feature
- To be used on all residential and commercial single phase RAC units and heat pumps.
- U.L. recognized

SCREW ON WIRE CONNECTORS

1. Normal ribbed connectors

25860

GRAY WIRE CONNECTOR - 300V

Wire combination range .64 mm dia to 1.29 mm dia.
Dimensions: 0,65 mm (min) - 2,62 mm (max).

25863

YELLOW WIRE CONNECTOR - 600V

Wire combination range 1.02 mm dia to 2.05 mm dia.
Dimensions: 1,64 mm (min) - 9,14 mm (max).

2. Connectors with wings act as a built-in wrench.

Provide extra leverage for secure connections every time.

25869

RED WING CONNECTOR - 600V

Wire combination range 1,02 mm dia to 3,26 mm dia.
Dimensions: 4,16 mm (min) - 16,55 mm (max).

25870

BLUE WING CONNECTOR - 600V

Wire combination range 1,63 mm dia to 4,12 mm dia.
Dimensions: 9,93 mm (min) - 29,9 mm (max).

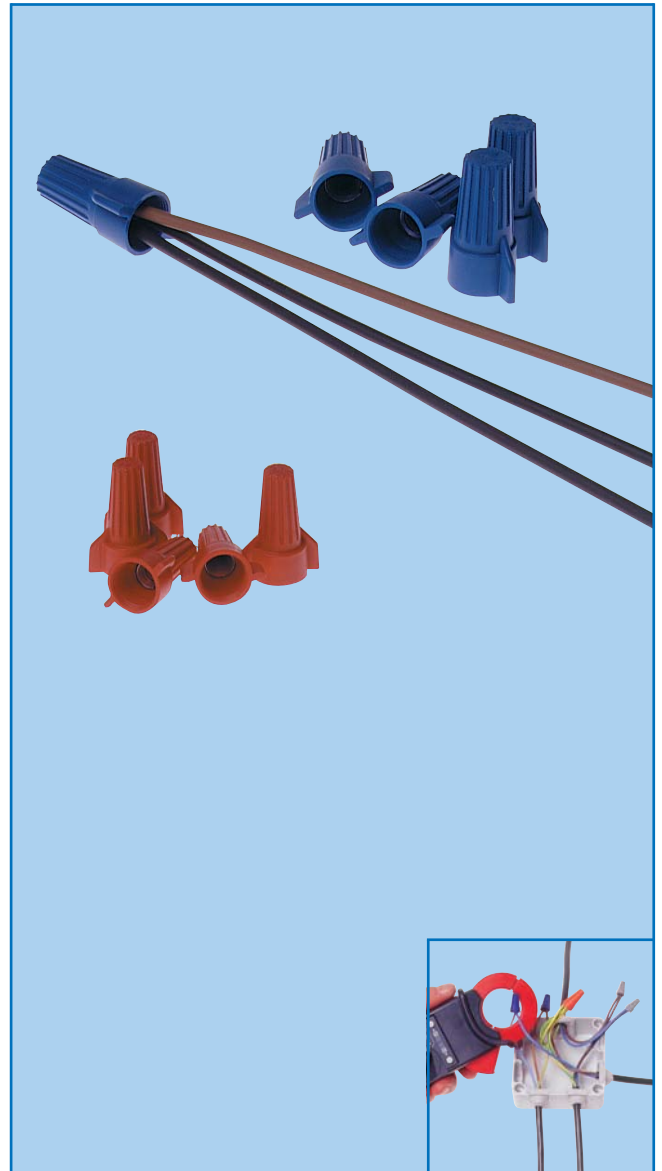

WIRE TIES

86111

WIRE TIE, 355 mm

Dia 102 mm (4") x 22,7 kg resistance

86107

WIRE TIE, 203 mm

Dia 44 mm (1 3/4") x 18 kg resistance

86109

WIRE TIE, 279 mm

Dia 76 mm (3") x 22,7 kg resistance

CT-ACP

CABLE TIE ADJUSTABLE CUT-OFF PLIER

Tight weight adjustable, auto cut-off, cable tie widths from 4,8 to 13,2 mm

WIRE TIES

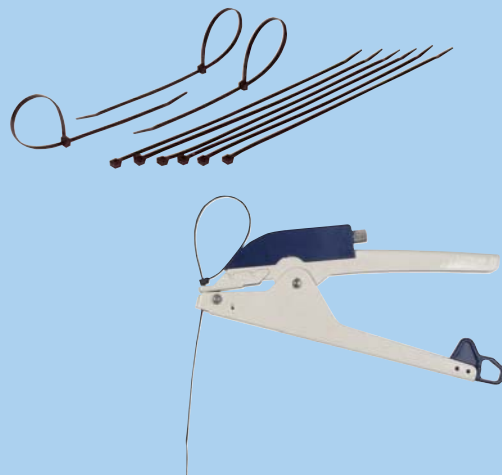

CT-ACP



CRANKCASE HEATERS

CH-101	HEATER 240 Volt / AC 54 Watt Girth: 70 to 87 cm (27 ⁷ / ₁₆ " to 34 ¹ / ₄ ")
CH-102	HEATER 240 Volt / AC 60 Watt Girth: 65 to 83 cm (25 ³ / ₄ " to 32 ⁹ / ₁₆ ")
CH-103	HEATER 240 Volt / AC 45 Watt Girth: 63 to 80 cm (24 ³ / ₄ " to 31 ⁹ / ₁₆ ")
CH-105	HEATER 240 Volt / AC 50 Watt Girth: 83 to 100 cm (32 ¹ / ₂ " to 39 ⁵ / ₁₆ ")
CH-135	HEATER 240 Volt / AC 40 Watt Girth: 52 to 69 cm (20 ⁵ / ₁₆ " to 27 ¹ / ₈ ")
CH-197	HEATER 240 Volt / AC 25 Watt Girth: 35 to 52 cm (13 ³ / ₄ " to 20 ⁹ / ₁₆ ")

FEATURES

- Stainless steel, moisture proof exteriors.
- Low power consumption.
- 30" Silicon rubber insulated leads.
- Fits snugly around the compressor housing.

REFRIGERANT CYLINDER HEATER

RCH-10	HEATING BELT For max temperature of +60°C (+140°F) Power consumption: 230V/400W New unique fastening system with spring allows use on most cylinders with different diameter (e.g. RCYL-12I, FRIOCATCH 14,3I, ... up to the big cylinders)
Dimensions	Length: 70 cm Width: 8 cm Minimum Ø: 23 cm Maximum Ø: 32,5 cm

WE CAN SUPPLY APPROVED EMPTY REFRIGERANT BOTTLES READY TO USE. SEE PAGE 36 OR ASK " ITE " ...

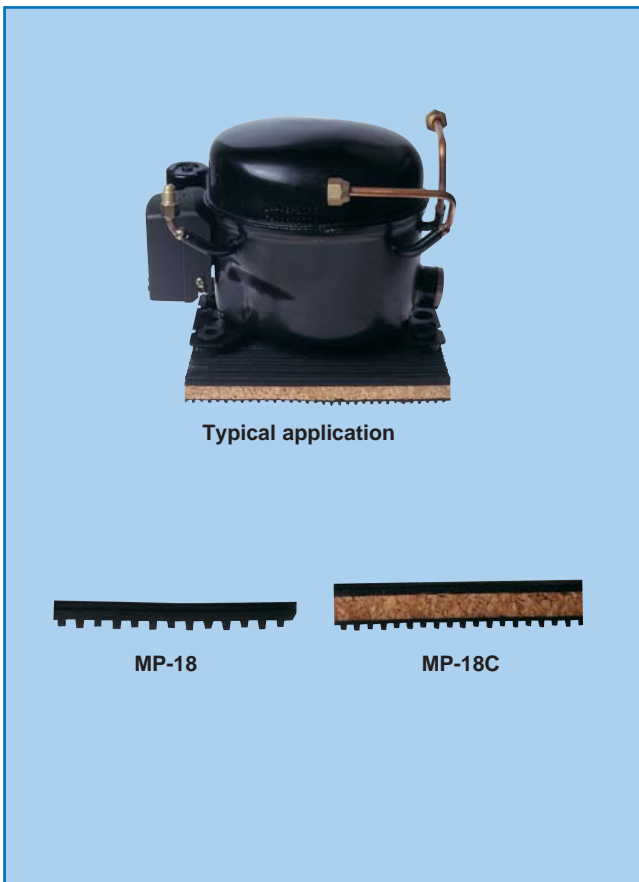

ANTI-VIBRATION MOUNTING PADS

MP-02	Sizes 51 x 51 x 9,5 mm	Rubber
MP-02C	Sizes 51 x 51 x 22 mm	Rubber/Cork
MP-03	Sizes 76 x 76 x 9,5 mm	Rubber
MP-03C	Sizes 76 x 76 x 22 mm	Rubber/Cork
MP-04	Sizes 102 x 102 x 9,5 mm	Rubber
MP-04C	Sizes 102 x 102 x 22 mm	Rubber/Cork
MP-06	Sizes 152 x 152 x 9,5 mm	Rubber
MP-06C	Sizes 152 x 152 x 22 mm	Rubber/Cork
MP-08	Sizes 203 x 203 x 9,5 mm	Rubber
MP-08C	Sizes 203 x 203 x 22 mm	Rubber/Cork
MP-12	Sizes 305 x 305 x 9,5 mm	Rubber
MP-12C	Sizes 305 x 305 x 22 mm	Rubber/Cork
MP-18	Sizes 457 x 457 x 9,5 mm	Rubber
MP-18C	Sizes 457 x 457 x 22 mm	Rubber/Cork

Highest quality neoprene and cork, oil resistant padding. Designed to withstand **4,2 kg per square cm**. The neoprene pads are corrugated on both sides and the cork is laminated with corrugated neoprene on both sides. Wherever bolting is to be avoided and minor, non-critical vibration conditions exist (pumps, motors, airconditioning units, generators etc.)

Rubber mounting pads can be used in any condition.

Mounting pads with cork are recommended for acoustic problem applications and can stand outdoor use, rain, ... but not permanent use under water.

ANTI-VIBRATION MOUNTING FEET

Rugged neoprene stud mounting feet for wide-range load with low natural frequency. Resists oil, ozone and caustic materials. Designed to withstand 5 kg per square cm. Ideal for rugged installations, industrial machinery, generators, blowers, pumps and compressors.

PART NUMBER	DIMENSIONS (mm)					LOAD (Kg)	
	L	W	H	ØD	A	Min	Max
MPF-M10	95	53	48	M10	10	50	150
MPF-M12	127	77	70	M12	14	100	200
MPF-M16	180	118	70	M16	14	500	1000

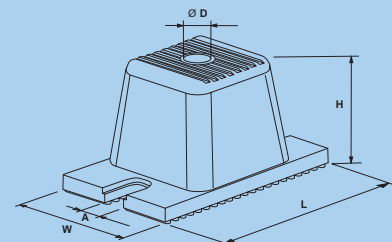

MPF-M10

Multiple-layer rugged ring mounting feet for wide-range load with low constant natural frequency. Ideal for transformers, office equipment, measuring instruments, blowers, pumps and compressors, machinery.

PART NUMBER	DIMENSIONS (mm)							LOAD (Kg)	
	ØD	H	A	B	d1Ø	d2Ø	t	Min	Max
MPR-M08	60	51	105	83	M8	11	2,5	30	80
MPR-M10	80	68	140	110	M10	13	3	60	150
MPR-M12	120	98	210	165	M12	15	3	120	300
MPR-M16	160	126	280	220	M16	19	4,5	280	700

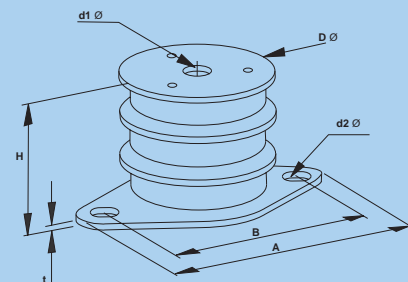

MPR-M08

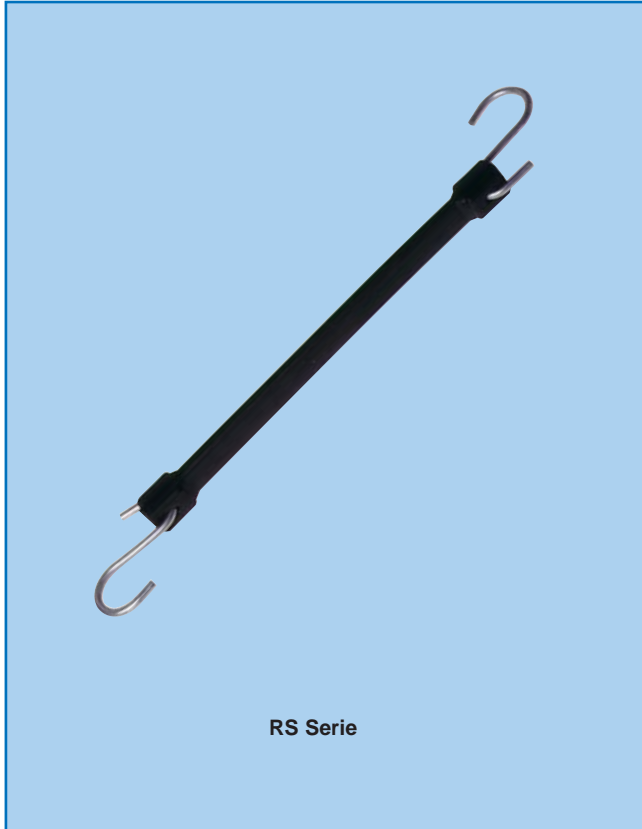

TIE DOWNS AND STRAPS

RS-09	RUBBER TIE DOWN	Length: 0,23 m
RS-15	RUBBER TIE DOWN	Length: 0,38 m
RS-20	RUBBER TIE DOWN	Length: 0,51 m
RS-31	RUBBER TIE DOWN	Length: 0,79 m

RATCH-IT STRAP

- Unique ratchet action permits tie-down of appliances securely, positively.

FEATURES

- Easy ratchet tensioning.
- **4,8 m.** strong nylon webbing (rated at 3000 psi tensile)
- Strong end hooks (rated at 1200 Psi tensile)
- Meets Mil. Spec. QQ-P-416

INNOVATIVE RATCHET BUCKLE

- Designed with an innovative latch and a fast release cam that reduces sprocket wear. This cadmium-plated steel buckle has a positive lock that eliminates release due to vibration. When closed, the handle locks the latch into the sprocket to prevent inadvertent release.

RUBBER TIE DOWNS

- Quickly ties down ladders, tubing, cylinders or almost anything in just seconds. Features extra heavy steel "S" hooks on each end.
- Designed with extra elasticity for wider variety of uses. Can stretch to double its length without breaking.

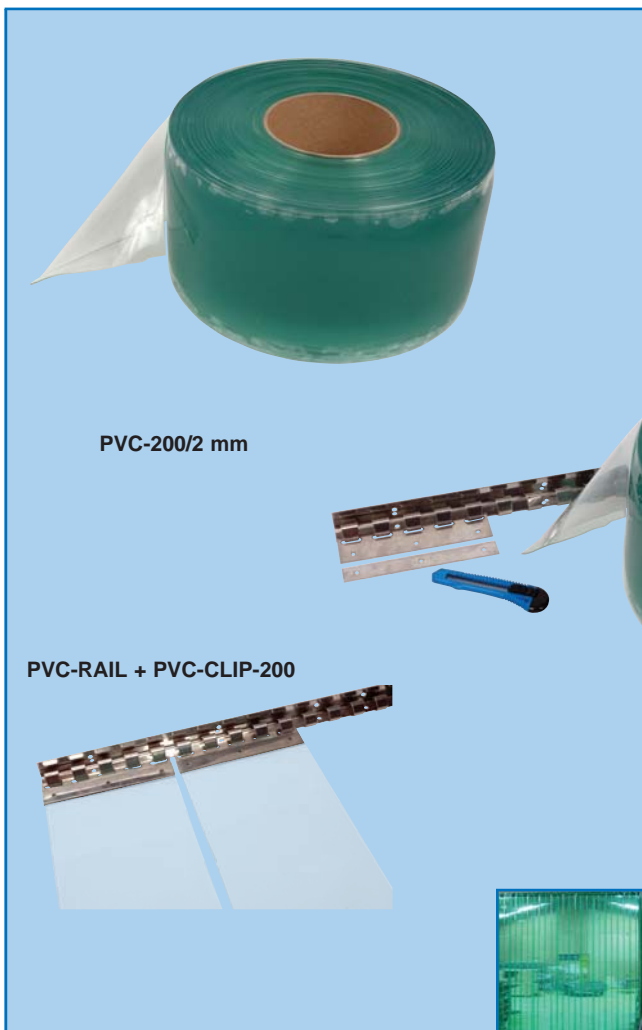

MULTI PURPOSE DOOR STRIPS

PVC-200/2 mm	PVC DOOR STRIP 200 mm wide x 2 mm thick x 50 m long
PVC-300/3 mm	PVC DOOR STRIP 300 mm wide x 3 mm thick x 50 m long
PVC-CLIP-200	PLATE SET for PVC door strip 200 mm long
PVC-CLIP-300	PLATE SET for PVC door strip 300 mm long
PVC-RAIL	HANGING RAIL 1 m long

FEATURES

- These door strips are made of flexible transparent PVC and are for example perfect to use as strip curtains to provide insulation and retain heat in buildings or rooms where frequent access is required by pedestrians, fork lift trucks etc.
- Applications include shop and factory partitions, protection of machinery, doorways to cold-rooms etc.
- Transparent crystal green finish
- Strips are UV resistant and remain flexible at low temperatures
- Rounded edges ensure no risk of injury or cuts to personnel
- Temperature: -40°C to +50°C
- Hardness: 65 ShA
- Tolerances:

Thickness:	+0 / -0,3mm
Width:	+0 / -5mm
Length:	+1 to +2%
Weight:	± 5%
- Hanging rails are made from stainless steel profile with preformed suspension hooks to receive the plate sets and are suitable for mounting within or in front of doorways
- Plate sets are stainless steel clamps which can fit the hanging rail suspension hooks or can be mounted directly. They are the same width as one strip and the strips are mounted with rivets or screws (not included)
- Weight: 0,48 kg/m for PVC-200 and 1,10 kg/m for PVC-300

UNIVERSAL BRACKETS

WBO-100	UNIVERSAL BRACKET with cross-bar, Capacity: 100 kg
WBO-100N	UNIVERSAL BRACKET without cross-bar, Capacity: 100 kg
WBO-120	UNIVERSAL BRACKET with cross-bar, Capacity: 120 kg
WBO-120N	UNIVERSAL BRACKET without cross-bar, Capacity: 120 kg
WBO-250	UNIVERSAL BRACKET with cross-bar, Capacity: 250 kg
WBO-150R	SLOPING ROOF BRACKET from 18° to 35°, Capacity: 150 kg
WBO-K10	Mounting accessories for WBO-100 and WBO-100X
WBO-K10N	Mounting accessories for WBO-100N
WBO-K12	Mounting accessories for WBO-120
WBO-K12N	Mounting accessories for WBO-120N
WBO-K15	Mounting accessories for WBO-150 and WBO-150X
WBO-K15R	Mounting accessories for WBO-150R
WBO-K25	Mounting accessories for WBO-250 and WBO-250X

FEATURES

- An elegant and practical fixing system made of pressed sheet stainless steel or pressed sheet varnished steel allowing rapid, easy and safe installation of any weight and dimension air conditioners.
- Allows wall, floor and roof installation for machines up to 250 kg and 55 cm depth.
- All the brackets are equipped with a 90° safety opening, pre-assembled with a stainless steel rivet system and complete with accessories useful for rapid and correct installation.

SPECIFICATIONS

- Stirrups: pressed sheet of 1,5, 1,8 or 2,0 mm thick
- Cross-bars: pressed sheet of 1,8 mm thick
- Varnishing: RAL 1013 polyester dust for external use
- Supplied in sets of 2, equipped with wall fixing kit and anti-vibration supports
- 5 year warranty on varnishing against corrosion

PART. NR.	DIMENSIONS (cm)				Material thickness (mm)
	A	B	C	D	
WBO-100	80	40	40	36	1,5
WBO-100N	80	40	40	36	1,5
WBO-250	80	50	60	55	2,0
WBO-150R	80	50	50		1,8

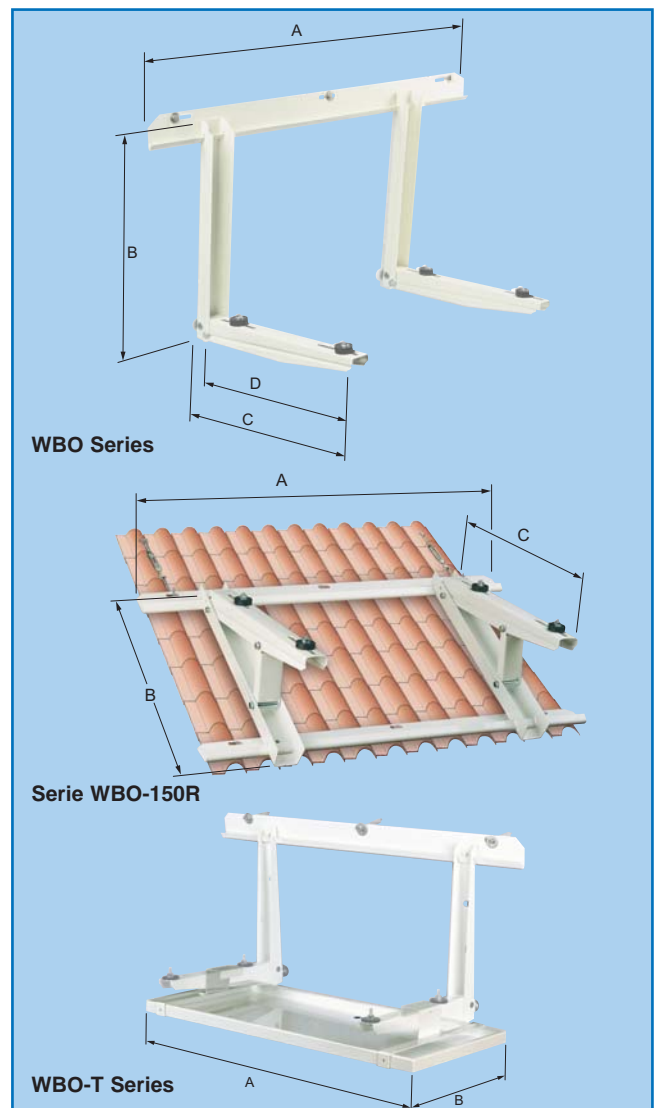

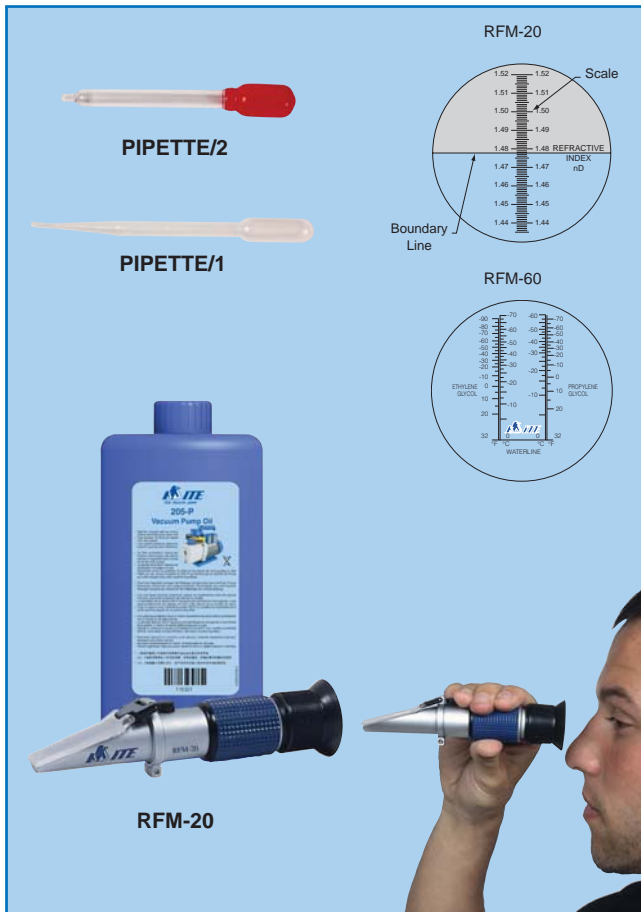

REFRACTOMETERS

RFM-20 HAND-REFRACTOMETER FOR OIL

FEATURES

- For measuring the refractive index of oils. Indirectly gives you an idea of the type of oil used in the system.
- Allows you to check for purity and identity by comparison with the refractive index given by oil supplier or by comparison with self tested refractive index, self tested on the original oil.
- Calibratable to ambient temperature
- With ATC (Automatic Temperature Compensation)
- Scale range: **nD 1.435 to 1.520** with a resolution of **nD 0.001**
- Accuracy: ± 0.001
- Size: **4 x 4 x 15 cm.**
- Weight: **237 gr.**
- Supplied with operating instructions, pipette and little screwdriver
- **Please check the refractive index of your oil with your supplier**

RFM-60 HAND-REFRACTOMETER FOR GLYCOL

FEATURES

- For measuring antifreeze and battery fluid.
- Calibratable to ambient temperature (using a few drops of distilled water).
- With ATC (Automatic Temperature Compensation)
- Scale range Ethylene glycol: -70°C to 0°C or -90°F to $+32^{\circ}\text{F}$
Propylene glycol: -60°C to 0°C or -70°F to $+32^{\circ}\text{F}$
- Resolution: $5^{\circ}\text{C}/5^{\circ}\text{F}$
- Accuracy: $\pm 5^{\circ}\text{C}/5^{\circ}\text{F}$
- Size: **4 x 4 x 15,5 cm**
- Weight: **255 gr**
- Supplied with operating instructions, pipette and little screwdriver

ACCESSORIES

- PIPETTE/1** Soft plastic pipette, 3 ml, with gradations of 0,5 ml
PIPETTE/2 Hard plastic pipette, 3 ml, without gradation



KIT "TOTALTEST"

TT1-001 Refrigerant **MOISTURE/ACID TESTER KIT** complete "TOTALTEST"

TT2-001 Replacement **TEST TUBES** (5 in a package)

WHY?

- "TOTALTEST" helps to detect a premature refrigeration or air conditioning system breakdown by: **Indicating when moisture levels may be considered harmful to a system.** The test tube is designed to change colour only when the moisture content in the system approaches a harmful level. **Indicating when there are strong acids which may corrode internal system and compressor parts,** the test tube is designed to change colour only to indicate the presence of harmful acids.

FEATURES "TOTALTEST"

- Works with **R12, R22, R500, R502** and **R11** vapor.
- The test can be performed with the system operating or shut off.
- Since the refrigerant is tested, there is no oil sample needed.
- The test can be done **within 10 minutes.**

HOW?

1. Break off tips of glass test tube and insert in the instrument as explained in the instruction sheet in the kit.
2. Attach the instrument to the system's suction side service access connection.
3. After TEN minutes, detach the instrument, remove the disposable glass test tube and compare it to the chart on the package. The test tube has **two chemical chambers. The smaller chamber** changes colour completely when the **moisture** level in the system becomes harmful. The more red the crystals, the more moisture is present. The **larger chamber** indicates the presence of corrosive **acid**. The chemical will change colour gradually from blue to yellow, beginning at the inner end and extending towards the outer end. The longer the yellow part, the more acid is present.

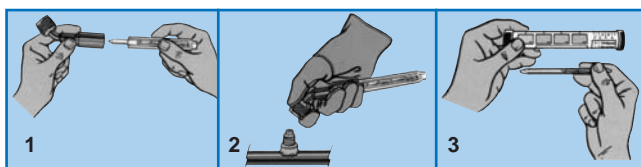

ACID TEST KITS

ATK-4

OIL ACID TEST KIT

For detecting the presence and formation of acid in air conditioning and refrigeration systems.

FEATURES

- Easy to use
- For all refrigeration oils
- 4 complete tests in each kit
- Simple to understand colour change indicators
- Accurate results in seconds
- Very inexpensive

Note: It has been proven in practice that some ester oils (since they are very hygroscopic) show acid already even if they are unused. If this is the case, we recommend the installation of an extra 3-function filter drier or to add a small quantity of acid neutralizer to the system (ACID-118, see page 193).



ATK-4

QWIKCHECK

5-SECOND ACID TEST FOR REFRIGERANT

FEATURES

- Results in 5 seconds
- Simple colour change
- Throw-away design
- Simple pass/fail acid test
- Verify quality of refrigerant
- Works for all refrigerants

USES

- Field test operating systems
- Test refrigerant stability
- Test recovered/recycled refrigerant

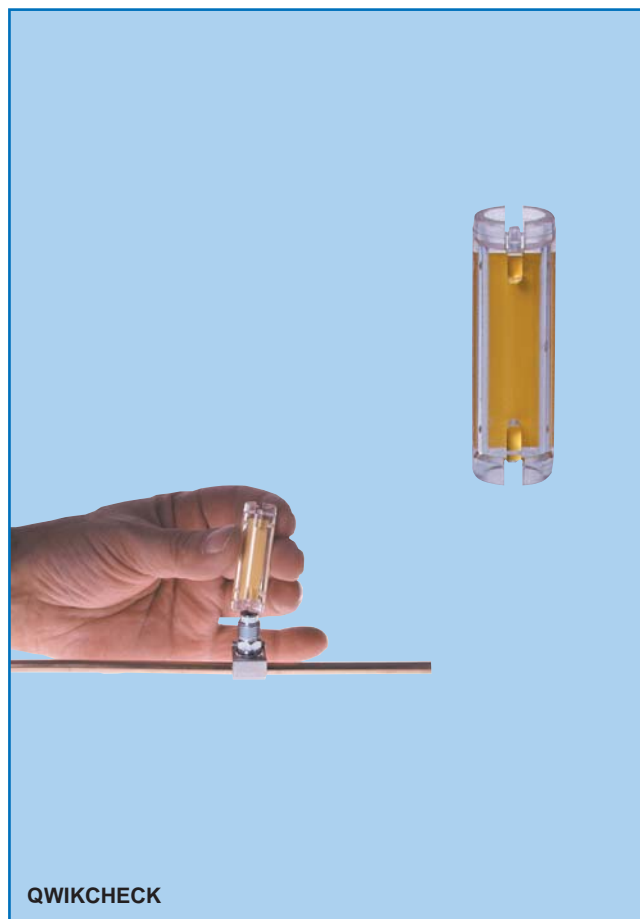

QWIKCHECK



KIT "CHECK-MATE"

RT-700K	CHECK-MATE contamination detector kit
RT-750A	Replacement ACID TEST TUBES
RT-751M	Replacement MOISTURE TEST TUBES
RT-752C	Replacement OIL TEST TUBES

FEATURES

- For the analysis of refrigerant gas.
- Quick, accurate test results.
- Detector tubes calibrated to ARI standards.
- The proper and correct method for checking refrigerant gas purity.
- Simple, ready to use.
- Separate acid and moisture analysis.
- Suitable also for **R134a**.

ACID TEST READINGS

Reaction: **BLUE = OK**
YELLOW = ACIDS
WHITE = DANGER

Sensitivity: **0,10 PPM**

Accuracy: **± 10%**

ARI recommend that the total acid contents in the system would be less than 1 PPM.

WARNING

Refrigerants treated with excess amounts of alcohol deshydrants will turn the indicator to pure white (no yellow).

MOISTURE ANALYSIS READINGS

Reaction: **CHOCOLATE** and **RED TENDENCY = MOISTURE**

Sensitivity: **1 PPM**

Accuracy: better than **10%**

ARI recommends and has established a liberal 10 PPM limit for re-usable refrigerant.

WARNING

Atmospheric moisture. Be sure to purge hose and body before use.

THE METERING DEVICE

The CHECKMATE BODY is a precision engineered in-line gas sampling device built to endure a lifetime of usage.

A short extension hose provides adequate clearance for connection to system or cylinder.

Blue inlet fitting containing a regulating needle-nozzle.

Recessed track providing in-line viewing of detector tube.



THE DETECTION TUBES

At the heart of the CHECKMATE system is the detection tube. Each tube is septum sealed and made of heavy wall Pyrex with fire embossed graduations. All materials are sterile analytic grade compounds packed under dry nitrogen gas.

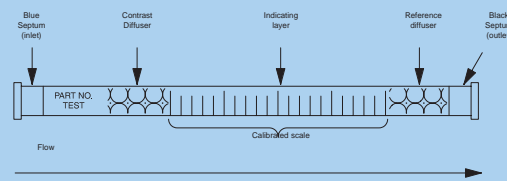

Termination pressure chart
 appr. 0.14 bar vapor phase

Type	BAR
R12	4.1
R22	6.8
R134a	2.0-acid 3.7-moisture
R500	4.4
R502	8.2
R11	0.14
R123	0.07

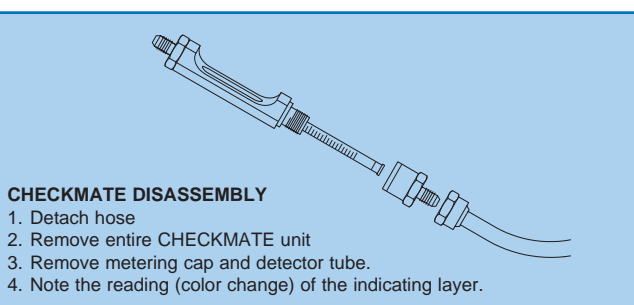
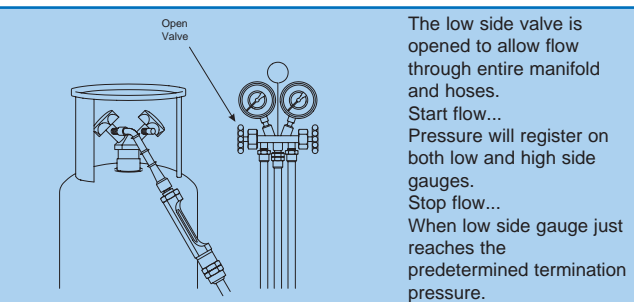

ACID AND REFRIGERATION NEUTRALISER

ACID-118 BOTTLE: 118 ml (4 oz)

- It chemically neutralizes and prevents acids in air conditioning and refrigeration systems.
- No solids or solid residuals.
- Compatible with all refrigerants and lubricants.
- Works fast, circulates quickly.
- Acid neutraliser will not harm system components, and can prevent system burnout. Ideal for preventive maintenance and repair the cure for acid problems.
- To allow you to charge this liquid into the system, use INJEC, see page 39.

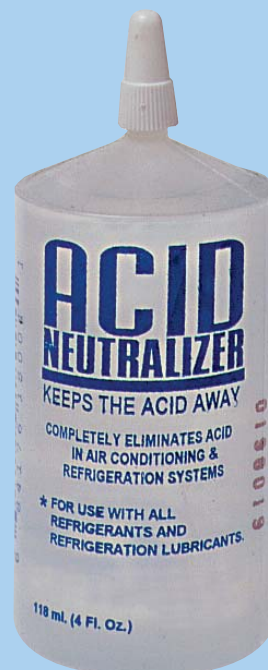

SILICA GEL

540

SILICA GEL $\text{SiO}_2 \cdot \text{H}_2\text{O}$ (8-20 mesh). It has a tremendous number of sub-microscopic pores, which attract water vapor, condens it, and hold it physically through surface absorption and capillary condensation.

NON-corrosive, NON-toxic. Contents: **680 gram**





"LOW TEMP" NON HAZARDOUS GAS LEAK DETECTOR

GLD-237
GLD-947
GLD-3790

PLASTIC DAUBER BOTTLE: 237 ml (8 oz)
TRIGGER SPRAYER BOTTLE: 947 ml (32 oz)
ONE GALLON BOTTLE: 3,78 Litre
(1 US gallon)

- Does not contain ethylene glycol. It is a non-freezing, viscous fluorescent, bubble-type gas leak detector rated to -34°C (-30°F). Leaks appear as large strong bubbles which cling to the applied surface and are fluorescent under a black light.
- For use on hot and cold piping and equipment containing most gases such as *AIR, NATURAL GAS*, all *CFC, HCFC, HFC* and their *OTHER BLENDS, AMMONIA, SO2*, etc.
- Temperature range: **-34°C** (-30°F) to **+73°C** (+200°F).



"TRAX" IN THE FIELD DETECTOR

TRAX-40
TRAX-300

SQUEEZE BOTTLE: 38 ml (1 1/3 oz)
PLASTIC SQUEEZE BOTTLE: 355 ml (12 oz)
with extendible spout

- "TRAX" is a clear, non-toxic, non residue, bubble type liquid leak detector formulated to produce long lasting bubbles under 'Job-Site' conditions.
- "TRAX" detects leaks as small as 1 micron, evaporates leaving no residue, requires no clean-up, does not pit surfaces and is environmentally safe. (meets military specifications: **MIL 25567 I ABC**).
- Temperature range: **-3°C** (27°F) to **+93°C** (+200°F).



"TRACE 2" DETECTOR

TRACE2-118
TRACE2-474
TRACE2-3790

PLASTIC BOTTLE: 118 ml (4 oz)
PLASTIC BOTTLE: 0,47 Litre (16 oz)
METAL CAN: 3,78 Litre (1 US gallon)

- It is a red dye, tracer type *INTERNAL LEAK DETECTOR* which pinpoints the exact leak location in refrigeration or hydraulic systems. "TRACE 2" is compatible and miscible with all *CFC, HCFC, HFC* and all their lubricants (*POE, PAO, PAG, AB* and *MO*) as well as hydraulic fluids.
- Even through ice and frost, leaks show an intense red stains which remain until removed.
- "TRACE 2" is non volatile and will not sludge or deposit gum. It is soluble in the lubricant and liquid refrigerants and travels with the lubricant. It is the easiest and least expensive way to locate leaks in an operating system.
- Temperature range: **-37°C** (-35°F) to **+204°C** (+400°F)
- Fluorescent with any ultraviolet light source.
- To allow you to charge this liquid into the system, use INJEC, see page 39.

UNIVERSAL A/C FLUORESCENT DYE

UVL-240

UNIVERSAL A/C FLUORESCENT DYE:
240 ml (8 oz)

- Can be used in any A/C unit.
- 240 ml / 8 oz. bottle (enough for use in approx. 32 systems).
- Permanently remains in the unit, so leaks can be located anytime for repair
- Works with any high intensity black light.
- Certified to meet SAE-J2297 for R134a and PAG oil lubricants.
- Bottle with graduated scale for correct dosage in automotive A/C systems. Use 7.5 ml (1/4oz.) for systems containing up to 1.8 kg (4 lbs.) of refrigerant or 0.5 L (16 oz.) of oil, or 7.5 ml for every 1.8 kg of refrigerant.
- Will not harm equipment, recovery systems, A/C systems or filters
- To allow you to charge this liquid into the system, use INJEC, see page 39.



SEALING MATERIAL

LEAK-40
LEAK-118
LEAK-474

LEAK-TEFLON-40

TUBE: 39 ml (1 1/3 oz)

BRUSH TOP PLASTIC JAR: 118 ml (4 oz)

BRUSH TOP PLASTIC JAR: 474 ml (16 oz)

TUBE: 39 ml (1 1/3 oz) with Teflon

- The very well known **"LEAK LOCK"** is a soft setting pipe joint compound for sealing threaded joints, flanged joints, gaskets and mating services. It is a resin based brushable paste which remains permanently flexible, adheres to internal surfaces and fills voids. It is excellent for use on metal and plastic materials which are subject to extreme vibrations, temperature range from **-73°C (-10°F)** to **+204°C (+400°F)** and from full vacuum up to **10.000 Psi**.
- **"LEAK LOCK"** seals a very wide range of products, natural and manufactured gases, steam, water and air, etc...
Use alcohol as a cleaning agent prior to applying.
- **"LEAK LOCK GOLD"** contains Teflon and has been designed for premium sealings in difficult circumstances.



L-41600

Thread Sealing Compound, SLIC-TITE stik
High-performance "PTFE" thread compound
in handy stik form
Contents: 35 gram

L-49050

Pipe thread sealant. Contains PTFE
Temp. range **-54°C to +204°C**
Pressure range **690 bar liquid to 206 bar gas**.
Contents: **50 ml**



L-41600



L-49050

EPOXY REPAIR KITS

EPOXY-GUM FAST ACTING, CERAMIC REPAIR PUTTY

APPLICATIONS

Epoxy gum moulds, to permanently patch dents, scratches, outs, gouges and holes in fibreglass, metal, and wooden boat decks and hulls; repair fittings, pipes, electrical connections, leaking gaskets, fuel tanks, water tanks, fish boxes, tubs, battery cases, skins, toilet basins, hot tubs, pools; and to form custom gaskets, etc. Aqua stick is ideal for making emergency in-water repairs. Unused aqua stick will remain stable for years if protected from direct contact with the air.



EPOXY-GUM

L-11575 HEAT-SEAL STICK Contents: 12 ml

- Stops leaks fast.
- Makes tough, cured, epoxy repairs in as little as 90 seconds.
- Melts and cures in one operation.
- Restores service immediately.
- Effective for all refrigeration systems.
- Withstands pressure to **31 bar** (450 Psi).
- Resists temperature to **+175°C.** (+350°F).
- Works on all metals, ceramics, even glass.
- Seals refrigeration systems using Freon, Ammonia, and SO₂.

DIRECTIONS

1. Clean area by scraping or filing. Do not use steel wool. Area must be free of surface oil.
2. Apply 2" vacuum (**50 mm Hg**) to prevent system oil from interfering with epoxy.
3. Warm area with light flame and keep touching stick to area until Stick just starts to melt. Do not put flame directly on HEAT-SEAL stick. Remove flame each time HEAT-SEAL is touched to heated area.
4. Spread thin coating approximately **0,8 mm** (¹/₃₂") over repair area using the end of stick. Add adjacent heat to area if necessary so that stick spreads easily.
5. After application, heat to cure repair area as follows:
 - A. Use Light brush flame and keep stroking flame directly on melted HEAT-SEAL repair for approximately one minute.
CAUTION: Keep flame moving so that it does not char heat seal.
 - B. When properly cured HEAT-SEAL stick has good adhesion and flexibility.
6. Repairs can be sanded and painted.

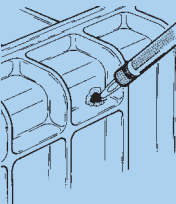
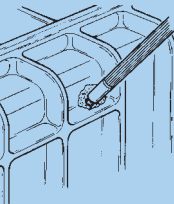
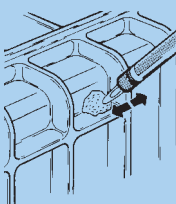

L-11575

		
<p>A. Heat area to approximately 120°C. Do not apply flame directly to HEAT-SEAL stick.</p>	<p>B. Touch stick to heated area and flow over leak. Build area to approximately 0,8 mm (¹/₃₂") thick and smooth</p>	<p>C. Cure HEAT-SEAL by brushing flame lightly and directly over repair for approximately one minute.</p>

SOLDER FLUX

SOLDER-118 BRUSH TOP PLASTIC JAR: 118 ml (4 oz)

- A high quality, paste type, non-acid *SOLDERING FLUX* with industrial strength wetting agents to promote solder flow.
- For use with all low and mid-temperature soft solders, both lead and lead-free, on all metals except aluminium & magnesium.
- Temperature range: **-45°C** (-50°F) to **+120°C** (+250°F).



L-36473

Aluminum flux paste and solder kit solders aluminum easily. **For repairing aluminum evaporators and tubing, ducts and gutters. Also solders aluminum to copper. Complete repair kit**

Contents: **28 gr** flux and **15 gr** solder 60



L-36473



L-11513

L-11509



HEAT BARRIERS

L-11513

COOL GEL HEAT BARRIER SPRAY

Contents: 0,473 litre

L-11509

COOL GEL HEAT BARRIER SPRAY

Contents: 0,947 litre

- Protects seals and seats in ball, dielectric and solenoid valves during soldering, brazing and welding operations
- No need for component disassembly, saving time and money
- Gel formula adheres to surface without dripping or running
- Non-staining formula which leaves no residue and eliminates cleanup
- Non-corrosive and non-toxic
- Safe, odorless and harmless to skin



BLOCK-ITE



BLOCK-ITE Heat protection up to 3000°C (5432°F)

DESCRIPTION

- Contents 1 kg.
- The BLOCK-ITE can be applied by hand on the area to be protected approx. 1 cm thick and 5 cm wide. You can be sure that sensitive materials in the welding area such as rubber plastic or glass will be protected. The heat flow as well as the suction heat inside the materials being worked on will be stopped.
- After initial use of the BLOCK-ITE, remove the white crust, the remainder is reusable, just mix it with water and BLOCK-ITE will be set back to its original condition.
- The tub should remain closed and the clay moist!

CLEANING PRODUCTS

CLIMEX 5 LITRE PLASTIC CAN (Concentrated)

FEATURES

- **CLIMEX** effectively foams away stubborn deposit from air-condensers, evaporators, other coils and surfaces.
- Emulsifying and expanding foam pushes contamination out.
- It is easily rinsed away with water.

USES AND INFORMATION

- **CLIMEX** removes oils, burnt-oils, greases and grease-bound dirt, smokes, etc... from any metallic, plastic or paint surfaces.
- **CLIMEX** is ideal for A/C & R coils, pipes and grills as well as machined parts, motor armatures, switches, breakers and is non harmful to most electrical insulation coverings.
- **CLIMEX is safe and suitable for the FOOD INDUSTRY.**
- Can be used totally **CONCENTRATED** as delivered or **DILUTED** up to **25%** into pure water and sprayed as a cleaning detergent foam fog (See our **SPRAYERS**).
Let **CLIMEX** penetrate small spaces, crevices and fin-coils to deep-clean and push all the contaminants out.
- Wait for **10 to 30 minutes**, then rinse with clear water.
- Wear gloves and glasses.

SPECIFICATIONS

- **LIQUID:** Blue, non acid, biodegradable, **ODOR:** sweet detergent
- **DENSITY:** 1.18, **PH:** 13.5 (± 0.35), **FLASH POINT:** No.



DETEX 5 LITRE PLASTIC CAN (Concentrated)

FEATURES

- **DETEX** effectively foams away stubborn deposit from air-condensers, evaporators, other coils and surfaces.
- It is also used for heavy machineries, walls, ground-floors or tanks and can be applied with cloth, brush to fixed surfaces.
Parts can be immersed into this solvent.
The use of our "ZENITH" or "ALIZE" **SPRAYERS** is ideal.
- Emulsifying and expanding foam pushes contamination out.
- It is easily rinsed away with water.

USES AND INFORMATION

- **DETEX** removes oils, burnt-oils, greases and grease-bound dirt, smokes, lints, insects, feathers, leaves etc... from any metallic, plastic or paint surfaces.
- **DETEX** is ideal for A/C & R coils, pipes and grills as well as machined parts, heavy machineries, walls, ground-floors or tanks, motor armatures, etc....
- **DETEX** is usually diluted into **+45°C (+115°F)** warm water
 - **LIGHT CLEANINGS:** Diluted by **5 to 6 gram/litre.**
 - **HEAVY CLEANINGS:** Diluted by **8 to 10 gram/litre.**
- **DETEX** stays efficient if diluted by **60 times** its volume of water.
- **DETEX** penetrates small spaces, crevices and fin-coils to deep-clean and push all the contaminants out.
- Wait for **10 to 30 minutes**, then rinse with clear water.
- Wear gloves and glasses.

SPECIFICATIONS

- **LIQUID:** Blue, non acid, biodegradable, **ODOR:** Citrus
- **DENSITY:** 1.02, **PH:** 7.0 (± 0.2), **FLASH POINT:** No.



BB-9 9 LITRE AUTOMATIC SPRAYER (Graduated)



BB-9



SUPER FLUSH

SUPER-3790 PLASTIC BOTTLE: 3,78 Litre (1 US gallon)
SUPER-947 PLASTIC BOTTLE: 947 ml (32 oz)

- Safely cleans and chemically stabilizes recovery, recycling and reclaim equipment.
- One treatment cleans and removes gum, soot, moisture, sludge, grease, tar, particulates, debris, organic acids, mineral acids, carbon deposits.
- Biodegradable, environmentally safe, non-flammable.
- Safe and easy to use. Will not harm system components.
- Does not contain halogenated solvents or hazardous ingredients.
- Safe and compatible with all refrigerants and refrigeration oils.
- Super cleaning agent for all A/C & refrigeration mechanical parts.
- Neutralizes and removes acid caused by compressor burnout.
- For short term exposure as during a flush, *SUPER FLUSH* has minimal or no effect on most elastomeric materials.



ICE MAX ICE MACHINE CLEANER

ICE-125 CONTAINER: 125 gr (4.4 oz)

- A high performance ice machine cleaner and powerful scale remover in powder form.
- Environmentally friendly, leaves no acidic residue, eliminating the risk of hazardous liquid spills.
- Nickel safe, fast acting, easy to use.
- It contains a high performance corrosion inhibitor. It has an extended shelf life and will not separate or chemically change over time. Nickel safe, fast acting, easy to use.
- Has maximum scale removing power and increases ice machine efficiency.

TAPES

DT-50	Industrial laminated cloth duct tape for all purposes. Water-resistant and tear-resistant. Meets UL 723, HUD and BOCA codes. Available in silver-grey. Temperature resistance: 93°C . 48 mm width x 50 m length
STT-796	THREAD SEALANT TEFLON TAPE May be used on most thread seal connections (metal or plastic) involving air, water, sewage, chemicals, hydraulic systems and overhead sprinkles systems. Three wraps ensures a leak-free joint. 1/2" (12,7 mm) width x 6,6 m length
STT-800	COPPER ANTI-SEIZE TEFLON TAPE A clean copper based, high-temperature, anti-seize material for protection from corrosion, seizure, galling, rust carbon fusion, galvanic pitting. The copper acts like ball bearings. This tape maintains its elasticity where temperatures reach as high as 1200°C . Applications: bolts, studs, threaded fittings and couplings, valve shafts, cylinder heads, manifolds and any other connection in a hostile environment. Do not use on oxygen systems. 1/2" (12,7 mm) width x 0,11 mm thickness x 3 m length
STT-891	STAINLESS STEEL PIPE THREAD SEALING TAPE Prevents stainless steel fittings from galling or seizing during assembly and disassembly. The tape is thicker and denser than most tapes, which also ensures an effective seal up to 800 bar (12,000 Psi). Do not use on oxygen systems. Will not harden or crack in the joint, No curing time, Effective within a broad range of temperatures, Non-toxic, Non-flammable, Unlimited shelf life. 1/2" (12,7 mm) width x 6,6 m length



ATF-30	INSULATION FOAM TAPE This insulation foam tape is a flexible thermal insulation which is fast and easy to install. It reduces heat loss and retards heat gain, condensation or frost. 50 mm width x 3 mm thickness x 9 m length
ATC-30	INSULATION CORK TAPE Prevents condensation strips, use on cold or hot pipes. 50 mm width x 3 mm thickness x 9 m length
AG-2	SEALING COMPOUND Seal. gum slugs - 0,9 kg . Non hardening, water resistant, versatile and odorless. This high quality compound has excellent adhesion and may be used to seal and caulk air conditioners, refrigeration cabinets and wherever a sealing or caulking compound is needed. Available in slugs or cords
AG-100	SEALING COMPOUND Seal. gum cords 4,7 mm width x 30 m length





D-1 (WS-33)

LUBRICANTS

D-1 (WS-33)

SPAY-LUBE all-purpose lubricant. Drives moisture out in seconds. Prevents rust, invisible film helps prevent new rust from forming. Penetrates, frozen parts are quickly loosened. Lubricates with high quality oil. Contents: **0,45 litre**.



SUNISO

A/C & REFRIGERANT OILS

SUNISO OILS

SUNISO-3,5GS-04

PLASTIC BOTTLE of 4 Litre

SUNISO-3GS-04

PLASTIC BOTTLE of 4 Litre

SUNISO-3GS-20

METAL CAN of 20 Litre

SUNISO-4GS-04

PLASTIC BOTTLE of 4 Litre

SUNISO-4GS-20

METAL CAN of 20 Litre

SUNISO-5G-04

PLASTIC BOTTLE of 4 Litre

300-CO1

PLASTIC BOTTLE of 1 Litre of SUNISO 3GS

- **SUNISO** GS oils are premium quality refrigeration compressor lubricants refined from specially selected naphthenic base crude oils.
- Designed for any installation, regardless of compressor or evaporator temperatures, charged with traditional refrigerants.
- They are highly stable, essentially wax free, thus providing excellent low temperature properties (even where evaporator temperatures are below -18°C) and assuring long trouble-free life.

SUNISO-SL32-04

PLASTIC BOTTLE of 4 litre

- **SUNISO** SL grades are synthetic ester lubricants, formulated using select polyolester base stocks and additives providing outstanding lubrication, stability and corrosion protection.
- Especially designed for use in refrigeration and air conditioning systems charged with new (alternative) refrigerants.
- These lubricants are miscible in alternative refrigerants such as R134a even at extremely low temperatures.

OTHER OILS

205-P06	600 ml PLASTIC BOTTLE MINERAL OIL
205-P1	SPECIAL MINERAL OIL (1 litre CAN) for vacuum pumps
205-P4	SPECIAL MINERAL OIL (4 litre CAN) for vacuum pumps
500-P1	SPECIAL ESTER OIL for vacuum pumps
300-CO1	MINERAL OIL (1 litre CAN) special for compressors of our "ITE" recovery stations
500-CO1	ESTER OIL (1 Litre CAN) special for compressors of our "ITE" recovery stations and other compressors



OILS "MANEUROP"

160-P2	WHITE MINERAL OIL (2 litre CAN)
160-P5	WHITE MINERAL OIL (5 litre CAN)



OILS "L'UNITE HERMETIQUE - TECUMSEH"

2444-RC	MINERAL OIL (2 litre CAN)
ZERICE	ALKYLBENZENE



SYNTHETIC OILS "ZEROL 150"

ZEROL-150-5L	ALKYLBENZENE (5 litre CAN)
--------------	----------------------------



Part. nr.	Pdf file
2001-VG	see Service manifolds, gauges and charging hoses
2001-VG	see Service manifolds, gauges and charging hoses
203-FA	see Tube working tools
2041-BT-2	see Fluid control components
2041-BT-2	see Fluid control components
2041-BT-2S2	see Fluid control components
2041-BT-2S2	see Fluid control components
2041-BT-3	see Fluid control components
2041-BT-3	see Fluid control components
2041-BT-3S3	see Fluid control components
2041-BT-3S3	see Fluid control components
2041-BT-4	see Fluid control components
2041-BT-4	see Fluid control components
2041-BT-4S4	see Fluid control components
2041-BT-4S4	see Fluid control components
2041-BT-4S5	see Fluid control components
2041-BT-4S5	see Fluid control components
2041-BT-5	see Fluid control components
2041-BT-5	see Fluid control components
2041-BT-5S5	see Fluid control components
2041-BT-5S5	see Fluid control components
2041-BT-5S6	see Fluid control components
2041-BT-5S6	see Fluid control components
2041-BT-5S6	see Fluid control components
2041-BT-5S7	see Fluid control components
2041-BT-5S7	see Fluid control components
205-P06	see Evacuating and charging equipment
205-P06	see Refrigeration accessories
205-P1	see Evacuating and charging equipment
205-P1	see Refrigeration accessories
205-P4	see Evacuating and charging equipment
205-P4	see Refrigeration accessories
206-FB	see Tube working tools
20-A	see Automatic access valves & fittings
21702-0	see Evacuating and charging equipment
21751	see Evacuating and charging equipment
227-FA	see Tube working tools
2444-RC	see Refrigeration accessories
25563	see Electronic measurement and control instruments
25860	see Refrigeration accessories
25863	see Refrigeration accessories
25869	see Refrigeration accessories
25870	see Refrigeration accessories
260-FHA	see Tube working tools
268	see Electronic measurement and control instruments
26880	see Tube working tools
26-C	see Automatic access valves & fittings
270-F-06	see Tube working tools
270-F-08	see Tube working tools
270-F-10	see Tube working tools
270-F-12	see Tube working tools
270-F-14	see Tube working tools
270-F-16	see Tube working tools
270-F-18	see Tube working tools
271-F	see Tube working tools
275-FS	see Tube working tools
275-FSC	see Tube working tools
275-FSM	see Tube working tools
27805	see Tube working tools
27806	see Tube working tools
27806M	see Tube working tools
27808	see Tube working tools
27808M	see Tube working tools
27810	see Tube working tools
27810M	see Tube working tools
27812	see Tube working tools
27812M	see Tube working tools
27814M	see Tube working tools
27816M	see Tube working tools
27818M	see Tube working tools
27820M	see Tube working tools
27-C	see Automatic access valves & fittings
2802-BC	see Service manifolds, gauges and charging hoses
2802-BC	see Service manifolds, gauges and charging hoses
2802-BC/247	see Service manifolds, gauges and charging hoses
2802-BC/27	see Service manifolds, gauges and charging hoses
2802-BC/4	see Service manifolds, gauges and charging hoses
2802-BC/447	see Service manifolds, gauges and charging hoses
2802-BPC	see Service manifolds, gauges and charging hoses
2802-BPC	see Service manifolds, gauges and charging hoses
2802-BPC/410	see Service manifolds, gauges and charging hoses
2802-BPC/410	see Service manifolds, gauges and charging hoses
2802-BPC/410/27	see Service manifolds, gauges and charging hoses
2802-BPC-1.0/410	see Service manifolds, gauges and charging hoses
2802-G-BC	see Service manifolds, gauges and charging hoses
2802-G-BC/247	see Service manifolds, gauges and charging hoses
2802-G-BC/4	see Service manifolds, gauges and charging hoses
2802-G-BC/447	see Service manifolds, gauges and charging hoses
2802-G-BPC	see Service manifolds, gauges and charging hoses
2804-BC	see Service manifolds, gauges and charging hoses
2804-BC/247	see Service manifolds, gauges and charging hoses
2804-BC/27	see Service manifolds, gauges and charging hoses
2804-BC/4	see Service manifolds, gauges and charging hoses
2804-BC/447	see Service manifolds, gauges and charging hoses
2804-BPC	see Service manifolds, gauges and charging hoses
2804-G-BC	see Service manifolds, gauges and charging hoses

[illegible]

[illegible]

[illegible]

[illegible]

[illegible]

[illegible]

- 7 -

Part. nr.	Pdf file
HC-2341-1	see Electronic measurement and control instruments
HC-2341-150	see Electronic measurement and control instruments
HC-234-150	see Electronic measurement and control instruments
HC-2341-50	see Electronic measurement and control instruments
HC-234-50	see Electronic measurement and control instruments
HCT-212	see Tube working tools
HCT-B	see Tube working tools
HCTK-239	see Electronic measurement and control instruments
HCT-P	see Tube working tools
HCT-S	see Tube working tools
HDA-120-B	see Service manifolds, gauges and charging hoses
HDA-120-R	see Service manifolds, gauges and charging hoses
HDA-120-Y	see Service manifolds, gauges and charging hoses
HDA-36-B	see Service manifolds, gauges and charging hoses
HDA-36-R	see Service manifolds, gauges and charging hoses
HDA-36-R/410	see Service manifolds, gauges and charging hoses
HDA-36-Y	see Service manifolds, gauges and charging hoses
HDA-36-Y/410	see Service manifolds, gauges and charging hoses
HDA-60-B	see Service manifolds, gauges and charging hoses
HDA-60-R	see Service manifolds, gauges and charging hoses
HDA-60-R/410	see Service manifolds, gauges and charging hoses
HDA-60-Y	see Service manifolds, gauges and charging hoses
HDA-60-Y/410	see Service manifolds, gauges and charging hoses
HDA-72-B	see Service manifolds, gauges and charging hoses
HDA-72-R	see Service manifolds, gauges and charging hoses
HDA-72-Y	see Service manifolds, gauges and charging hoses
HDCS-36-B/410/V	see Service manifolds, gauges and charging hoses
HDCS-36-R/410/V	see Service manifolds, gauges and charging hoses
HDS-120-B/V	see Service manifolds, gauges and charging hoses
HDS-120-R/V	see Service manifolds, gauges and charging hoses
HDS-120-Y/V	see Service manifolds, gauges and charging hoses
HDS-12-B/V	see Service manifolds, gauges and charging hoses
HDS-12-R	see Service manifolds, gauges and charging hoses
HDS-12-R/V	see Service manifolds, gauges and charging hoses
HDS-12-Y	see Service manifolds, gauges and charging hoses
HDS-12-Y/V	see Service manifolds, gauges and charging hoses
HDS-36-B/V	see Service manifolds, gauges and charging hoses
HDS-36-R/V	see Service manifolds, gauges and charging hoses
HDS-36-R/V	see Service manifolds, gauges and charging hoses
HDS-36-Y/V	see Service manifolds, gauges and charging hoses
HDS-60-B/V	see Service manifolds, gauges and charging hoses
HDS-60-R/V	see Service manifolds, gauges and charging hoses
HDS-60-Y/V	see Evaluating and charging equipment
HDS-60-Y/V	see Evaluating and charging equipment
HDS-60-Y/V	see Service manifolds, gauges and charging hoses
HD56-12-B/V	see Service manifolds, gauges and charging hoses
HD56-12-R/V	see Service manifolds, gauges and charging hoses
HD56-12-Y/V	see Service manifolds, gauges and charging hoses
HD56-36-B	see Service manifolds, gauges and charging hoses
HD56-36-B/V	see Service manifolds, gauges and charging hoses
HD56-36-R	see Service manifolds, gauges and charging hoses
HD56-36-R/V	see Service manifolds, gauges and charging hoses
HD56-36-Y	see Service manifolds, gauges and charging hoses
HD56-36-Y/V	see Service manifolds, gauges and charging hoses
HD56-60-B	see Service manifolds, gauges and charging hoses
HD56-60-B/V	see Service manifolds, gauges and charging hoses
HD56-60-R	see Service manifolds, gauges and charging hoses
HD56-60-R/V	see Service manifolds, gauges and charging hoses
HD56-60-Y	see Service manifolds, gauges and charging hoses
HD56-60-Y/V	see Service manifolds, gauges and charging hoses
HD56-72-B	see Service manifolds, gauges and charging hoses
HD56-72-B/V	see Service manifolds, gauges and charging hoses
HD56-72-R	see Service manifolds, gauges and charging hoses
HD56-72-R/V	see Service manifolds, gauges and charging hoses
HD56-72-Y	see Service manifolds, gauges and charging hoses
HD56-72-Y/V	see Service manifolds, gauges and charging hoses
HD56-72-B/V	see Service manifolds, gauges and charging hoses
HD5-72-B/V	see Service manifolds, gauges and charging hoses
HD5-72-R/V	see Service manifolds, gauges and charging hoses
HD5-72-Y/V	see Service manifolds, gauges and charging hoses
HER-319	see Fluid control components
HN54-04	see Forged brass & steel fittings "NPT" & "NPT 45" SAE"
HN54-06	see Forged brass & steel fittings "NPT" & "NPT 45" SAE"
HN54-08	see Forged brass & steel fittings "NPT" & "NPT 45" SAE"
HN54-10	see Forged brass & steel fittings "NPT" & "NPT 45" SAE"
HN54-12	see Forged brass & steel fittings "NPT" & "NPT 45" SAE"
HP-3700	see Fluid control components
HP-3701	see Fluid control components
HP-3702	see Fluid control components
HP-3703	see Fluid control components
HP-3704	see Fluid control components
HP-3706	see Fluid control components
HP-3738	see Fluid control components
HPBV-04P	see Fluid control components
HPBV-06MMP	see Fluid control components
HPBV-06P	see Fluid control components
HPBV-08P	see Fluid control components
HPBV-10MMP	see Fluid control components
HPBV-10P	see Fluid control components
HPBV-12MMP	see Fluid control components
HPBV-12P	see Fluid control components
HPBV-14P	see Fluid control components
HPBV-16MMP	see Fluid control components
HPBV-18P	see Fluid control components
HPBV-19MMP	see Fluid control components
HPBV-22MMP	see Fluid control components

Part. nr.	Pdf file
MF-1150C-048U	see Fluid control components
MF-1150C-230U	see Fluid control components
MF-1360C-110U	see Fluid control components
MF-1900C-024U	see Fluid control components
MF-4	see Evacuating and charging equipment
MF-4+LP-4	see Evacuating and charging equipment
MF-F-5-02	see Forged brass & steel fittings "NPT" & "NPT 45" SAE"
MF-F-5-03	see Forged brass & steel fittings "NPT" & "NPT 45" SAE"
MF-F-5-04	see Forged brass & steel fittings "NPT" & "NPT 45" SAE"
MF-F-5-06	see Forged brass & steel fittings "NPT" & "NPT 45" SAE"
MF-F-S-08	see Forged brass & steel fittings "NPT" & "NPT 45" SAE"
MF-F-S-10	see Forged brass & steel fittings "NPT" & "NPT 45" SAE"
MF-F-S-12	see Forged brass & steel fittings "NPT" & "NPT 45" SAE"
MF-F-S-16	see Forged brass & steel fittings "NPT" & "NPT 45" SAE"
MF-F-S-20	see Forged brass & steel fittings "NPT" & "NPT 45" SAE"
MF-F-S-24	see Forged brass & steel fittings "NPT" & "NPT 45" SAE"
MF-F-S-32	see Forged brass & steel fittings "NPT" & "NPT 45" SAE"
M-HDL-12-B	see Service manifolds, gauges and charging hoses
M-HDL-12-R	see Service manifolds, gauges and charging hoses
M-HDL-12-Y	see Service manifolds, gauges and charging hoses
M-HDL-6	see Evacuating and charging equipment
M-HDL-6-B	see Service manifolds, gauges and charging hoses
M-HDL-6-R	see Service manifolds, gauges and charging hoses
MI-CAP	see Fluid control components
MIR-1	see Service manifolds, gauges and charging hoses
MIR-1	see Tube working tools
MIR-1R	see Tube working tools
MIR-2	see Tube working tools
MIR-2	see Service manifolds, gauges and charging hoses
MIR-2R	see Tube working tools
MIR-3	see Tube working tools
MIR-3R	see Tube working tools
MIR-4	see Tube working tools
MIR-4R	see Tube working tools
MIR-5	see Tube working tools
MIR-5R	see Tube working tools
MK-040-DS	see Evacuating and charging equipment
MK-060-DS	see Evacuating and charging equipment
MK-120-DS	see Evacuating and charging equipment
MK-180-DS	see Evacuating and charging equipment
MK-240-DS	see Evacuating and charging equipment
MK-280-DS	see Evacuating and charging equipment
M-MM-02	see Forged brass & steel fittings "NPT" & "NPT 45" SAE"
M-MM-03	see Forged brass & steel fittings "NPT" & "NPT 45" SAE"
M-MM-04	see Forged brass & steel fittings "NPT" & "NPT 45" SAE"
M-MM-06	see Forged brass & steel fittings "NPT" & "NPT 45" SAE"
M-MM-08	see Forged brass & steel fittings "NPT" & "NPT 45" SAE"
M-MM-10	see Forged brass & steel fittings "NPT" & "NPT 45" SAE"
M-MM-12	see Forged brass & steel fittings "NPT" & "NPT 45" SAE"
M-MM-16	see Forged brass & steel fittings "NPT" & "NPT 45" SAE"
MMS-200	see Fluid control components
MMS-80	see Fluid control components
MP-02	see Refrigeration accessories
MP-02C	see Refrigeration accessories
MP-03	see Refrigeration accessories
MP-03C	see Refrigeration accessories
MP-04	see Refrigeration accessories
MP-04C	see Refrigeration accessories
MP-06	see Refrigeration accessories
MP-06C	see Refrigeration accessories
MP-08	see Refrigeration accessories
MP-08C	see Refrigeration accessories
MP-12	see Refrigeration accessories
MP-12C	see Refrigeration accessories
MP-18	see Refrigeration accessories
MP-18C	see Refrigeration accessories
MPF-M10	see Refrigeration accessories
MPF-M12	see Refrigeration accessories
MPF-M16	see Refrigeration accessories
MPR-M08	see Refrigeration accessories
MPR-M10	see Refrigeration accessories
MPR-M12	see Refrigeration accessories
MPR-M16	see Refrigeration accessories
MR-14-BH	see Service manifolds, gauges and charging hoses
MR-14-RH	see Service manifolds, gauges and charging hoses
MR-14-VK	see Service manifolds, gauges and charging hoses
MR-14-VS	see Service manifolds, gauges and charging hoses
MR-MM-032	see Forged brass & steel fittings "NPT" & "NPT 45" SAE"
MR-MM-042	see Forged brass & steel fittings "NPT" & "NPT 45" SAE"
MR-MM-043	see Forged brass & steel fittings "NPT" & "NPT 45" SAE"
MR-MM-064	see Forged brass & steel fittings "NPT" & "NPT 45" SAE"
MR-MM-082	see Forged brass & steel fittings "NPT" & "NPT 45" SAE"
MR-MM-084	see Forged brass & steel fittings "NPT" & "NPT 45" SAE"
MR-MM-086	see Forged brass & steel fittings "NPT" & "NPT 45" SAE"
MR-MM-106	see Forged brass & steel fittings "NPT" & "NPT 45" SAE"
MR-MM-108	see Forged brass & steel fittings "NPT" & "NPT 45" SAE"
MS-04	see Fluid control components
MS-06	see Fluid control components
MS-08	see Fluid control components
MS-10	see Fluid control components
MS-12	see Fluid control components
MS-14	see Fluid control components
MS-18	see Fluid control components
MS-22	see Fluid control components
MS-26	see Fluid control components

[illegible]

Part. nr.	Pdf file
SUNISO-4GS-20	see Refrigeration accessories
SUNISO-5G-04	see Refrigeration accessories
SUNISO-SL32-04	see Refrigeration accessories
SUPER-3790	see Refrigeration accessories
SUPER-947	see Refrigeration accessories
SV2W-38/110	see Evacuating and charging equipment
SV2W-38/220	see Evacuating and charging equipment
SV2W-38/627-VRP-110	see Evacuating and charging equipment
SV2W-38/627-VRP-220	see Evacuating and charging equipment
SWM-4D-41	see Tube working tools
T1-04A	see Forged brass & steel fittings "NPT" & "NPT 45" SAE
T1-04B	see Forged brass & steel fittings "NPT" & "NPT 45" SAE
T1-04C	see Forged brass & steel fittings "NPT" & "NPT 45" SAE
T1-06B	see Forged brass & steel fittings "NPT" & "NPT 45" SAE
T1-06C	see Forged brass & steel fittings "NPT" & "NPT 45" SAE
T1-08C	see Forged brass & steel fittings "NPT" & "NPT 45" SAE
T1-08D	see Forged brass & steel fittings "NPT" & "NPT 45" SAE
T1-10C	see Forged brass & steel fittings "NPT" & "NPT 45" SAE
T1-10D	see Forged brass & steel fittings "NPT" & "NPT 45" SAE
T2-04	see Forged brass & steel fittings "NPT" & "NPT 45" SAE
T2-05	see Forged brass & steel fittings "NPT" & "NPT 45" SAE
T2-06	see Forged brass & steel fittings "NPT" & "NPT 45" SAE
T2-08	see Forged brass & steel fittings "NPT" & "NPT 45" SAE
T2-10	see Forged brass & steel fittings "NPT" & "NPT 45" SAE
T2-12	see Forged brass & steel fittings "NPT" & "NPT 45" SAE
T3-04A	see Forged brass & steel fittings "NPT" & "NPT 45" SAE
T3-04B	see Forged brass & steel fittings "NPT" & "NPT 45" SAE
T3-06B	see Forged brass & steel fittings "NPT" & "NPT 45" SAE
T3-08D	see Forged brass & steel fittings "NPT" & "NPT 45" SAE
T3-10D	see Forged brass & steel fittings "NPT" & "NPT 45" SAE
T3-12E	see Forged brass & steel fittings "NPT" & "NPT 45" SAE
T3F-02	see Forged brass & steel fittings "NPT" & "NPT 45" SAE
T3F-03	see Forged brass & steel fittings "NPT" & "NPT 45" SAE
T3F-04	see Forged brass & steel fittings "NPT" & "NPT 45" SAE
T3F-06	see Forged brass & steel fittings "NPT" & "NPT 45" SAE
T3F-08	see Forged brass & steel fittings "NPT" & "NPT 45" SAE
T3F-10	see Forged brass & steel fittings "NPT" & "NPT 45" SAE
T3F-12	see Forged brass & steel fittings "NPT" & "NPT 45" SAE
T3F-16	see Forged brass & steel fittings "NPT" & "NPT 45" SAE
T3F-S-02	see Forged brass & steel fittings "NPT" & "NPT 45" SAE
T3F-S-03	see Forged brass & steel fittings "NPT" & "NPT 45" SAE
T3F-S-04	see Forged brass & steel fittings "NPT" & "NPT 45" SAE
T3F-S-06	see Forged brass & steel fittings "NPT" & "NPT 45" SAE
T3F-S-08	see Forged brass & steel fittings "NPT" & "NPT 45" SAE
T3F-S-10	see Forged brass & steel fittings "NPT" & "NPT 45" SAE
T3F-S-12	see Forged brass & steel fittings "NPT" & "NPT 45" SAE
T3F-S-16	see Forged brass & steel fittings "NPT" & "NPT 45" SAE
T3F-S-20	see Forged brass & steel fittings "NPT" & "NPT 45" SAE
T3F-S-24	see Forged brass & steel fittings "NPT" & "NPT 45" SAE
T6-4	see Forged brass & steel fittings "NPT" & "NPT 45" SAE
TAHL-5	see Electronic measurement and control instruments
TB-03	see Tube working tools
TB-06	see Tube working tools
TB-06	see Service manifolds, gauges and charging hoses
TB-16	see Tube working tools
TB-16	see Service manifolds, gauges and charging hoses
TB-364-04	see Tube working tools
TB-364-05/8mm	see Tube working tools
TB-364-05/8mm	see Tube working tools
TB-364-06	see Tube working tools
TB-364-06mm	see Tube working tools
TB-364-08	see Tube working tools
TB-364-10	see Tube working tools
TB-364-10mm	see Tube working tools
TB-364-12	see Tube working tools
TB-364-12/H	see Tube working tools
TB-364-12mm	see Tube working tools
TB-364-15mm	see Tube working tools
TB-364-16mm	see Tube working tools
TC-0316	see Tube working tools
TC-0316-H	see Tube working tools
TC-0328	see Tube working tools
TC-0328-H	see Tube working tools
TC-0432-ZR	see Tube working tools
TC-0432-ZRH	see Tube working tools
TC-0638-R	see Tube working tools
TC-0638-RH	see Tube working tools
TC-1000	see Tube working tools
TC-1000-SP	see Tube working tools
TC-10168-Z	see Tube working tools
TC-10168-ZC	see Tube working tools
TC-1020	see Tube working tools
TC-1050	see Tube working tools
TC-1050-SP	see Tube working tools
TC-127	see Service manifolds, gauges and charging hoses
TC-127	see Tube working tools
TC-2050	see Tube working tools
TC-206	see Tube working tools
TC-274	see Service manifolds, gauges and charging hoses
TC-274	see Service manifolds, gauges and charging hoses
TC-274	see Tube working tools
TC-274	see Service manifolds, gauges and charging hoses
TC-307	see Service manifolds, gauges and charging hoses
TC-307	see Tube working tools
TC-312	see Tube working tools

Part. nr.	Pdf file
TP19-010	see Copper tubes, coils & solder fittings (Inch & Metric)
TP19-012	see Copper tubes, coils & solder fittings (Inch & Metric)
TP19-015	see Copper tubes, coils & solder fittings (Inch & Metric)
TP19-018	see Copper tubes, coils & solder fittings (Inch & Metric)
TP19-022	see Copper tubes, coils & solder fittings (Inch & Metric)
TP19-028	see Copper tubes, coils & solder fittings (Inch & Metric)
TP19-030	see Copper tubes, coils & solder fittings (Inch & Metric)
TP19-035	see Copper tubes, coils & solder fittings (Inch & Metric)
TP19-042	see Copper tubes, coils & solder fittings (Inch & Metric)
TP19-048	see Copper tubes, coils & solder fittings (Inch & Metric)
TP19-054	see Copper tubes, coils & solder fittings (Inch & Metric)
TP19-060	see Copper tubes, coils & solder fittings (Inch & Metric)
TP19-064	see Copper tubes, coils & solder fittings (Inch & Metric)
TP19-070	see Copper tubes, coils & solder fittings (Inch & Metric)
TP19-076	see Copper tubes, coils & solder fittings (Inch & Metric)
TP19-080	see Copper tubes, coils & solder fittings (Inch & Metric)
TP19-089	see Copper tubes, coils & solder fittings (Inch & Metric)
TP19-102	see Copper tubes, coils & solder fittings (Inch & Metric)
TP19-108	see Copper tubes, coils & solder fittings (Inch & Metric)
TP19-114	see Copper tubes, coils & solder fittings (Inch & Metric)
TP19-125	see Copper tubes, coils & solder fittings (Inch & Metric)
TP19-133	see Copper tubes, coils & solder fittings (Inch & Metric)
TP19-140	see Copper tubes, coils & solder fittings (Inch & Metric)
TP19-160	see Copper tubes, coils & solder fittings (Inch & Metric)
TPM-1/V2	see Electronic measurement and control instruments
TPM-2/V2	see Electronic measurement and control instruments
TPM-58	see Electronic measurement and control instruments
TPM-62	see Electronic measurement and control instruments
TR2-00464	see Forged brass & steel fittings "NPT" & "NPT 45" SAE"
TR2-00664	see Forged brass & steel fittings "NPT" & "NPT 45" SAE"
TR2-00668	see Forged brass & steel fittings "NPT" & "NPT 45" SAE"
TR2-00886	see Forged brass & steel fittings "NPT" & "NPT 45" SAE"
TRACE2-118	see Refrigeration accessories
TRACE2-3790	see Refrigeration accessories
TRACE2-474	see Refrigeration accessories
TRAX-300	see Refrigeration accessories
TRAX-40	see Refrigeration accessories
TSPM-1/V2	see Electronic measurement and control instruments
TSPM-2/V2	see Electronic measurement and control instruments
TSPM-3	see Electronic measurement and control instruments
TS-RC	see Tube working tools
TS-SC	see Tube working tools
TSWM-10	see Electronic measurement and control instruments
TSWM-2/V2	see Electronic measurement and control instruments
TSWM-30	see Electronic measurement and control instruments
TSWM-35	see Electronic measurement and control instruments
TSWM-35/EXT	see Electronic measurement and control instruments
TT1-001	see Refrigeration accessories
TT2-001	see Refrigeration accessories
TU-041	see Copper tubes, coils & solder fittings (Inch & Metric)
TU-061	see Copper tubes, coils & solder fittings (Inch & Metric)
TU-081	see Copper tubes, coils & solder fittings (Inch & Metric)
TU-101	see Copper tubes, coils & solder fittings (Inch & Metric)
TU-121	see Copper tubes, coils & solder fittings (Inch & Metric)
TU-141	see Copper tubes, coils & solder fittings (Inch & Metric)
TU-161	see Copper tubes, coils & solder fittings (Inch & Metric)
TU-181	see Copper tubes, coils & solder fittings (Inch & Metric)
TU-221	see Copper tubes, coils & solder fittings (Inch & Metric)
TU-261	see Copper tubes, coils & solder fittings (Inch & Metric)
TU-341	see Copper tubes, coils & solder fittings (Inch & Metric)
TU-421	see Copper tubes, coils & solder fittings (Inch & Metric)
TU-501	see Copper tubes, coils & solder fittings (Inch & Metric)
TU-581	see Copper tubes, coils & solder fittings (Inch & Metric)
TU-661	see Copper tubes, coils & solder fittings (Inch & Metric)
TU-661	see Copper tubes, coils & solder fittings (Inch & Metric)
TWM-1/V2	see Electronic measurement and control instruments
TX-9	see Tube working tools
TX-9	see Service manifolds, gauges and charging hoses
U1-03A	see Forged brass & steel fittings "NPT" & "NPT 45" SAE"
U1-04A	see Forged brass & steel fittings "NPT" & "NPT 45" SAE"
U1-04B	see Forged brass & steel fittings "NPT" & "NPT 45" SAE"
U1-04C	see Evacuating and charging equipment
U1-04C	see Forged brass & steel fittings "NPT" & "NPT 45" SAE"
U1-04D	see Forged brass & steel fittings "NPT" & "NPT 45" SAE"
U1-04M14	see Evacuating and charging equipment
U1-04M14	see Service manifolds, gauges and charging hoses
U1-05A	see Forged brass & steel fittings "NPT" & "NPT 45" SAE"
U1-05B	see Forged brass & steel fittings "NPT" & "NPT 45" SAE"
U1-05C	see Forged brass & steel fittings "NPT" & "NPT 45" SAE"
U1-06A	see Forged brass & steel fittings "NPT" & "NPT 45" SAE"
U1-06B	see Forged brass & steel fittings "NPT" & "NPT 45" SAE"
U1-06C	see Evacuating and charging equipment
U1-06C	see Forged brass & steel fittings "NPT" & "NPT 45" SAE"
U1-06D	see Forged brass & steel fittings "NPT" & "NPT 45" SAE"
U1-06E	see Forged brass & steel fittings "NPT" & "NPT 45" SAE"
U1-06M14	see Evacuating and charging equipment
U1-06M14	see Service manifolds, gauges and charging hoses
U1-08A	see Forged brass & steel fittings "NPT" & "NPT 45" SAE"
U1-08B	see Forged brass & steel fittings "NPT" & "NPT 45" SAE"
U1-08C	see Forged brass & steel fittings "NPT" & "NPT 45" SAE"
U1-08D	see Forged brass & steel fittings "NPT" & "NPT 45" SAE"
U1-08E	see Forged brass & steel fittings "NPT" & "NPT 45" SAE"
U1-100-S03	see Fluid control components
U1-100-S05	see Fluid control components
U1-100-S06	see Fluid control components

- 15 -

Part. nr.	Pdf file
VASC-10 mm	see Fluid control components
VASC-11	see Fluid control components
VASC-12 mm	see Fluid control components
VASC-16 mm	see Fluid control components
VASC-18 mm	see Fluid control components
VASC-22 mm	see Fluid control components
VASC-28 mm	see Fluid control components
VASC-35 mm	see Fluid control components
VASC-42 mm	see Fluid control components
VASC-54 mm	see Fluid control components
VASC-82	see Fluid control components
VASC-83	see Fluid control components
VASC-84	see Fluid control components
VASC-85	see Fluid control components
VASC-86	see Fluid control components
VG-10	see Tube working tools
VG-12	see Tube working tools
VG-12ING	see Tube working tools
VG-14	see Tube working tools
VG-14G	see Tube working tools
VG-14I	see Tube working tools
VG-15	see Tube working tools
VG-16	see Tube working tools
VG-17	see Tube working tools
VG-18	see Tube working tools
VG-19	see Tube working tools
VN—05-13/1056/V2	see Refrigeration accessories
VN—10-20/1103/V2	see Refrigeration accessories
VNT—18-30/46/V2	see Refrigeration accessories
VNT—25-40/25/V2	see Refrigeration accessories
VNT—34-45/25/V2	see Refrigeration accessories
VOC-10	see Tube working tools
VOC-10	see Fluid control components
VOC-15	see Tube working tools
VOC-15	see Fluid control components
VOC-18	see Tube working tools
VOC-18	see Fluid control components
VPC-40	see Evacuating and charging equipment
VPP-40	see Evacuating and charging equipment
VT-400	see Evacuating and charging equipment
W3-V-80	see Service manifolds, gauges and charging hoses
WA-1000	see Tube working tools
WB-1	see Tube working tools
WBO-100	see Refrigeration accessories
WBO-100N	see Refrigeration accessories
WBO-120	see Refrigeration accessories
WBO-120N	see Refrigeration accessories
WBO-150R	see Refrigeration accessories
WBO-250	see Refrigeration accessories
WBO-K10	see Refrigeration accessories
WBO-K10N	see Refrigeration accessories
WBO-K12	see Refrigeration accessories
WBO-K12N	see Refrigeration accessories
WBO-K15	see Refrigeration accessories
WBO-K15R	see Refrigeration accessories
WBO-K25	see Refrigeration accessories
WCP-010/230V	see Refrigeration accessories
WCP-020/230V	see Refrigeration accessories
WDT-128-BODY	see Electronic measurement and control instruments
WDT-128C	see Electronic measurement and control instruments
WDT-128R	see Electronic measurement and control instruments
WKL-5	see Tube working tools
WM-80-B	see Service manifolds, gauges and charging hoses
WM-80-R	see Service manifolds, gauges and charging hoses
WPP-9	see Tube working tools
WS-005	see Electronic measurement and control instruments
WS-005-1L-1/4	see Electronic measurement and control instruments
WS-005-1L-5/16	see Electronic measurement and control instruments
WS-005-1L-7/16	see Electronic measurement and control instruments
WS-055	see Electronic measurement and control instruments
WS-150	see Electronic measurement and control instruments
WS-30	see Evacuating and charging equipment
WS-AC	see Electronic measurement and control instruments
WS-AC-EU	see Electronic measurement and control instruments
WS-AC-UK	see Electronic measurement and control instruments
WS-AC-USA	see Electronic measurement and control instruments
WS-ASV	see Electronic measurement and control instruments
WT-389	see Electronic measurement and control instruments
WT-389/P	see Electronic measurement and control instruments
XLD-6050	see Electronic measurement and control instruments
XPC-06M	see Tube working tools
XPC-07I	see Tube working tools
XPC-T	see Tube working tools
ZERICE	see Refrigeration accessories
ZEROL-150-5L	see Refrigeration accessories