

COPPER TUBES, COILS & SOLDER FITTINGS (Inch & Metric)



ite-tools.com



A/C & R TUBING COPPER COILS & COPPER STRAIGHT LENGTHS

DESCRIPTION

- ITE is a *MASTER EUROPEAN STOCKING* company for the main copper tubing manufacturers.
- Our *COPPER COILS & STRAIGHT LENGTHS* are specifically manufactured for the *REFRIGERATION* and *AIRCONDITIONING* industry and according to the norms and standards which are nationally and/or regionally required. (See *SPECIFICATIONS* below).
- These copper tubing are compatible with all **CFC**, **HCFC** and **HFC** and can be bent without heating. They are cleaned, purged and nitrogen pressurized as well as seal capped to be protected against the formation of harmful oxides.
- **ATTENTION:** It is important to check your needs according to your specific job and your country.

Note: According to the PED Directive 97/23/EC all open ended copper tubes and fittings as supplied by ITE will be classified in the SEP (Sound Engineering Practices) category by reference to article 3 paragraph 3 of the PED. A CE mark cannot be applied to these tubes and fittings, because all appropriate manufacturing operations such as bending, connection (soldering) and heat treatment have not been completed, as they will be completed in the field, during installation process, to render them fit for their intended purpose.





COILS

1. COPPER COILS (U.S. STANDARD)

ASTM B 280 and ANSI B9.1 (U.S. norms)
"STREAMLINE" (U.S. & Canadian patented)

PART NUMBER	DIAM.	LENGTH (ft)	WEIGHT (kg/m)	DIMENSIONS (mm x mm)	WALL (mm)
INCH ANNEALING COPPER COILS					
D02050	1/8"	50	0.052	1.68 x 3.21	0.76
D03050	3/16"	50	0.086	3.26 x 4.78	0.76
D04050	1/4"	50	0.120	4.83 x 6.35	0.76
D05050	5/16"	50	0.200	6.34 x 7.96	0.81
D06050	3/8"	50	0.268	7.91 x 9.53	0.81
D08050	1/2"	50	0.374	11.8 x 12.7	0.81
D10050	5/8"	50	0.454	14.1 x 15.9	0.89
D12050	3/4"	50	0.456	17.3 x 19.1	0.89
D14050	7/8"	50	0.677	19.9 x 22.2	1.14
D18050	1 1/8"	50	0.975	26.0 x 28.6	1.21
D22050	1 3/8"	50	1.315	32.1 x 34.9	1.40
D26050	1 5/8"	50	1.696	38.2 x 41.3	1.52

2. COPPER COILS (EUR. STANDARD)

Norm EN 12735-1
Tensile strength = soft R220

PART NUMBER	DIAM.	LENGTH (m)	WEIGHT (pc)	DIMENSIONS (mm x mm)	WALL (mm)
INCH ANNEALING COPPER COILS					
CO-04I	1/4"	15	2,00	4,75 x 6,35	0,8
CO-04I	1/4"	15	2,14	4,35 x 6,35	1
CO-05I	5/16"	15	2,99	6,34 x 7,94	0,8
CO-06I	3/8"	15	3,70	7,93 x 9,53	0,8
CO-06I	3/8"	15	3,36	7,53 x 9,53	1
CO-08I	1/2"	15	4,89	11,10 x 12,70	0,8
CO-08I	1/2"	15	4,62	10,70 x 12,70	1
CO-10I	5/8"	15	6,27	13,88 x 15,88	1
CO-12I	3/4"	15	7,49	17,05 x 19,05	1
CO-14I	7/8"	15	10,21	20,23 x 22,23	1
METRIC ANNEALING COPPER COILS					
MCO-06	6 mm	25	2,89	4,40 x 6	0,8
MCO-08	8 mm	25	4,00	6,40 x 8	0,8
MCO-10	10 mm	25	5,25	8,40 x 10	0,8
MCO-12	12 mm	25	7,49	10 x 12	1
MCO-15	15 mm	25	9,53	13 x 15	1
MCO-16	16 mm	25	10,35	14 x 16	1
MCO-18	18 mm	25	11,10	16 x 18	1
MCO-22	22 mm	25	14,93	20 x 22	1

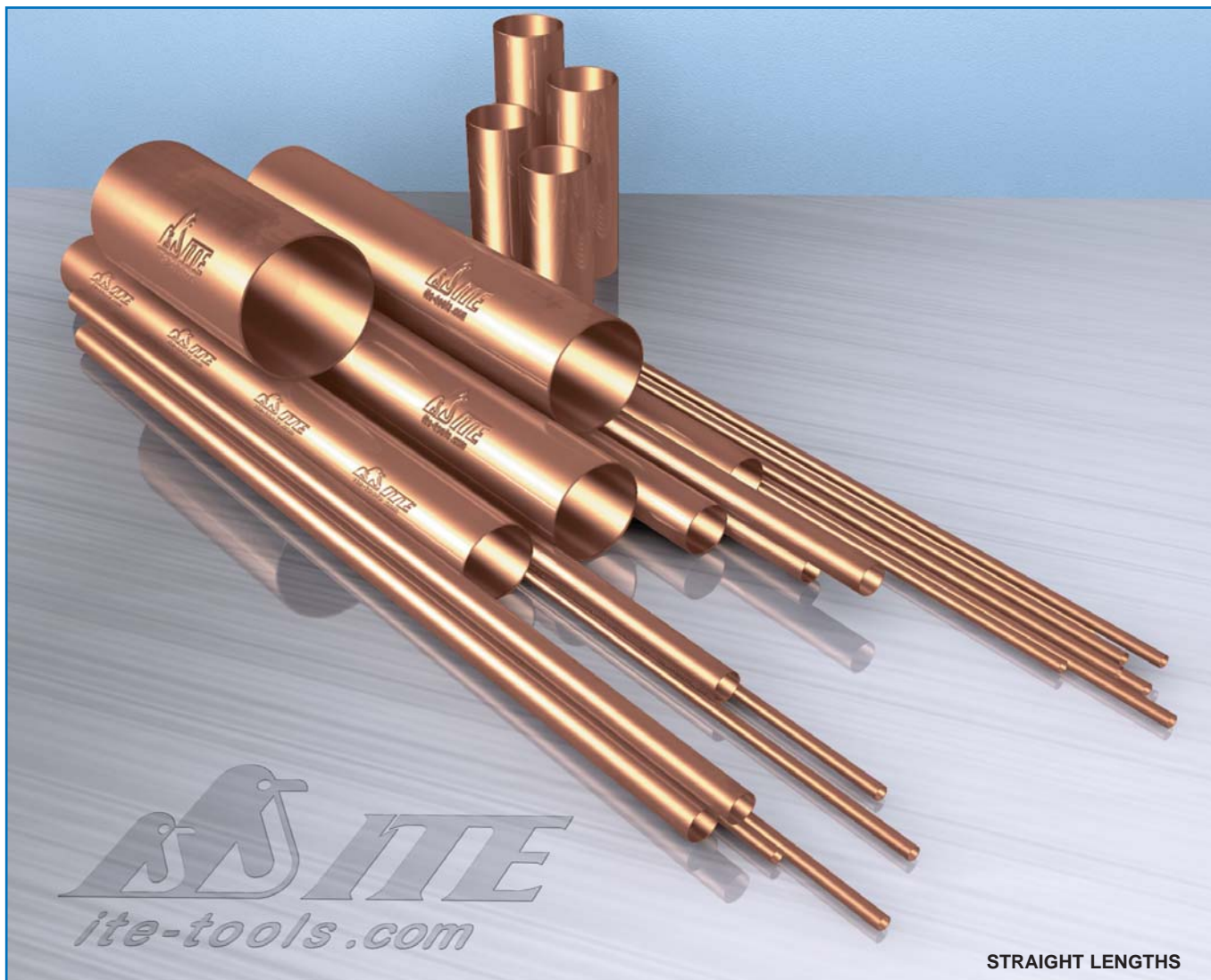

STRAIGHT LENGTHS

3. COPPER STRAIGHT LENGTHS (EUR. STANDARD)

Norm EN 12735-1
Tensile strength = half hard R250

PART NUMBER	DIAM.	LENGTH (m)	WEIGHT (pc)	DIMENSIONS (mm x mm)	WALL (mm)
INCH RIGID COPPER STRAIGHT LENGTHS					
TU-04I	1/4"	4	0,60	4,35 x 6,35	1
TU-06I	3/8"	4	0,96	7,53 x 9,53	1
TU-08I	1/2"	4	1,32	10,70 x 12,70	1
TU-10I	5/8"	4	1,65	13,88 x 15,88	1
TU-12I	3/4"	4	2,47	16,55 x 19,05	1,25
TU-14I	7/8"	4	2,54	19,73 x 22,23	1,25
TU-16I	1"	4	2,70	23,40 x 25,40	1
TU-18I	1 1/8"	4	3,10	26,58 x 28,58	1
TU-22I	1 3/8"	4	4,62	32,43 x 34,93	1,25
TU-26I	1 5/8"	4	5,57	38,78 x 41,28	1,25
TU-34I	2 1/8"	4	7,39	51,48 x 53,98	1,25
TU-42I	2 5/8"	4	12,08	63,38 x 66,68	1,65
TU-50I	3 1/8"	4	14,48	76,08 x 79,38	1,65
TU-58I	3 5/8"	4	16,70	88,78 x 92,08	1,65
TU-66I	4 1/8"	4	19,28	101,48 x 104,78	1,65
TU-66I	4 1/8"	4	26,00	99,78 x 104,78	2,50

PART NUMBER	DIAM.	LENGTH (m)	WEIGHT (pc)	DIMENSIONS (mm x mm)	WALL (mm)
METRIC RIGID COPPER STRAIGHT LENGTHS					
MTU-06	6 mm	4	0,39	4,40 x 6	0,8
MTU-08	8 mm	4	0,56	6,40 x 8	0,8
MTU-10	10 mm	4	0,75	8,40 x 10	0,8
MTU-12	12 mm	4	1,25	10 x 12	1
MTU-15	15 mm	4	1,55	13 x 15	1
MTU-16	16 mm	4	1,71	14 x 16	1
MTU-18	18 mm	4	1,91	16 x 18	1
MTU-22	22 mm	4	2,38	20 x 22	1
MTU-28	28 mm	4	4,42	25 x 28	1,5
MTU-35	35 mm	4	5,72	32 x 35	1,5

Other specifications upon request.

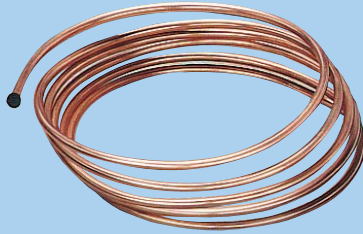

AVAILABLE ON STOCK
(See CAPILLARY TUBING GAUGE, Page 98)

A/C & R COPPER CAP. COILS

DESCRIPTION

- Fits ANY domestic and commercial refrigerator or room air conditioner from 1/8 H.P. to 5 H.P.
- Consolidated into a five-pack replacement kit. It's guaranteed to provide uniformity on all applications
- Commercial tolerance: ± 0.025 mm (0.001 of an inch)
- Precision plug drawn, sealed and dehydrated soft copper capillary tubing

PART NUMBER	DIMENSIONS (in mm) (internal) (external)	LENGTHS (metre)
CA-06/24-50	0.6 x 2.4	50
CA-06/30-50	0.6 x 3.0	50
CA-08/24-50	0.8 x 2.4	50
CA-10/30-50	1.0 x 3.0	50
CA-12/24-50	1.2 x 2.4	50
CA-15/30-50	1.5 x 3.0	50
CA-20/30-50	2.0 x 3.0	50
CA-20/40-50	2.0 x 4.0	50
CA-25/40-50	2.5 x 4.0	50
CA-30/40-50	3.0 x 4.0	50
CA-30/50-50	3.0 x 5.0	50

PART NUMBER	DIMENSIONS (in mm) (internal) (external)	LENGTHS (metre)
CA-07/20-03	0.787 (.031") x 2.057 (.081")	3
CA-10/23-036	1.016 (.040") x 2.362 (.093")	3,6
CA-13/23-036	1.321 (.052") x 2.362 (.093")	3,6
CA-16/31-036	1.626 (.064") x 3.175 (.125")	3,6
CA-07/18-03	0.711 (.028") x 1.803 (.071")	3
CA-13/23-30	1.321 (.052") x 2.362 (.093")	30
CA-5PAK	Five pack replacement kit	

BRAZING ALLOYS & SILVER SOLDER

DESCRIPTION

- These **BRAZING ALLOYS** are used for joining copper, especially for **REFRIGERATION** and **AIR-CONDITIONING**.
- May also be used for joining brass to copper with the use of **FLUX** (no flux is required when brazing copper to copper).
- **With 5% SILVER ALLOY**: Lower melting temperature than that of 0%. Addition of silver makes it more manageable.
- **With 15% SILVER ALLOY**: More silver and less phosphorus gives a low brazing temperature for better control with excellent fill capabilities. The most preferred because its versatility.
- **With 30% and 40% SILVER ALLOY**: Good strength and ductibility. Flows in a sluggish manner making it suitable for loose fittings. For general purpose brazing with a lower silver content making it the most economical cadmium alloys.
- **With 45 and 56% SILVER ALLOY**: Additional silver content gives this alloy a high degree of versatility and extreme thin flowing. Has a very high tensile strength and is especially suitable for joining dissimilar metals.

1. PLAIN SILVER ALLOY RODS (AUTO-FLUX BRAZING)

PART NUMBER	ROD Ø (mm)	WEIGHT (gram)	MELTING (°C RANGE)	SILVER (%)
1827 ^(°°)	2	200	260 / 270	2
800	2	500	710 / 820	2
806	2	500	645 / 780	5
1803	2	500	645 / 770	15
1802-A	1.5	200	608 / 615	45
1802-B	2	200	608 / 615	45
RB-4240	2	200	600 / 690	30

^(°°) BRAZING for ALU, STAINLESS STEEL,
COPPER to STAINLESS STEEL, etc...

1802-B



1802-A



2. COATED SILVER ALLOY RODS (CAPILLARY BRAZING)

PART NUMBER	ROD Ø (mm)	WEIGHT (gram)	MELTING (°C RANGE)	SILVER (%)
4240-MF(°)	2	200	605 / 690	30
1802-XFC (°)	2	200	595 / 630	40
1020-XFC (°)	2	200	620 / 660	56

(°) COATED RODS

(°°) COATED RODS & THIN CONTACT SPACE
No cadmium

SEE ALSO:

- "SOLDERLENE" PASTE FLUX, PAGE 197
- "HEAT SEAL STICK" SOLDER, PAGE 196
- "BLOCK- ITE" HEAT ABSORBER, PAGE 198

3. BRAZING SCOURING FLUXES

PART NUMBER	DESCRIPTION	WEIGHT (gram)	°C TEMP. (Range)
FLUX-800-D	Powder for 800 & 806	200	500 / 850
FLUX-1802-D	Powder for 1020, 1802 & 4240	200	500 / 780
FLUX-1802-PF	Soft paste	200	500 / 850

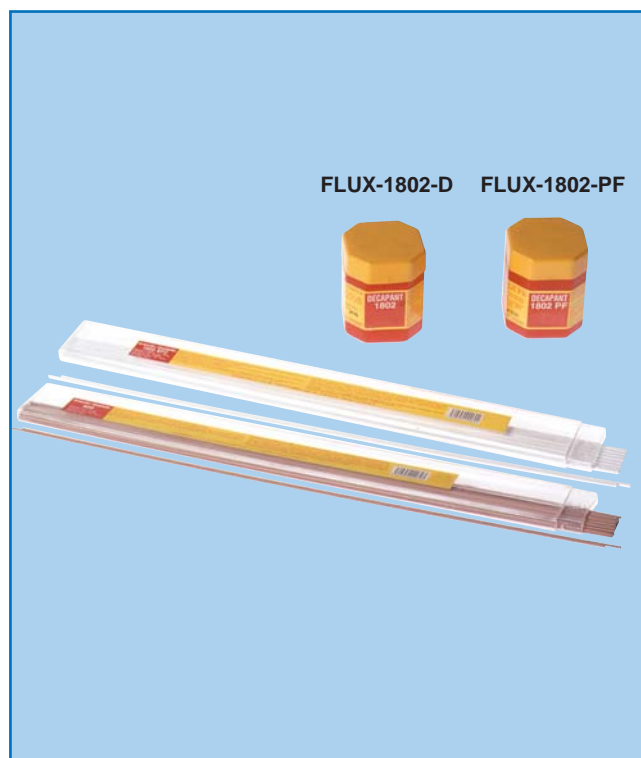

FASTENING AND FIXING SOLUTIONS

- These cushion clamp assemblies eliminate metal-to-metal contact when securing copper tubing in AIR-CONDITIONING, REFRIGERATION and WATER installations.
- These cushions resist most fuels, oils, gases, greases, solvents, minerals, acids, etc...
- Simplified installation: Only 1 man and 1 tool needed for assembly.

1. RAPID LIGHTWEIGHT CUSHION CLAMPS

- Steel sheet with M8, M10 nuts
- Width: 20 mm, thickness: 1,2 mm
- Bolt: OD 5 mm, length 25 mm
- Hex Nut: Hex 15 mm, length 15 mm M8/M10
- Temperature range : -50°C to + 110°C

UNLINED

PART. NR.	SIZE	RANGE	PART. NR.	SIZE	RANGE
FSCC-0507	1/4"	05-07 mm	FSCC-4244	15/8"	42-44 mm
FSCC-0710	3/8"	07-10 mm	FSCC-5255	21/8"	52-55 mm
FSCC-1113	1/2"	11-13 mm	FSCC-5864	23/8"	58-64 mm
FSCC-1315	5/8"	13-15 mm	FSCC-6571	25/8"	65-71 mm
FSCC-1619	3/4"	16-19 mm	FSCC-7280	31/8"	72-80 mm
FSCC-2022	7/8"	20-22 mm	FSCC-8892	35/8"	88-92 mm
FSCC-2528	11/8"	25-28 mm	FSCC-98107	41/8"	98-107 mm
FSCC-3335	13/8"	33-35 mm			

RUBBERLINED

PART. NR.	SIZE	RANGE	PART. NR.	SIZE	RANGE
FSCC-0507-R	1/4"	05-07 mm	FSCC-4244-R	15/8"	42-44 mm
FSCC-0710-R	3/8"	07-10 mm	FSCC-5255-R	21/8"	52-55 mm
FSCC-1113-R	1/2"	11-13 mm	FSCC-5864-R	23/8"	58-64 mm
FSCC-1315-R	5/8"	13-15 mm	FSCC-6571-R	25/8"	65-71 mm
FSCC-1619-R	3/4"	16-19 mm	FSCC-7280-R	31/8"	72-80 mm
FSCC-2022-R	7/8"	20-22 mm	FSCC-8892-R	35/8"	88-92 mm
FSCC-2528-R	11/8"	25-28 mm	FSCC-98107-R	41/8"	98-107 mm
FSCC-3335-R	13/8"	33-35 mm			





FSCO-3550

FSNK-30M8



FSN-M8



FSTR-1M6



FSBC-M8

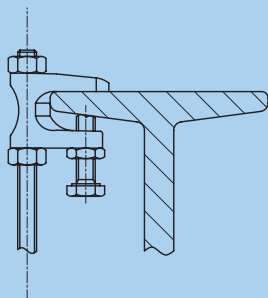

2. CONSOLES

- For wall mounting

FSCO-3550	CONSOLE CA, 35 x 35 mm, length: 500 mm
FSCO-3575	CONSOLE CA, 35 x 35 mm, length: 750 mm

3. PROFILES

- Electrozinc plating

FSP2-3419	PROFILE CK, 34 x 19 mm, length: 2 m
FSP3-3535	PROFILE C3, 35 x 35 mm, length: 3 m

END CAPS

FSEC-3419	END CAP for profile 34 x 19
FSEC-3535	END CAP for profile 35 x 35

4. PROFILE NUT KIT

- Bolt, washer and nut

FSNK-30M8	PROFILE NUT KIT M8 x 30
FSNK-30M10	PROFILE NUT KIT M10 x 30

PROFILE NUT

FSN-M8	PROFILE NUT M8
FSN-M10	PROFILE NUT M10

5. THREADED RODS

- Electrozinc

FSTR-1M6	THREADED ROD, M6 x 100, length:1 m
FSTR-1M8	THREADED ROD, M8 x 125, length:1 m

6. BEAM CLAMPS

- Electrozinc plated

FSBC-M6	BEAM CLAMP M6
FSBC-M8	BEAM CLAMP M8

INSULATED COPPER TUBE

FEATURES

- The optimal solution for conditioning systems, for the transportation of refrigerant gases, for multi-purpose machines (hot/cold) based on heat pumps and for uses where there is the need for insulating material with high energy values.
- As regards cold insulation, one of the negative factors is the formation of condensation both on the surface of the insulating material and within.
Since water is an excellent heat conductor, good insulation material must be capable of ensuring that no flow of steam is created inside. The greater its resistance to steam (m) the longer the insulation will last over time.
- The insulating material, which is guaranteed as being environment-friendly, is made of extruded expanded polyethylene with a certified permeability factor m 11,000 and an exceptionally resistant external protective film.
- The lower the coefficient of heat conductivity λ of the insulating material, the higher the resistance to transmission of heat, offering a better "insulating" performance.
- Sealed at the ends at a pressure equal to 70 tonnes, which guarantees the perfect internal cleanliness of the copper tube and the complete absence of humidity. This procedure favours the anti-oxidizing effect brought about by the presence of inert gases, nitrogen, present during the annealing phase.
- For double tubes, the 2 pipes can be manually separated without the use of special tools. This speeds up installation, guaranteeing perfect integrity of the insulation material.

SPECIFICATIONS

- Working temperature: from -45°C to $+95^{\circ}\text{C}$
- Coefficient of heat conductivity λ ISO 8497 - ASTM C 335:
Mean temp: 0°C $\text{W/(m}^2\text{K)}$: 0.036 kcal/h : 0.0309
 40°C 0.040 0.0344
- Permeability: $\mu \geq 11,000$
- Class 1 fire rating certificate CSE RF 2/75/A
- CSI (CSE RF 3/77)
- Density: 30 kg/m^3
- Neutral odour
- Optimal resistance to chemical agents, fungi and parasites
- No toxicity in case of fire
- Insulating material produced without the use of CFC's
- Noise reduction $>30 \text{ dB}$ of the noise due to the flow or to the contact with metal pipes
- Type of copper: CU-DHP 99.9 UNI 5649-71 ASTM B 280 - tolerances as per UNI 7773

SINGLE TUBE INSULATED

PART NUMBER	Copper pipe ext. dia		Insulating thickness (mm)	Covered pipe ext. dia (mm)	Weight of naked tube (kg/m)	Max. Working pressure (kg/cm ²)	Water flow per meter of tube (V lt/m)	Coil length (m)
	inch	mm						
IPS-04	1/4"	6,35 x 0,76	6	18	0,120	158	0,016	25
IPS-05	5/16"	7,93 x 0,81	9	26	0,162	117	0,029	25
IPS-06	3/8"	9,52 x 0,81	9	28	0,199	93	0,046	25
IPS-08	1/2"	12,70 x 0,81	9	31	0,271	66	0,093	25
IPS-10	5/8"	15,88 x 0,89	9	34	0,373	51	0,155	25
IPS-12	3/4"	19,05 x 1,00	13	46	0,539	41	0,233	25
IPS-14	7/8"	22,22 x 1,10	13	49	0,677	35	0,327	25

DOUBLE TUBE INSULATED

PART NUMBER	Copper pipe ext. dia		Insulating thickness (mm)	Covered pipe ext. dia (mm)	Weight of naked tube (kg/m)	Max. working pressure (kg/cm ²)	Water flow per meter of tube (V lt/m)	Coil length (m)
	inch	mm						
IPD-0406	1/4" x 3/8"	6,35 x 9,52	6 - 9	18 - 28	0,120 - 0,199	158 - 93	0,016 - 0,046	20
IPD-0408	1/4" x 1/2"	6,35 x 12,70	6 - 9	18 - 31	0,120 - 0,271	158 - 66	0,016 - 0,093	20
IPD-0410	1/4" x 5/8"	6,35 x 15,88	6 - 9	18 - 34	0,120 - 0,373	158 - 51	0,016 - 0,155	20
IPD-0608	3/8" x 1/2"	9,52 x 12,70	9 - 9	28 - 31	0,199 - 0,271	93 - 66	0,046 - 0,093	20
IPD-0610	3/8" x 5/8"	9,52 x 15,88	9 - 9	28 - 34	0,199 - 0,373	93 - 51	0,046 - 0,155	20
IPD-0612	3/8" x 3/4"	9,52 x 19,05	9 - 13	28 - 46	0,199 - 0,539	93 - 41	0,046 - 0,233	20
IPD-0812	1/2" x 3/4"	12,70 x 19,05	9 - 13	31 - 46	0,271 - 0,539	66 - 41	0,093 - 0,233	20

*kg/cm² x 0,981 = bar





THERMAL PIPE INSULATION CLASS 1

"μ 5000 PRODUCT WITHOUT CFC"

1. INSULATION SLEEVES

DESCRIPTION

- Recommended for use where "thermal bridging" should be avoided. This is particularly important in refrigeration and chilled water installation where there is a possibility of condensation taking place.
- Odourless, does not alter taste of food.
- Does not contain components with asbestos, CFC free.
- Very good ageing resistance, non perishable.

SPECIFICATIONS

- Maximum temperature: **+105°C** (+85°C for flat surface)
- Minimum temperature: **-40°C**.
- Thermal conductivity: $\hat{\gamma}_m$: **± 0, λ: 0,038**.
- Water vapour permeability resistance factor: **μ5000**.
- Coefficient of water vapour diffusion at 0°C under normal conditions of pressure: **0,13 x 10⁻⁹ kg / (m x h x Pa)**
1,7 x 10⁻⁵ kg / (m x h x mm Hg)
- Noise reduction: to **30 db**.

For EXT. Ø COPPER TUBING		For EXT. Ø STEEL TUBING			THICKNESS: 9 mm		THICKNESS: 13 mm		THICKNESS: 20 mm		THICKNESS: 32 mm	
mm	inch	mm	inch	nom	PART N° x inter Ø	BOX (m)	PART N° x inter Ø	BOX (m)	PART N° x inter Ø	BOX (m)	PART N° x inter Ø	BOX (m)
6	1/4"				TPI9-006	352	TPI13-006					
8	5/16"				TPI9-008	300	TPI13-008					
10	3/8"	10.2	1/8"	6	TPI9-010	266	TPI13-010	222				
12	1/2"				TPI9-012	234	TPI13-012	210				
14 - 15	5/8"	13.5	1/4"		TPI9-015	192	TPI13-015	172	TPI20-015	78		
								162				
								136				
18	3/4"	17.2	3/8"	10	TPI9-018	166	TPI13-018		TPI20-018	72	TPI32-018	50
22	7/8"	21.3	1/2"	15	TPI9-022	136	TPI13-022	118	TPI20-022	64	TPI32-022	42
								98				
28	1 1/8"	26.9	3/4"	20	TPI9-028	98	TPI13-028		TPI20-028	48	TPI32-028	40
30	1 3/16"	30.0			TPI9-030	92		78				
35	1 3/8"	33.7	1"	25	TPI9-035	76	TPI13-035		TPI20-035	36	TPI32-035	24
42	1 5/8"	42.4	1 1/4"	32	TPI9-042	60	TPI13-042	58	TPI20-042	32	TPI32-042	22
48 - 50	1 7/8"	48.3	1 1/2"	40	TPI9-048	40	TPI13-048	48	TPI20-048	24	TPI32-048	18
								40				
54	2 1/8"	54.0			TPI9-054	46	TPI13-054		TPI20-054	24	TPI32-054	16
60	2 3/8"	60.3	2"	50	TPI9-060	36	TPI13-060	34	TPI20-060	18	TPI32-060	12
64	2 1/2"	63.5			TPI9-064	34	TPI13-064	32	TPI20-064	18	TPI32-064	12
70	2 3/4"	70.0			TPI9-070	32	TPI13-070	30	TPI20-070	14	TPI32-070	12
76	3"	76.1	2 1/2"	65	TPI9-076	26	TPI13-076	24	TPI20-076	12	TPI32-076	10
80	3 1/8"				TPI9-080	24		22				
89	3 1/2"	88.9	3"	80	TPI9-089	20	TPI13-089		TPI20-089	12	TPI32-089	8
102	4"	101.6	3 1/2"		TPI9-102	16	TPI13-102	18	TPI20-102	8		
108	4 1/4"	108.0			TPI9-108	16	TPI13-108	12	TPI20-108	8		
114	4 1/2"	114.3	4"	100	TPI9-114	14	TPI13-114	12	TPI20-114	8	TPI32-114	6
125	5"	125.0			TPI9-125	12	TPI13-125	10	TPI20-125	8		
133		133.0			TPI9-133	10		8				
139	5 1/2"	139.7	5"	125	TPI9-140	10	TPI13-140	8	TPI20-140	6	TPI32-140	4
159		160.0			TPI9-160	6	TPI13-160	6	TPI20-160	4		

NOTE:

- 1 inch = 25,4 mm
- THICKNESS: TPI9 = 3/8" or 9 mm, TPI13 = 1/2" or 13 mm, TPI20 = 3/4" or 20 mm, TPI32 = 1 1/4" or 32 mm
- UNIT LENGTH FOR EACH SLEEVE: 2 m (2 m = 78.75 inch)
- FOR ORDERING: Mention the **PART N°** and **LENGTH** needed (ex.: TPI20-28 / 32m). (use the "m" box packing mentioned in the above table)

2. ACCESSORIES

SELF ADHESIVE INSULATING TAPE (M1)

PART NUMBER	LENGTH		WIDTH		THICKNESS	
	(m)	(ft)	(mm)	(inch)	(mm)	(inch)
INSUL TAPE	15	49.2	50	2"	3	1/8"

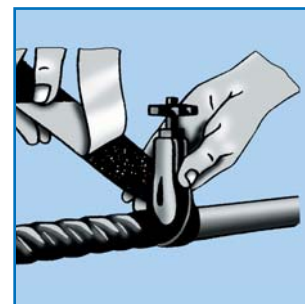

ADHESIVE FOR INSULATING MATERIALS

GL-050	CAN of 0.5 litre	(0.132 gallon)
GL-250	CAN of 2.50 litre	(0.660 gallon)

- Neoprene rubber and synthetic resin. Density: **0.85**
- Flash point: **+4°C** (+39°F). Stocking time: 1 year approx.
- Minimum temperature for adhesion: **+5°C** (+41°F)
- Gluing made with 1 litre (0.26 US gallon):
 - For 9 mm sleeves: **180** to **210 m** (590/690 ft)
 - For 13 mm sleeves: **130** to **150 m** (426/490 ft)
 - For 20 mm sleeves: **80** to **110 m** (260/360 ft)
 - For 32 mm sleeves: **50** to **60 m** (160/190 ft)
 - For all sheets: **4** to **5 m²** (43/53 sq.ft.)
- Drying delay: 30 minutes for touching, 12 hours definitive.

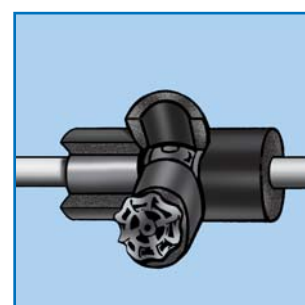

GS-100	GLUE SOLVENT	1 Litre (0.264 gallon)
---------------	---------------------	------------------------

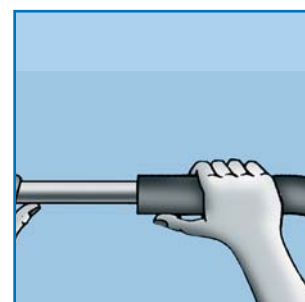

SPECIAL PAINT FOR INSULATING MATERIALS

PAINT	WHITE PAINT CAN	1 kg (2,2 lbs)
--------------	------------------------	----------------

- To be used on outside insulating materials. Use 2 coats
- Covering per coat: **5 to 6 m²** for **1 kg** (54 to 64 sq.ft. for 2.2 lbs)
- Working recommended temperature: **+10 to +30°C** (50 to 85°F)

GS-100	GLUE SOLVENT for PAINT	1 litre (0.264 gallon)
---------------	-------------------------------	------------------------

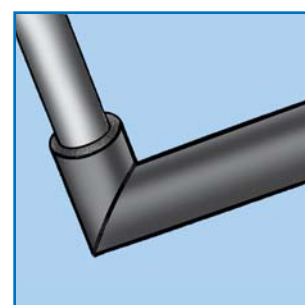

INCH COPPER TUBE FITTINGS

"A/C & R SOLDER JOINT HIGH PRESSURE INCH FITTINGS"

SYMBOLS USED FOR FITTING ENDS

- "C" : Copper cup manufactured to receive copper tube diameter (as an ODS solder connection).
The copper tube can be "slipped-in" any "C" fitting end.
- "FTG" : Fitting ends made to copper tube diameter. Can be "slipped-in" any "C" fitting end.
- "FPT" : Female National Pipe Thread (NPT) said **FPT**. ("N" had been dropped and replaced by "F" for female).
- "MPT" : Male National Pipe Thread (NPT) said **MPT**. ("N" had been dropped and replaced by "M" for male).

NOTE

- All solder cups (**C**) and fitting ends (**FTG**) size descriptions are expressed in outside diameter (**OD**) tube size.

- All National Pipe Threads (**NPT**) are expressed in standard female NPT (**FPT**) and male NPT (**MPT**).

Note: According to the PED Directive 97/23/EC all open ended copper tubes and fittings as supplied by ITE will be classified in the SEP (Sound Engineering Practices) category by reference to article 3 paragraph 3 of the PED. A CE mark cannot be applied to these tubes and fittings, because all appropriate manufacturing operations such as bending, connection (soldering) and heat treatment have not been completed, as they will be completed in the field, during installation process, to render them fit for their intended purpose.

NORMS

- Real A/C & R COPPER FITTINGS
- Strictly conform to latest **ASME / ANSI B 16.22**

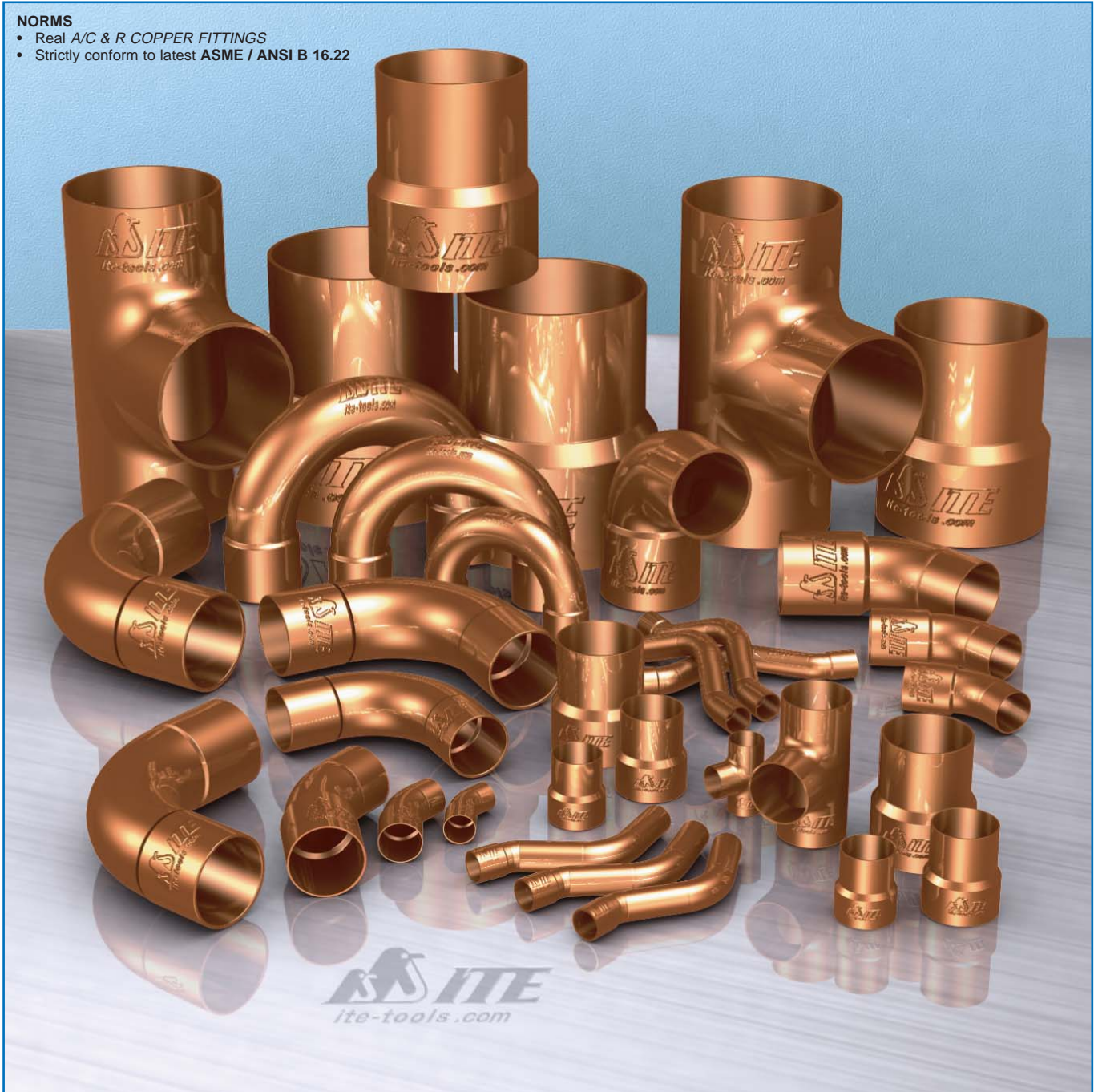

DIMENSIONS

- Dimensions of products illustrated are for general estimating purposes and based on the latest data.
- Dimensions are subject to revision without immediate notice (codes, manufacturing, market demand, etc...)

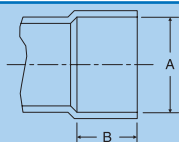

"C" DIMENSIONS
SOLDER CUP END OR ODS FEMALE CONNECTION

DIMENSIONS (Inch)		"A" maxi (in mm)	"A" mini (in mm)	"B" mini (in mm)
OD size	Nominal size			
1/8"	-	3,32	3,23	6,35
3/16"	-	4,92	4,83	7,87
1/4"	1/8"	6,50	6,40	7,87
5/16"	-	8,10	8,00	7,87
3/8"	1/4"	9,67	9,58	7,87
1/2"	3/8"	12,65	12,75	9,66
5/8"	1/2"	16,02	15,93	12,70
3/4"	5/8"	19,20	19,10	15,75
7/8"	3/4"	22,37	22,27	19,05
1"	7/8"	-	-	-
1 1/8"	1"	28,75	28,65	23,11
1 3/8"	1 1/4"	35,10	35,00	24,63
1 5/8"	1 1/2"	41,47	41,35	27,68
2 1/8"	2"	54,17	54,05	34,03
2 5/8"	2 1/2"	66,87	66,75	37,33
3 1/8"	3"	79,57	79,45	41,66
3 5/8"	3 1/2"	92,27	92,15	48,51
4 1/8"	4"	104,97	104,85	54,86

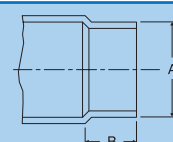

"FTG" DIMENSIONS
FITTING END OR ODF FEMALE CONNECTION

DIMENSIONS (Inch)		"A" maxi (in mm)	"A" mini (in mm)	"B" mini (in mm)
OD size	Nominal size			
1/8"	-	3,20	3,12	7,87
3/16"	-	4,80	4,72	9,65
1/4"	1/8"	6,37	6,29	9,65
5/16"	-	7,97	7,89	9,65
3/8"	1/4"	9,55	9,47	9,65
1/2"	3/8"	12,72	12,62	11,17
5/8"	1/2"	15,90	15,79	14,22
3/4"	5/8"	19,07	18,97	17,52
7/8"	3/4"	22,25	22,14	20,57
1"	7/8"	-	-	-
1 1/8"	1"	28,62	28,49	24,63
1 3/8"	1 1/4"	34,97	34,84	26,16
1 5/8"	1 1/2"	41,32	41,17	29,46
2 1/8"	2"	54,02	53,87	35,81
2 5/8"	2 1/2"	66,72	66,57	38,86
3 1/8"	3"	79,42	79,27	43,86
3 5/8"	3 1/2"	92,12	91,97	42,41
4 1/8"	4"	104,82	104,67	56,38

COUPLING - STAKED STOP

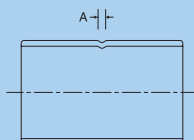

TYPE 200
Conn. C x C

Cat. No.	Connections	Dimension A (mm)
810141	1/4"	1,59
810142	5/16"	1,59
810143	3/8"	1,59
810144	1/2"	1,59
810145	5/8"	1,59
810157	3/4"	1,59
810146	7/8"	1,59
810147	1 1/8"	1,59
810148	1 3/8"	1,59
810149	1 5/8"	1,59
810150	2 1/8"	1,59
810151	2 5/8"	1,59
810152	3 1/8"	4,76
810153	3 5/8"	4,76
810154	4 1/8"	4,76
810155	5 1/8"	5,56
810156	6 1/8"	4,76
810130	8 1/8"	11,91

COUPLING - ROLLED STOP

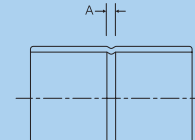

TYPE 200-RS
Conn. C x C

Cat. No.	Connections	Dimension A (mm)
801000	1/8"	1,19
801001	3/16"	1,59
801003	1/4"	1,59
801009	3/8"	1,59
801017	1/2"	1,59
801022	5/8"	1,59
801028	3/4"	1,59
801034	7/8"	1,59
801040	1"	1,59
801047	1 1/8"	1,59
801055	1 3/8"	1,59
801062	1 1/2"	1,59
801063	1 5/8"	1,59
801072	2 1/8"	4,76
801082	2 5/8"	4,76
801092	3 1/8"	4,76
810100	3 5/8"	4,76
810107	4 1/8"	4,76

COUPLING - NO STOP

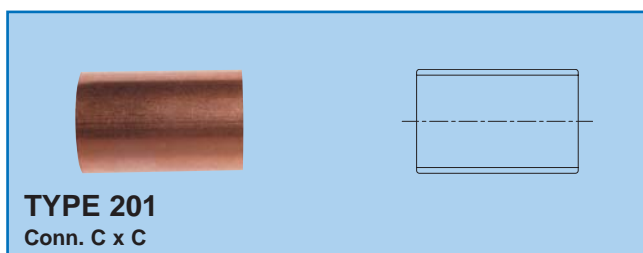

Cat. No.	Connections
801900	1/4"
801901	3/8"
801902	1/2"
801903	5/8"
801904	3/4"
801905	7/8"
801906	1 1/8"
801907	1 3/8"
801908	1 5/8"
801909	2 1/8"
801910	2 5/8"
801911	3 1/8"
801913	4 1/8"

COUPLING - REDUCING (CONTINUED)

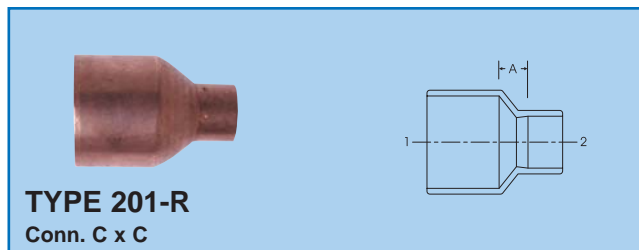

Cat. No.	Connections	Dimension A (mm)
	1 x 2	
801064	1 5/8" x 1 3/8"	7,93
801065	x 1 1/8"	11,91
801067	x 7/8"	15,08
801069	x 5/8"	19,84
801073	2 1/8" x 1 5/8"	11,91
801074	x 1 3/8"	13,89
801075	x 1 1/8"	20,64
801077	x 7/8"	23,02
801079	x 5/8"	27,78
801083	2 5/8" x 2 1/8"	15,08
801084	x 1 5/8"	22,23
801085	x 1 3/8"	25,40
801086	x 1 1/8"	20,64
801093	3 1/8" x 2 5/8"	12,70
801094	x 2 1/8"	28,81
801095	x 1 5/8"	31,75
810101	3 5/8" x 3 1/8"	11,51
810108	4 1/8" x 3 5/8"	15,88
810109	x 3 1/8"	23,02
810110	x 2 5/8"	36,51
810111	x 2 1/8"	41,28

COUPLING - REDUCING

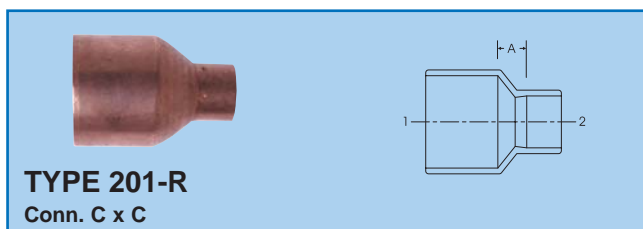

Cat. No.	Connections	Dimension A (mm)
	1 x 2	
801004	1/4" x 3/16"	3,97
801005	x 1/8"	4,76
801010	3/8" x 5/16"	1,98
801011	x 1/4"	4,76
801019	1/2" x 3/8"	5,56
801021	x 1/4"	9,53
801023	5/8" x 1/2"	3,18
801025	x 3/8"	7,54
801027	x 1/4"	9,13
801029	3/4" x 5/8"	6,35
801030	x 1/2"	4,76
801031	x 3/8"	7,94
801035	7/8" x 3/4"	5,16
801036	x 5/8"	7,54
801037	x 1/2"	10,32
801038	x 3/8"	9,52
801049	1 1/8" x 7/8"	8,73
801050	x 3/4"	9,13
801051	x 5/8"	10,32
801052	x 1/2"	11,90
801056	1 3/8" x 1 1/8"	7,14
801058	x 7/8"	10,32
801060	x 5/8"	13,49

COUPLING - UNION

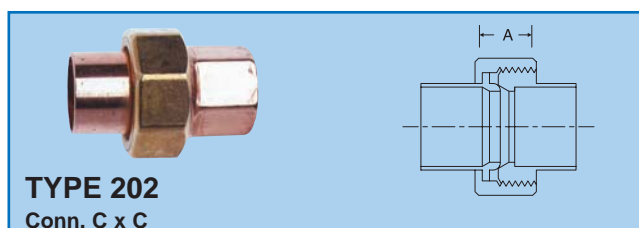

Cat. No.	Connections	Dimension A (mm)
808001	3/8"	15,08
808002	1/2"	11,11
808003	5/8"	11,91
808004	7/8"	15,88
808005	1 1/8"	11,51
A11205	1 3/8"	12,70
A11206	1 5/8"	18,26
A11207	2 1/8"	12,71
A11216	2 5/8"	25,40
A11217	3 1/8"	29,37

ADAPTER

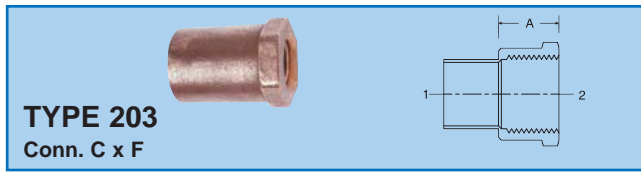

Cat. No.	Connections			Dimension A (mm)
	1	x	2	
801204	1/4"	x	1/2"	5,95
801205		x	3/8"	15,88
801206		x	1/4"	16,67
801207		x	1/8"	14,29
801214	3/8"	x	3/8"	16,67
801215		x	1/4"	15,88
801216		x	1/8"	13,49
801223	1/2"	x	3/4"	20,64
801224		x	1/2"	25,40
801225		x	3/8"	21,03
801226		x	1/4"	15,08
801230	5/8"	x	3/4"	26,59
801231		x	1/2"	21,43
801232		x	3/8"	19,45
801233		x	1/4"	12,70
801238	3/4"	x	3/4"	22,62
801239		x	1/2"	23,02
801245	7/8"	x	1"	29,37
801246		x	3/4"	21,43
801247		x	1/2"	25,40
801261	1 1/8"	x	1 1/4"	13,49
801263		x	1"	24,60
801264		x	3/4"	20,64
801265		x	1/2"	18,62
801270	1 3/8"	x	1 1/2"	35,72
801271		x	1 1/4"	30,96
801272		x	1"	25,40
801278	1 5/8"	x	2"	30,96
801279		x	1 1/2"	31,75
801280		x	1 1/4"	23,02
801287	2 1/8"	x	2"	23,81
801288		x	1 1/2"	30,16
801296	2 5/8"	x	2 1/2"	30,16
801297	3 1/8"	x	3"	33,34

ADAPTER-FITTING

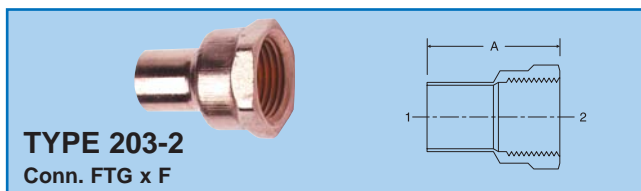

Cat. No.	Connections			Dimension A (mm)
	1	x	2	
801514	3/8"	x	3/8"	32,54
801524	1/2"	x	1/2"	29,37
801525		x	3/8"	32,94
801526		x	1/4"	28,58
801531	5/8"	x	1/2"	38,10
801532		x	3/8"	32,94
801546	7/8"	x	3/4"	43,26
801547		x	1/2"	42,86
801563	1 1/8"	x	1"	52,78
801564		x	3/4"	44,85
801571	1 3/8"	x	1 1/4"	56,36
801579	1 5/8"	x	1 1/2"	62,71
801587	2 1/8"	x	2"	61,12
801596	2 5/8"	x	2 1/2"	71,83

ADAPTER

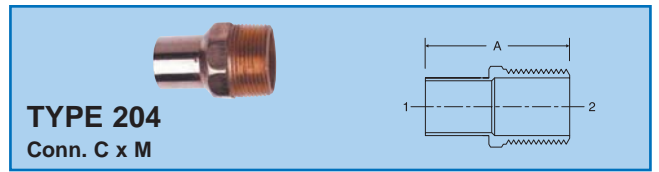

Cat. No.	Connections			Dimension A (mm)
	1	x	2	
801105	1/4"	x	3/8"	21,83
801106		x	1/4"	19,45
801107		x	1/8"	10,72
801109	5/16"	x	3/8"	21,43
801110		x	1/4"	15,88
801113	3/8"	x	1/2"	25,40
801114		x	3/8"	21,03
801115		x	1/4"	16,67
801116		x	1/8"	10,72
801123	1/2"	x	3/4"	28,18
801124		x	1/2"	20,64
801125		x	3/8"	16,67
801126		x	1/4"	22,23
801129	5/8"	x	1"	36,91
801130		x	3/4"	23,81
801131		x	1/2"	20,64
801132		x	3/8"	16,27
801133		x	1/4"	19,05
801138	3/4"	x	3/4"	25,80
801139		x	1/2"	27,78
801145	7/8"	x	1"	29,37
801146		x	3/4"	23,02
801147		x	1/2"	22,22
801161	1 1/8"	x	1 1/2"	43,26
801162		x	1 1/4"	39,69
801163		x	1"	29,87
801164		x	3/4"	23,42
801165		x	1/2"	24,61
801170	1 3/8"	x	1 1/2"	42,07
801171		x	1 1/4"	32,54
801172		x	1"	25,40
801173		x	3/4"	24,61
801178	1 5/8"	x	2"	30,96
801179		x	1 1/2"	31,75
801180		x	1 1/4"	26,99
801181		x	1"	27,78
801187	2 1/8"	x	2"	32,94
801188		x	1 1/2"	27,78
801189		x	1 1/4"	30,96
801196	2 5/8"	x	2 1/2"	45,24
801197		x	2"	28,58
801198		x	1 1/2"	30,96
801199	3 1/8"	x	3"	36,12
801150	4 1/8"	x	4"	48,42

ADAPTER-FITTING

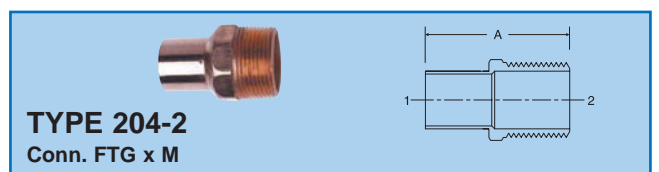

Cat. No.	Connections			Dimension A (mm)
	1	x	2	
801414	3/8"	x	3/8"	31,75
801425	1/2"	x	3/8"	31,53
801431	5/8"	x	1/2"	34,93
801432		x	3/8"	30,96
801446	7/8"	x	3/4"	48,82
801447		x	1/2"	46,83
801463	1 1/8"	x	1"	57,15
801464		x	3/4"	51,99
801471	1 3/8"	x	1 1/4"	62,71
801479	1 5/8"	x	1 1/2"	65,88
801487	2 1/8"	x	2"	70,25
801496	2 5/8"	x	2 1/2"	85,73

90° ELBOW

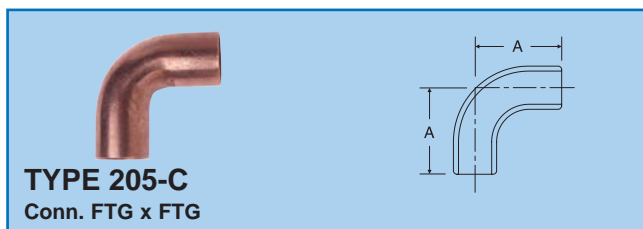

Cat. No.	Connections	Dimension A (mm)
802612	3/8"	19,05
802621	1/2"	23,81
802626	5/8"	29,37
802634	7/8"	41,28
802644	1 1/8"	51,59
802684	1 3/8"	52,78
802685	1 5/8"	60,33
802686	2 1/8"	75,41
802687	2 5/8"	84,53
802688	3 1/8"	96,04
802689	3 5/8"	110,30
802690	4 1/8"	123,80

45° ELBOW



Cat. No.	Connections	Dimension A (mm)	Dimension B (mm)
803312	3/8"	14,29	4,76
803321	1/2"	16,67	5,16
803326	5/8"	20,64	6,75
803330	3/4"	25,40	7,94
803334	7/8"	29,77	9,13
803344	1 1/8"	36,51	11,91
803350	1 3/8"	37,08	18,26
803355	1 5/8"	52,78	23,82
803359	2 1/8"	67,07	31,75
803363	2 5/8"	78,58	39,69
803368	3 1/8"	85,73	42,07
803373	4 1/8"	105,57	49,21

90° ELBOW - LONG RADIUS

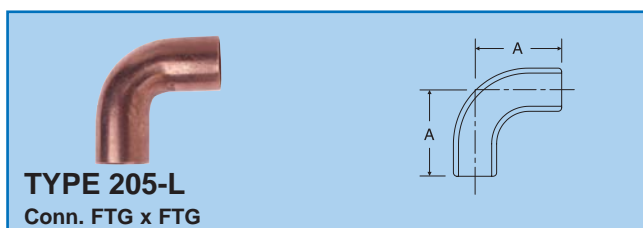

Cat. No.	Connections	Dimension A (mm)
802650	1 3/8"	73.82
802655	1 5/8"	87.31
802659	2 1/8"	110.70

45° ELBOW



Cat. No.	Connections	Dimension A (mm)
803621	1/2"	16,67
803626	5/8"	20,64
803634	7/8"	29,77
803644	1 1/8"	36,51

45° ELBOW

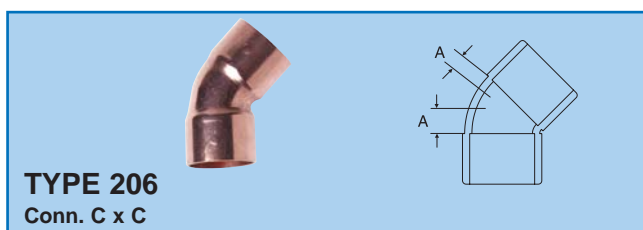

Cat. No.	Connections	Dimension A (mm)
803005	1/4"	4,76
803012	3/8"	4,76
803021	1/2"	5,16
803026	5/8"	6,75
803030	3/4"	7,94
803034	7/8"	9,13
803044	1 1/8"	11,91
803050	1 3/8"	11,11
803055	1 5/8"	12,70
803059	2 1/8"	15,88
803063	2 5/8"	39,69
803067	3 1/8"	42,07
803070	3 5/8"	44,45
803073	4 1/8"	49,21

90° ELBOW



Cat. No.	Connections	Dimension A (mm)	Dimension B (mm)
802003	1/4"	9,53	9,53
802009	3/8"	9,53	9,53
802017	1/2"	12,70	12,70
801622	5/8"	15,08	15,08
802028	3/4"	22,23	22,23
801634	7/8"	21,03	21,03
802040	1"	28,58	28,58
801647	1 1/8"	27,38	27,38
802084	1 3/8"	27,78	27,78
802085	1 5/8"	30,96	30,96
802086	2 1/8"	39,69	39,69
802087	2 5/8"	46,04	46,04
802088	3 1/8"	40,39	40,39
802089	3 5/8"	61,12	61,12
802090	4 1/8"	69,06	69,06
802097	6 1/8"	105,50	105,50

90° ELBOW



Cat. No.	Connections	Dimension	
		A (mm)	B (mm)
802305	1/4"	19,05	9,53
802312	3/8"	19,05	9,53
802321	1/2"	28,81	12,70
802326	5/8"	29,37	15,08
801652	5/8"	29,37	15,08
802330	3/4"	36,51	22,23
802334	7/8"	41,28	20,64
801654	7/8"	41,28	20,64
802344	1 1/8"	51,60	26,99
802384	1 3/8"	52,78	26,99
802385	1 5/8"	60,33	30,96
802386	2 1/8"	77,39	40,48
802387	2 5/8"	84,93	46,04
802388	3 1/8"	96,04	52,39
802389	3 5/8"	111,10	59,93
802390	4 1/8"	130,40	59,93

90° ELBOW REDUCING



Cat. No.	Connections			Dimension	
	1	x	2	A (mm)	B (mm)
802011	3/8"	x	1/4"	11,11	8,73
802019	1/2"	x	3/8"	14,29	11,11
802023	5/8"	x	1/2"	15,88	12,70
802025		x	3/8"	16,67	11,11
802029	3/4"	x	5/8"	17,46	15,08
802030		x	1/2"	20,64	12,70
802035	7/8"	x	3/4"	23,02	22,23
802036		x	5/8"	23,42	16,67
802037		x	1/2"	23,81	15,88
802049	1 1/8"	x	7/8"	25,40	22,23
802050		x	3/4"	25,40	22,23
802051		x	5/8"	30,16	19,05
802052		x	1/2"	34,13	16,67
802056	1 3/8"	x	1 1/8"	36,51	28,58
802077	1 5/8"	x	1 3/8"	28,97	21,83
802078	2 1/8"	x	1 5/8"	39,69	30,56

90° ELBOW - LONG RADIUS



Cat. No.	Connections	Dimension	
		A (mm)	B (mm)
802701	3/16"	7,94	7,94
802715	1/4"	12,70	12,70
802710	5/16"	14,29	14,29
802716	3/8"	19,05	19,05
802717	1/2"	19,05	19,05
802722	5/8"	22,23	22,23
802728	3/4"	28,58	28,58
802734	7/8"	30,16	30,16
802747	1 1/8"	38,10	38,10

90° ELBOW - LONG RADIUS (CONTINUED)



Cat. No.	Connections	Dimension	
		A (mm)	B (mm)
802055	1 3/8"	47,63	47,63
802063	1 5/8"	57,15	57,15
802072	2 1/8"	73,03	73,03
802082	2 5/8"	92,87	92,87
802092	3 1/8"	117,50	117,50
802093	3 5/8"	124,60	124,60
802095	4 1/8"	149,20	149,20

90° ELBOW - LONG RADIUS



Cat. No.	Connections	Dimension	
		A (mm)	B (mm)
802809	3/8"	28,58	19,05
802817	1/2"	30,16	19,05
802822	5/8"	34,93	22,23
802828	3/4"	46,04	28,58
802834	7/8"	50,80	30,16
802847	1 1/8"	62,71	38,10
802350	1 3/8"	73,82	47,63
802355	1 5/8"	87,31	57,15
802359	2 1/8"	108,70	73,03
802363	2 5/8"	130,90	92,87
802368	3 1/8"	159,50	117,50
802393	3 5/8"	205,60	149,20
802395	4 1/8"	205,60	149,22

90° ELBOW - LONG RADIUS REDUCING



Cat. No.	Connections			Dimension	
	1	x	2	A (mm)	B (mm)
802711	3/8"	x	1/4"	15,08	11,91
802719	1/2"	x	3/8"	15,08	11,91
802723	5/8"	x	1/2"	19,05	17,46
802725		x	3/8"	17,46	15,88
802735	7/8"	x	3/4"	29,37	26,99
802736		x	5/8"	22,23	22,23
802737		x	1/2"	21,43	17,46
802749	1 1/8"	x	7/8"	31,75	28,97
802751		x	5/8"	28,58	22,23
802756	1 3/8"	x	1 1/8"	41,28	37,31
802058		x	7/8"	50,40	34,93
802060		x	5/8"	54,77	34,93
802064	1 5/8"	x	1 3/8"	48,82	47,63
802065		x	1 1/8"	53,98	41,28
802067		x	7/8"	51,99	34,93
802073	2 1/8"	x	1 5/8"	61,91	55,17
802074		x	1 3/8"	63,50	53,98
802075		x	1 1/8"	63,50	53,18
802083	2 5/8"	x	2 1/8"	75,40	75,40

TEE

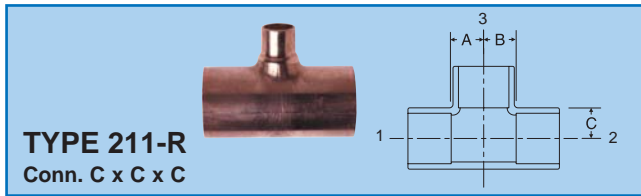

Cat. No.	Connections					Dimension		
	1	x	2	x	3	A (mm)	B (mm)	C (mm)
840368	1/4"	x	1/4"	x	3/8"	13,09	13,09	4,76
840308		x		x	3/16"	11,90	11,90	8,73
840334	5/16"	x	5/16"	x	3/8"	11,90	11,90	5,55
840416	3/8"	x	3/8"	x	5/8"	18,65	18,65	8,73
840405		x		x	1/2"	6,35	6,35	5,95
840324		x		x	1/4"	3,97	3,97	5,55
840325		x		x	3/16"	8,73	8,73	14,28
840330		x	1/4"	x	3/8"	5,16	13,09	4,76
840332	x	x		1/4"	3,97	9,53	5,55	
840415	1/2"	x	1/2"	x	5/8"	16,67	16,67	8,33
840402		x		x	3/8"	5,55	5,55	7,14
840350		x		x	1/4"	5,56	5,56	15,08
840403		x	3/8"	x	1/2"	6,75	14,28	6,35
840404	x	x		3/8"	5,55	12,70	7,14	
840358	x	x		1/4"	5,55	13,09	15,08	
840363		x	1/4"	x	1/2"	6,75	15,48	6,35
840364	x	x		3/8"	5,55	16,67	7,54	
840366	x	x		1/4"	5,55	16,67	18,26	
840467	5/8"	x	5/8"	x	1 1/8"	30,95	30,95	14,28
840447		x		x	7/8"	11,90	11,90	8,33
840429		x		x	3/4"	11,51	11,51	10,32
840407		x		x	1/2"	6,75	6,75	9,92
840408		x		x	3/8"	6,75	6,75	17,46
840414		x		x	1/4"	6,75	6,75	17,46
840409		x	1/2"	x	5/8"	8,33	15,88	8,33
840410	x	x		1/2"	6,75	14,28	9,92	
840411	x	x		3/8"	6,75	15,48	17,46	
840412		x	3/8"	x	5/8"	8,33	17,46	8,33
840367	x	x		1/2"	6,75	15,48	9,92	
840413	x	x		3/8"	6,75	15,48	17,46	
840446	3/4"	x	3/4"	x	7/8"	13,09	13,09	12,30
840418		x		x	5/8"	8,33	8,33	11,11
840419		x		x	1/2"	8,33	8,33	21,03
840420		x		x	3/8"	8,33	8,33	20,64
840421		x	5/8"	x	3/4"	10,32	19,05	9,92
840422	x	x		5/8"	15,08	25,80	11,51	
840423	x	x		1/2"	8,33	19,45	21,03	
840425		x	1/2"	x	3/4"	10,32	23,81	9,92
840426	x	x		5/8"	8,33	22,62	11,11	
840427	x	x		1/2"	8,33	22,62	21,03	
840465	7/8"	x	7/8"	x	1 1/8"	14,68	14,68	13,89
840432		x		x	3/4"	11,90	11,90	21,43
840433		x		x	5/8"	8,33	8,33	13,89
840434		x		x	1/2"	8,33	8,33	21,83
840435		x		x	3/8"	8,33	8,33	23,81
840436		x	3/4"	x	7/8"	11,90	18,26	11,51
840437	x	x		3/4"	11,90	18,26	21,43	

TEE (CONTINUED)

Cat. No.	Connections					Dimension		
	1	x	2	x	3	A (mm)	B (mm)	C (mm)
804041	7/8"	x	5/8"	x	7/8"	11,90	18,26	11,51
804042		x		x	3/4"	11,90	18,65	21,43
804043		x		x	5/8"	8,33	18,26	13,89
804044		x		x	1/2"	8,33	15,88	21,83
804045		x		x	3/8"	8,33	17,46	23,81
840230		x	1/2"	x	7/8"	11,90	24,61	11,51
840231		x		x	5/8"	8,33	23,81	13,49
840232		x		x	1/2"	8,33	20,24	20,24
840101	1 1/8"	x	1 1/8"	x	1 5/8"	42,07	42,07	21,03
804082		x		x	1 3/8"	17,46	17,46	14,68
804049		x		x	7/8"	11,90	11,90	19,45
804050		x		x	3/4"	11,90	11,90	25,80
804051		x		x	5/8"	9,13	9,13	51,59
804052		x		x	1/2"	9,13	9,13	27,78
804055		x	7/8"	x	1 1/8"	15,08	26,59	15,88
804056		x		x	7/8"	11,90	19,45	19,45
804057		x		x	3/4"	11,90	19,45	25,80
804058		x		x	5/8"	9,13	16,27	51,59
804059		x		x	1/2"	9,13	16,27	27,78
840233		x	3/4"	x	1 1/8"	14,68	30,95	14,28
840234		x		x	7/8"	11,90	26,19	19,45
840235		x		x	3/4"	11,90	26,19	26,99
840236		x		x	5/8"	9,13	24,61	16,67
804061		x	5/8"	x	1 1/8"	14,68	30,95	14,28
804062		x		x	7/8"	11,90	29,37	19,45
804063		x		x	5/8"	9,13	24,61	16,67
840122	1 3/8"	x	1 3/8"	x	2 1/8"	52,39	52,39	27,78
840100		x		x	1 5/8"	21,43	21,43	18,26
804069		x		x	1 1/8"	14,68	14,68	21,03
804070		x		x	7/8"	14,68	14,68	32,94
804071		x		x	5/8"	14,28	14,28	36,12
804072		x		x	1/2"	15,08	15,08	39,69
804073		x	1 1/8"	x	1 3/8"	18,26	30,95	19,45
804074		x		x	1 1/8"	15,08	28,58	21,03
804075		x		x	7/8"	15,08	28,58	33,34
804076		x		x	5/8"	15,08	28,58	37,70
804077		x		x	1/2"	13,49	15,88	10,32
804078		x	7/8"	x	1 3/8"	18,26	34,93	17,86
804079		x		x	1 1/8"	15,08	31,75	21,03
804080		x		x	7/8"	15,08	31,75	52,78
804081		x		x	5/8"	15,08	31,75	57,55
804083		x	5/8"	x	1 3/8"	18,26	41,28	17,46
840121	1 5/8"	x	1 5/8"	x	2 1/8"	26,99	26,99	22,62
804085		x		x	1 3/8"	17,86	17,86	23,81
804086		x		x	1 1/8"	17,86	17,86	40,48
804087		x		x	7/8"	17,86	17,86	46,43
804088		x		x	5/8"	17,86	17,86	48,02
804089		x		x	1/2"	17,86	17,86	50,80
804090		x	1 3/8"	x	1 5/8"	21,43	30,16	21,03
804091		x		x	1 3/8"	17,86	30,16	23,81
804092		x		x	1 1/8"	17,86	30,16	37,31
804093		x		x	7/8"	17,86	33,73	41,28
804094		x		x	5/8"	17,86	33,73	44,85
804095		x	1 1/8"	x	1 5/8"	21,03	43,66	21,03
804096		x		x	1 3/8"	18,26	36,91	23,81
804097		x		x	1 1/8"	18,26	36,91	40,48
804098		x		x	7/8"	18,26	36,91	46,43
840237		x		x	5/8"	18,26	42,86	49,61

TEE (CONTINUED)

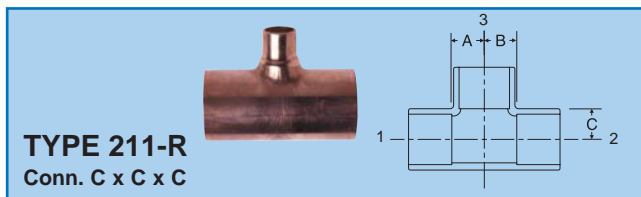

Cat. No.	Connections					Dimension		
	1	x	2	x	3	A (mm)	B (mm)	C (mm)
8404099	1 5/8"	x	7/8"	x	1 5/8"	21,43	53,98	21,03
840239		x		x	1 3/8"	18,26	42,86	23,81
840240		x		x	1 1/8"	18,26	42,86	40,48
840238		x		x	7/8"	18,26	42,86	46,43
840243		x		x	5/8"	18,26	36,91	49,61
840244		x	5/8"	x	1 5/8"	21,43	57,15	21,03
840153	2 1/8"	x	2 1/8"	x	3 1/8"	46,04	46,04	27,78
840144		x		x	2 5/8"	34,13	34,13	27,78
840103		x		x	1 5/8"	21,43	21,43	30,56
840104		x		x	1 3/8"	21,43	21,43	46,83
840105		x		x	1 1/8"	14,68	14,68	32,54
840106		x		x	7/8"	14,68	14,68	42,86
840107		x		x	5/8"	14,68	14,68	49,21
840108		x		x	1/2"	14,68	14,68	51,20
840109		x	1 5/8"	x	2 1/8"	27,78	50,40	27,78
840110		x		x	1 5/8"	21,43	43,66	30,95
840111		x		x	1 3/8"	21,43	43,66	46,83
840112		x		x	1 1/8"	14,68	36,91	32,94
840113		x		x	7/8"	14,68	36,91	42,86
840114		x		x	5/8"	14,68	39,69	49,21
840115		x	1 3/8"	x	2 1/8"	28,18	51,99	28,18
840116		x		x	1 5/8"	21,43	46,83	30,95
840117		x		x	1 3/8"	21,43	46,83	46,83
840118		x		x	1 1/8"	15,08	40,08	33,34
840119		x		x	7/8"	14,68	40,48	42,86
840120		x		x	5/8"	14,68	40,48	49,21
840245		x	1 1/8"	x	2 1/8"	15,08	75,01	32,54
840247		x		x	1 1/8"	27,78	64,29	28,58
840248		x	7/8"	x	2 1/8"	27,78	68,26	28,58
840249		x	5/8"	x	2 1/8"	27,78	69,06	28,58
840124	2 5/8"	x	2 5/8"	x	2 1/8"	27,78	27,78	38,89
840125		x		x	1 5/8"	27,78	27,78	58,74
840126		x		x	1 3/8"	27,78	27,78	63,50
840127		x		x	1 1/8"	27,78	27,78	70,64
840128		x		x	7/8"	27,78	27,78	72,63
840129		x		x	5/8"	27,78	27,78	76,20
840130		x	2 1/8"	x	2 5/8"	33,34	61,91	34,93
840131		x		x	2 1/8"	27,38	55,16	38,10
840132		x		x	1 5/8"	27,38	55,16	61,91
840133		x		x	1 3/8"	27,38	55,16	66,68
840134		x		x	1 1/8"	27,38	55,16	71,04
840135		x		x	7/8"	27,38	55,16	76,99
840136		x		x	5/8"	27,38	55,16	80,96
840137		x	1 5/8"	x	2 5/8"	33,34	70,25	34,93
840138		x		x	2 1/8"	27,78	61,52	38,10
840139		x		x	1 5/8"	27,78	61,52	61,91
840140		x		x	1 3/8"	27,78	61,52	65,09
840141		x		x	1 1/8"	27,78	61,52	71,04
840142		x		x	7/8"	27,78	61,52	73,82
840143		x		x	5/8"	27,78	61,52	76,60
840220		x	1 3/8"	x	2 5/8"	33,34	73,03	34,93
840250		x		x	2 1/8"	27,78	64,69	38,10

TEE (CONTINUED)

Cat. No.	Connections					Dimension		
	1	x	2	x	3	A (mm)	B (mm)	C (mm)
840251		x		x	1 ⁵ / ₈ "	27,78	64,69	61,91
840252		x		x	1 ³ / ₈ "	27,78	64,69	66,68
840253		x		x	1 ¹ / ₈ "	27,78	64,69	69,85
840254		x		x	7/ ₈ "	27,78	64,69	72,23
840255		x		x	5/ ₈ "	27,78	64,69	75,41
840221	2 ⁵ / ₈ "	x	1 ¹ / ₈ "	x	2 ⁵ / ₈ "	33,34	76,20	36,91
840256		x		x	2 ¹ / ₈ "	27,38	69,06	38,10
840257		x		x	1 ⁵ / ₈ "	27,78	69,06	61,91
840258		x		x	1 ³ / ₈ "	27,78	68,26	63,50
840259		x		x	1 ¹ / ₈ "	27,38	69,06	69,85
840222		x	7/ ₈ "	x	2 ⁵ / ₈ "	33,34	84,14	34,93
840151	3 ¹ / ₈ "	x	3 ¹ / ₈ "	x	2 ⁵ / ₈ "	40,48	40,48	75,41
840150		x		x	2 ¹ / ₈ "	27,38	27,38	45,24
840149		x		x	1 ⁵ / ₈ "	27,38	27,38	69,85
840148		x		x	1 ³ / ₈ "	27,38	27,38	76,20
840147		x		x	1 ¹ / ₈ "	18,26	18,26	47,23
840146		x		x	7/ ₈ "	18,26	18,26	59,53
840145		x		x	5/ ₈ "	18,26	18,26	64,29
840159		x	2 ⁵ / ₈ "	x	3 ¹ / ₈ "	40,48	69,85	41,28
840158		x		x	2 ⁵ / ₈ "	40,48	71,43	72,23
840157		x		x	2 ¹ / ₈ "	27,38	54,77	45,24
840156		x		x	1 ⁵ / ₈ "	27,38	54,77	68,26
840155		x		x	1 ³ / ₈ "	27,38	54,77	71,04
840154		x		x	1 ¹ / ₈ "	18,26	42,86	50,80
840167		x	2 ¹ / ₈ "	x	3 ¹ / ₈ "	40,48	77,79	41,67
840165		x		x	2 ⁵ / ₈ "	40,48	80,96	72,23
840164		x		x	2 ¹ / ₈ "	27,38	64,29	45,24
840163		x		x	1 ⁵ / ₈ "	27,38	65,88	69,85
840162		x		x	1 ³ / ₈ "	27,38	57,55	73,03
840161		x		x	1 ¹ / ₈ "	18,26	53,98	50,80
840174		x	1 ⁵ / ₈ "	x	3 ¹ / ₈ "	42,07	87,31	41,28
840181		x	1 ³ / ₈ "	x	3 ¹ / ₈ "	40,48	87,31	41,28
840178		x	1 ¹ / ₈ "	x	3 ¹ / ₈ "	40,48	88,90	41,67
840179		x	7/ ₈ "	x	3 ¹ / ₈ "	40,48	92,87	41,28
840198	4 ¹ / ₈ "	x	4 ¹ / ₈ "	x	3 ¹ / ₈ "	40,48	40,48	67,07
840197		x		x	2 ⁵ / ₈ "	40,48	40,48	81,36
840196		x		x	2 ¹ / ₈ "	26,99	26,99	59,93
840195		x		x	1 ⁵ / ₈ "	26,99	26,99	81,76
840194		x		x	1 ³ / ₈ "	26,99	26,99	92,07
840193		x		x	1 ¹ / ₈ "	14,68	14,68	65,48
840192		x		x	7/ ₈ "	14,28	14,28	77,79
840191		x		x	5/ ₈ "	14,28	14,28	75,80
840208		x	3 ¹ / ₈ "	x	4 ¹ / ₈ "	53,98	95,25	55,96
840206		x		x	3 ¹ / ₈ "	40,48	79,38	67,07
840205		x		x	2 ⁵ / ₈ "	40,48	79,38	81,36
840204		x		x	2 ¹ / ₈ "	26,99	66,68	62,71
840212		x	2 ⁵ / ₈ "	x	4 ¹ / ₈ "	53,98	100,01	55,96
840216		x	2 ¹ / ₈ "	x	4 ¹ / ₈ "	53,98	55,16	55,96
840215		x	1 ⁵ / ₈ "	x	4 ¹ / ₈ "	53,98	112,32	55,96
840214		x	1 ³ / ₈ "	x	4 ¹ / ₈ "	53,98	115,49	55,56
840213		x	1 ¹ / ₈ "	x	4 ¹ / ₈ "	53,98	118,66	55,96
840503	6 ¹ / ₈ "	x	6 ¹ / ₈ "	x	3 ¹ / ₈ "	44,45	44,45	94,85
840504		x		x	2 ⁵ / ₈ "	44,45	44,45	121,84
840505		x		x	2 ¹ / ₈ "	44,45	44,45	125,01

TEE

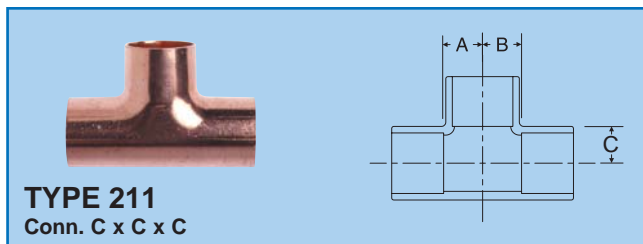

Cat. No.	Connections	Dimension		
		A (mm)	B (mm)	C (mm)
840302	3/16"	2.78	2.78	19.80
840306	1/4"	3.97	3.97	3.97
840313	5/16"	5.16	5.16	4.76
840400	3/8"	5.16	5.16	4.76
840401	1/2"	6.75	6.75	6.35
840406	5/8"	8.33	8.33	8.33
840417	3/4"	10.32	10.32	9.92
840431	7/8"	11.91	11.91	11.51
840408	1 1/8"	14.68	14.68	14.29
840468	1 3/8"	18.26	18.26	17.86
840484	1 5/8"	21.03	21.03	21.03
840102	2 1/8"	27.78	27.78	27.78
840123	2 5/8"	33.34	33.34	34.93
840152	3 1/8"	40.48	40.48	41.28
840190	3 5/8"	49.21	49.21	43.26
840200	4 1/8"	80.77	80.77	80.77
840500	6 1/8"	77.79	77.79	82.55

TEE - FITTING

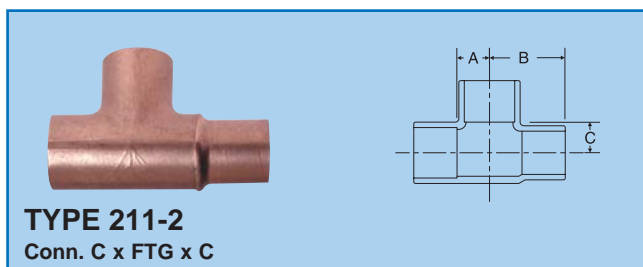

Cat. No.	Connections	Dimension		
		A (mm)	B (mm)	C (mm)
804106	5/8"	8,33	32,94	8,33
804131	7/8"	11,91	45,24	11,50

PLUG

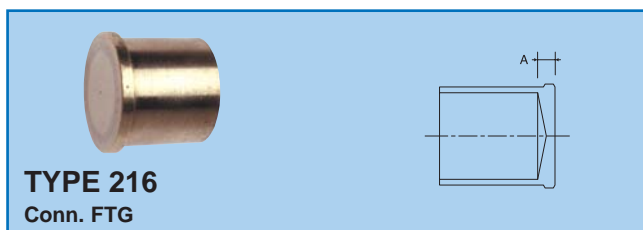

Cat. No.	Connections	Dimension A (mm)
A01402	1/4"	3,18
A01422	3/8"	3,18
A01392	1/2"	3,18
A01504	5/8"	3,18
A02273	3/4"	3,18
A01529	7/8"	3,18
A01556	1 1/8"	3,18
A01590	1 3/8"	3,18
A01628	1 5/8"	3,18

CAP



Cat. No.	Connections	Dimension A (mm)
807002	1/4"	0,80
807004	3/8"	0,80
807006	1/2"	0,80
807007	5/8"	0,80
807008	3/4"	1,20
807009	7/8"	1,20
807011	1 1/8"	1,20
807012	1 3/8"	1,20
807013	1 5/8"	1,59
807014	2 1/8"	1,59
807015	2 5/8"	1,99
807016	3 1/8"	1,99
807017	3 5/8"	2,39
807018	4 1/8"	2,78

BUSHING - EXTENDED



Cat. No.	Connections			Dimension A (mm)
	1	x	2	
801302	1/4"	x	1/8"	13,49
801306	3/8"	x	1/4"	9,53
801312	1/2"	x	3/8"	15,86
801314		x	1/4"	15,08
801315	5/8"	x	1/2"	19,05
801317		x	3/8"	19,84
801320	3/4"	x	5/8"	22,23
801321		x	1/2"	23,02
801322		x	3/8"	22,23
801325	7/8"	x	3/4"	24,61
801326		x	5/8"	24,21
801327		x	1/2"	28,58
801337	1 1/8"	x	7/8"	28,18
801338		x	3/4"	31,75
801339		x	5/8"	34,13
801340		x	1/2"	34,93
801343	1 3/8"	x	1 1/8"	30,96
801345		x	7/8"	34,13
801347		x	5/8"	38,10
801350	1 5/8"	x	1 3/8"	35,72
801351		x	1 1/8"	38,89
801353		x	7/8"	42,86
801355		x	5/8"	44,45
801358	2 1/8"	x	1 5/8"	46,83
801359		x	1 3/8"	51,60
801360		x	1 1/8"	53,98
801362		x	7/8"	55,56
801364		x	5/8"	66,68
801367	2 5/8"	x	2 1/8"	51,59
801368		x	1 5/8"	56,36
801369		x	1 3/8"	62,71
801370		x	1 1/8"	73,03
801376	3 1/8"	x	2 5/8"	51,59
801377		x	2 1/8"	63,50
801378		x	1 5/8"	75,41
801379		x	1 3/8"	76,20
801381	3 5/8"	x	3 1/8"	59,53
801382		x	2 5/8"	66,28
801383		x	2 1/8"	78,58
801386	4 1/8"	x	3 5/8"	63,50
801387		x	3 1/8"	75,41
801388		x	2 5/8"	90,09
801389		x	2 1/8"	92,87

BUSHING - FLUSH



Cat. No.	Connections			Dimension A (mm)
	1	x	2	
801706	3/8"	x	1/4"	9,53
801712	1/2"	x	3/8"	11,11
801714		x	1/4"	11,11
801715	5/8"	x	1/2"	14,29
801717		x	3/8"	14,29
801720	3/4"	x	5/8"	17,46
801721		x	1/2"	17,46
801722		x	3/8"	17,46
801725	7/8"	x	3/4"	20,64
801726		x	5/8"	20,64
801727		x	1/2"	20,64
801737	1 1/8"	x	7/8"	24,61
801738		x	3/4"	24,61
801739		x	5/8"	24,61
801743	1 3/8"	x	1 1/8"	26,20
801745		x	7/8"	26,20
801750	1 5/8"	x	1 3/8"	29,37
801751		x	1 1/8"	29,37
801758	2 1/8"	x	1 5/8"	35,72
801759		x	1 3/8"	35,72
801767	2 5/8"	x	2 1/8"	38,89

BUSHING - FLUSH



Cat. No.	Connections			Dimension A (mm)
	1	x	2	
A07812	5/8"	x	1/8"	13,49
A07813		x	1/4"	14,29
A07814	7/8"	x	3/8"	20,64
A07815	1 1/8"	x	1/2"	24,61
A07816	1 3/8"	x	3/4"	30,56
A07817	1 5/8"	x	1"	27,38
A07819	2 1/8"	x	1 1/2"	35,72

COPPER TUBE STRAP - 2 HOLE



Cat. No.	Connections
A01203	1/4"
A01278	3/8"
A01366	1/2"
A02529	5/8"
A01467	3/4"
A02574	7/8"
A02614	1 1/8"
A02650	1 3/8"
A02675	1 5/8"
A02708	2 1/8"

P-TRAP - SUCTION LINE

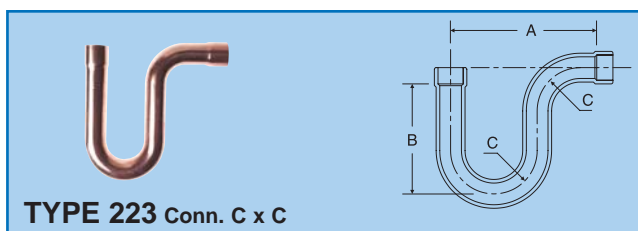

Cat. No.	Connections	Dimension		
		A (mm)	B (mm)	C (mm)
860999	5/8"	152,4	139,7	38,1
861008	3/4"	149,2	136,5	38,1
861000	7/8"	146,1	133,4	38,1
861001	1 1/8"	127,8	129,4	38,1
861002	1 3/8"	166,7	129,4	47,6
861003	1 5/8"	219,9	184,9	63,5
861009	2 1/8"	235,7	219,9	76,2

HANGER - HI-EAR

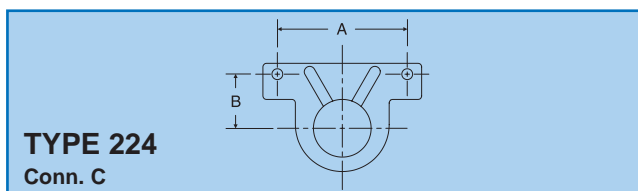

Cat. No.	Connections	Dimension	
		A (mm)	B (mm)
A03167	5/8"	41,28	18,65
A03168	7/8"	41,28	22,23
A03171	1 1/8"	28,18	25,40

COPPER TUBE STRAP - PERFORATED

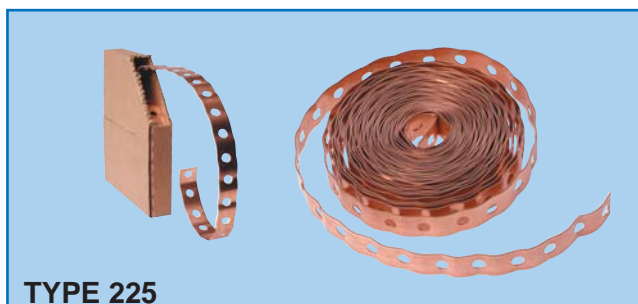

Cat. No.	Connections	Dimension A (mm)
A01211	7,60 m	0,75

DISTRIBUTOR

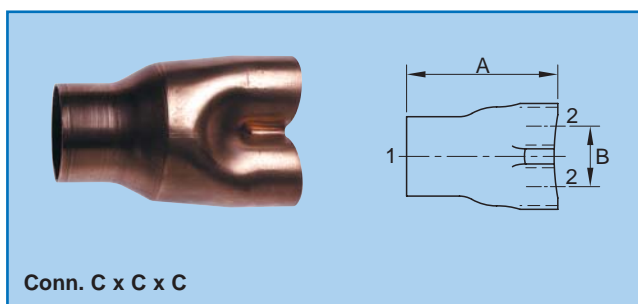

RETURN BEND

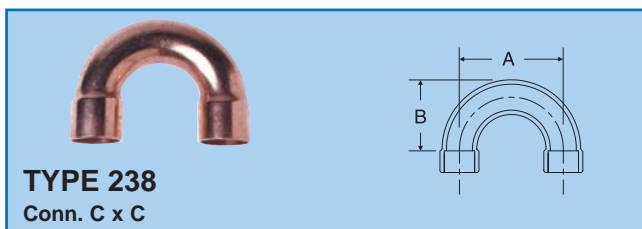

Cat. No.	Connections	Dimension	
		A (mm)	B (mm)
806025	3/8"	114,3	61,9
806020	3/8"	38,1	23,8
806048	1/2"	152,4	82,6
806045	1/2"	101,6	58,7
806041	1/2"	76,2	44,5
806036	1/2"	50,8	31,8
806032	1/2"	38,1	25,4
806069	5/8"	152,4	84,1
806060	5/8"	76,2	46,1
806058	5/8"	63,5	39,7
806056	5/8"	57,2	38,1
806053	5/8"	47,6	31,8
806051	5/8"	39,7	27,8
806084	3/4"	101,6	47,6
806074	3/4"	54,0	36,5
806077	3/4"	63,5	41,3
806095	7/8"	85,7	54,0
806092	7/8"	63,5	42,9
860110	1 1/8"	76,2	52,4
860111	1 1/8"	82,6	55,6
860121	1 3/8"	95,3	65,1
860131	1 5/8"	114,3	80,4
860140	2 1/8"	139,7	96,8

90° ELBOW - FORGED BRASS

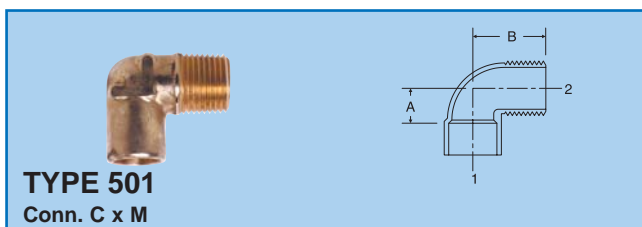

Cat. No.	Connections			Dimension	
	1	x	2	A (mm)	B (mm)
802105	1/4"	x	3/8"	25,40	11,51
802106			1/4"	22,23	9,53
802107			1/8"	19,05	3,18
802113	3/8"	x	1/2"	31,75	11,91
802114			3/8"	25,40	11,51
802115			1/4"	22,23	6,35
802116			1/8"	19,05	7,54
802123	1/2"	x	3/4"	38,10	14,29
802124			1/2"	31,75	7,94
802125			3/8"	25,40	7,94
802126			1/4"	25,40	6,35
802130	5/8"	x	3/4"	38,10	14,29
802131			1/2"	31,75	13,49
802132			3/8"	28,58	11,11
802137	3/4"	x	1"	42,86	11,91
802138			3/4"	38,10	11,91
802146	7/8"	x	3/4"	38,10	14,29
802147			1/2"	35,72	13,10
802148			3/8"	30,56	13,10
802163	1 1/8"	x	1"	43,66	18,26
802164			3/4"	38,89	18,26
802179	1 5/8"	x	1 1/2"	50,80	23,02
802187	2 1/8"	x	2"	33,34	30,16

90° ELBOW - FORGED BRASS

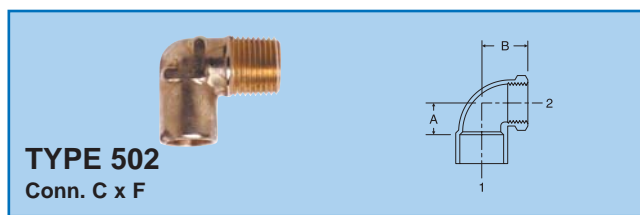

Cat. No.	Connections			Dimension	
	1	x	2	A (mm)	B (mm)
802206	1/4"	x	1/4"	12,70	19,05
802207			1/8"	11,11	19,84
802214	3/8"	x	3/8"	14,29	17,86
802215			1/4"	12,70	19,05
802216			1/8"	6,35	19,84
802224	1/2"	x	1/2"	16,67	23,42
802225			3/8"	12,70	17,86
802226			1/4"	11,11	19,05
802230	5/8"	x	3/4"	16,67	25,40
802231			1/2"	12,70	23,81
802232			3/8"	14,68	19,84
802238	3/4"	x	3/4"	16,67	26,59
802239			1/2"	16,67	26,20
802246	7/8"	x	3/4"	16,67	26,59
802247			1/2"	13,10	27,78
802264	1 1/8"	x	3/4"	18,26	30,96
802271	1 3/8"	x	1 1/4"	26,19	42,86
802280	1 5/8"	x	1 1/4"	23,02	40,08

TEE - FORGED BRASS



Cat. No.	Connections					Dimension	
	1	x	2	x	3	A (mm)	B (mm)
804208	1/4"	x	1/4"	x	1/4"	11,11	14,29
804209					1/8"	6,35	10,72
804228	3/8"	x	3/8"	x	3/8"	14,29	16,67
804229					1/4"	11,11	15,88
804230					1/8"	11,11	14,29
804259	1/2"	x	1/2"	x	3/8"	12,70	18,26
804283	5/8"	x	5/8"	x	1/2"	18,65	10,32

CROSS - FORGED BRASS



Cat. No.	Connections		Dimension	
			A (mm)	B (mm)
A01409	1/4"		6,35	6,35
A01431	3/8"		10,32	10,32

METRIC COPPER TUBE FITTINGS

REFRIGERATION QUALITY

SYMBOLS USED FOR FITTING ENDS

- "C"** : Copper cup manufactured to receive copper tube diameter (as an ODS solder connection). The copper tube can be "slipped-in" any "C" fitting end.
- "FTG"** : Fitting ends made to copper tube diameter. Can be "slipped-in" any "C" fitting end.
- "FPT"** : Female National Pipe Thread (NPT) said **FPT**. ("N" had been dropped and replaced by "F" for female).
- "MPT"** : Male National Pipe Thread (NPT) said **MPT**. ("N" had been dropped and replaced by "M" for male).

NOTE

- All solder cups (**C**) and fitting ends (**FTG**) size description are expressed in outside diameter (**OD**) tube size.
- All National Pipe Threads (NPT) are expressed in standard female NPT (**FPT**) and male NPT (**MPT**).

Note: According to the PED Directive 97/23/EC all open ended copper tubes and fittings as supplied by ITE will be classified in the SEP (Sound Engineering Practices) category by reference to article 3 paragraph 3 of the PED. A CE mark cannot be applied to these tubes and fittings, because all appropriate manufacturing operations such as bending, connection (soldering) and heat treatment have not been completed, as they will be completed in the field, during installation process, to render them fit for their intended purpose.

NORMS

- Real A/C & R COPPER FITTINGS
- Strictly conform to BS 864 Part 2
- Strictly conform to DIN 2856

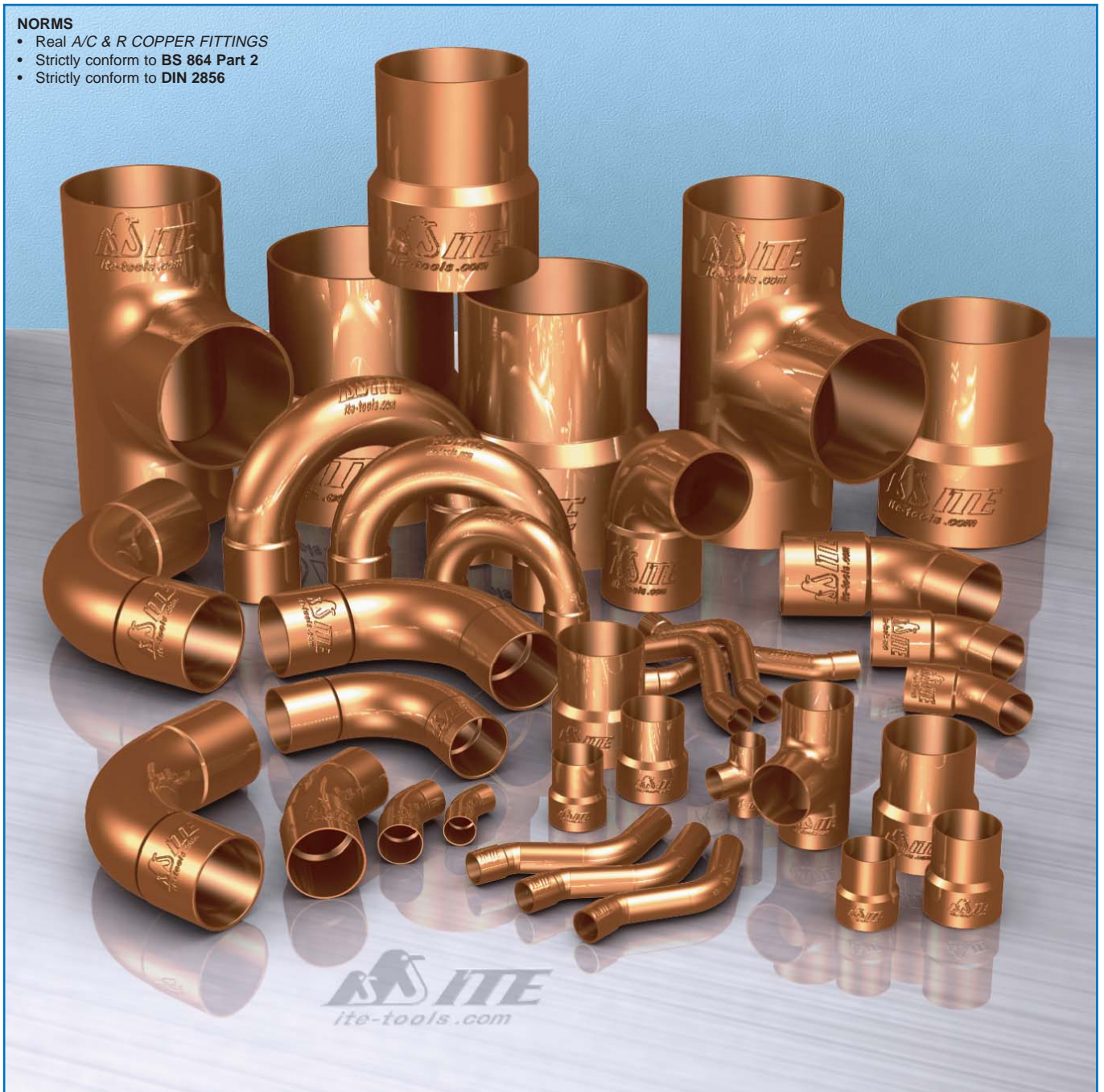

LONG 90° RADIUS STREET ELBOW

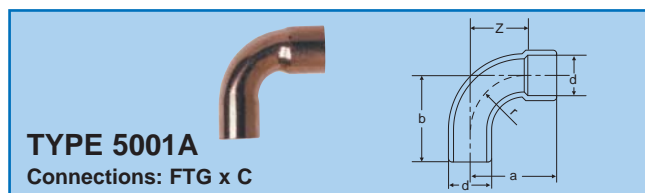

Cat. No.	Connections	Dimensions (mm)			
	d	a	b	r	Z
5001A-06	06 mm	14	16	7	7
5001A-08	08 mm	18	20	10	10
5001A-10	10 mm	21	23	12	12
5001A-12	12 mm	24	26	15	15
5001A-14	14 mm	30	32	18	18
5001A-15	15 mm	30	32	18	18
5001A-16	16 mm	30	31	17	17
5001A-18	18 mm	36	38	22	22
5001A-22	22 mm	43	45	27	27
5001A-28	28 mm	53	55	34	34
5001A-35	35 mm	67	69	43	43
5001A-42	42 mm	79	81	51	51
5001A-54	54 mm	99	101	65	65
5001A-64	64 mm	112	115	78	78
5001A-67	67 mm	116	119	81	81
5001A-70	70 mm	120	123	85	85
5001A-76	76 mm	127	130	92	92
5001A-80	80 mm	134	137	121	121
5001A-89	89 mm	147	150	108	108
5001A-108	108 mm	179	182	131	131
5001A-133	133 mm	212	217	177	177

45° STREET ELBOW



Cat. No.	Connections	Dimensions (mm)		
	d	a	b	Z
5040-06	06 mm	9	11	3
5040-08	08 mm	11	13	4
5040-10	10 mm	12	14	4
5040-12	12 mm	14	16	5
5040-14	14 mm	16,5	16,5	5,5
5040-15	15 mm	17	19	6
5040-16	16 mm	18	20	7
5040-18	18 mm	20	22	7
5040-22	22 mm	25	27	9
5040-28	28 mm	29	31	10
5040-35	35 mm	37	39	14
5040-42	42 mm	42	44	15
5040-54	54 mm	52	54	20
5040-64	64 mm	62	65	27
5040-67	67 mm	65	68	28,5
5040-76	76 mm	68	71	32
5040-80	80 mm	83	85	48
5040-89	89 mm	78	81	37,5
5040-108	108 mm	110	113	60
5040-133	133 mm	280	280	235

LONG 90° RADIUS ELBOW



Cat. No.	Connections	Dimensions (mm)		
	d	a	r	Z
5002A-06	06 mm	13	7,2	7,2
5002A-08	08 mm	16,5	9,6	9,6
5002A-10	10 mm	20	12	12
5002A-12	12 mm	23	14,4	14,4
5002A-14	14 mm	29	18	18
5002A-15	15 mm	29	18	18
5002A-16	16 mm	29	18	18
5002A-18	18 mm	34,5	21,6	21,6
5002A-22	22 mm	42	26,4	26,4
5002A-28	28 mm	52	33,6	33,6
5002A-35	35 mm	65	42	42
5002A-42	42 mm	77,5	50,4	50,4
5002A-54	54 mm	97	64,8	64,8
5002A-64	64 mm	109,5	76,8	76,8
5002A-67	67 mm	117	84	84
5002A-70	70 mm	138	105	105
5002A-76	76 mm	125	91,3	91,3
5002A-80	80 mm	153	120	120
5002A-89	89 mm	144,5	106,7	106,7
5002A-108	108 mm	177	129,6	129,6
5002A-133	133 mm	212	177	177
5002A-159	159 mm	262	227	227

45° ELBOW



Cat. No.	Connections	Dimensions (mm)		
	d	d	a	Z
5041-06	06 mm	6	9	3
5041-08	08 mm	8	11	4
5041-10	10 mm	10	12	4
5041-12	12 mm	12	14	5
5041-14	14 mm	14	16,5	5,5
5041-15	15 mm	15	17	6
5041-16	16 mm	16	18	7
5041-18	18 mm	18	20	7
5041-22	22 mm	22	25	9
5041-28	28 mm	28	29	10
5041-35	35 mm	35	37	14
5041-42	42 mm	42	42	15
5041-54	54 mm	54	52	20
5041-64	64 mm	64	62	27
5041-67	67 mm	67	65	28,5
5041-76	76 mm	76	68	32
5041-80	80 mm	80	83	48
5041-89	89 mm	89	78	37,5
5041-108	108 mm	108	110	60
5041-133	133 mm	133	280	235
5041-159	159 mm	159	335	290

RETURN BEND

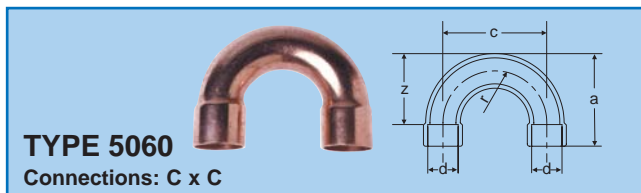

Cat. No.	Connections		Dimensions (mm)			
	d	a	c	r	z	
5060-08	08 mm	20	24	12	12	
5060-12	12 mm	28	36	18	17	
5060-14	14 mm	33,5	45	22,5	22,5	
5060-15	15 mm	34,5	45	22,5	22,5	
5060-16	16 mm	37	48	24	24	
5060-18	18 mm	41	54	27	27	
5060-22	22 mm	48	66	33	31	
5060-28	28 mm	60	84	42	40	
5060-35	35 mm	95	140	70	70	
5060-42	42 mm	112	168	84	83	
5060-54	54 mm	140	216	108	106	

CROSSOVER COUPLINGS

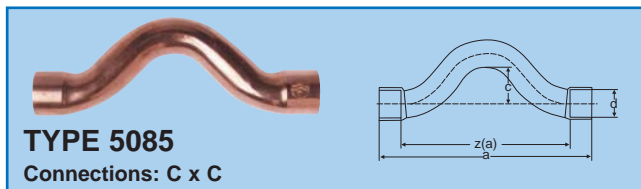

Cat. No.	Connections		Dimensions (mm)		
	d	a	c	z(a)	
5085-12	12 mm	100	20	82	
5085-14	14 mm	112	20	90	
5085-15	15 mm	113	20	91	
5085-16	16 mm	113	20	91	
5085-18	18 mm	122	20	96	
5085-22	22 mm	145	23	113	

90° RADIUS ELBOW

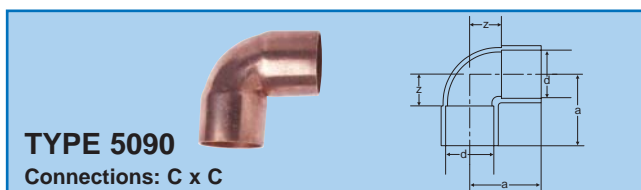

Cat. No.	Connections		Dimensions (mm)			
	d	a	z	b	z(a)	z(b)
5090-06	06 mm	13	7,2			
5090-08	08 mm	12,5	5,5			
5090-10	10 mm	15	7			
5090-12	12 mm	16,5	7,5			
5090-14	14 mm	19,5	8,5			
5090-15	15 mm	22	11			
5090-16	16 mm	24	13			
5090-18	18 mm	25,5	12,5			
5090-22	22 mm	30	14			
5090-28	28 mm	36,5	17,5			
5090-35	35 mm	46	23			
5090-42	42 mm	55	28			
5090-54	54 mm	70	38			
5090-64	64 mm	83,5	51			
5090-76	76 mm	91,5	58			
5090-89	89 mm	105	67,5			
5090-108	108 mm	127	79,5			
5090-15-12	15-12 mm	22		24,5	10	12,5
5090-18-15	18-15 mm	25		25	11	15
5090-22-15	22-15 mm	32		33	15	21
5090-22-18	22-18 mm	32		34	15	20

CROSSOVER STREET COUPLINGS

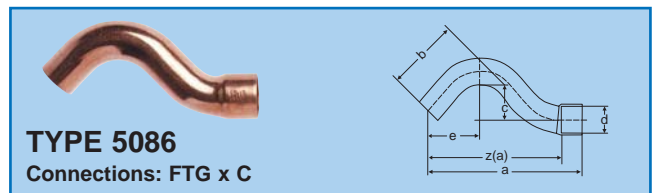

Cat. No.	Connections		Dimensions (mm)				
	d	a	b	c	e	z(a)	
5086-12	12 mm	86	43	20	36	76	
5086-14	14 mm	94	46	20	37	83	
5086-15	15 mm	93	43	20	36	81	
5086-16	16 mm	94	46	20	37	83	
5086-18	18 mm	101	47	20	40	88	
5086-22	22 mm	122	54	23	49	106	

SHORT 90° RADIUS STREET ELBOW

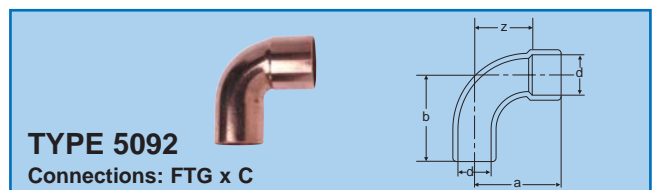

Cat. No.	Connections		Dimensions (mm)		
	d	a	z		
5092-06	06 mm	14	16	7,2	
5092-08	08 mm	12,5	15,5	5,5	
5092-10	10 mm	19	22	10	
5092-12	12 mm	17	20	8	
5092-14	14 mm	20,5	23	9,5	
5092-15	15 mm	23	25	11	
5092-16	16 mm	25	28,5	13	
5092-18	18 mm	26,5	27	12,5	
5092-22	22 mm	31	33	14	
5092-28	28 mm	37,5	39,5	17,5	
5092-35	35 mm	47	54	24	
5092-42	42 mm	56	66	29	
5092-54	54 mm	71	82	39	

TEES

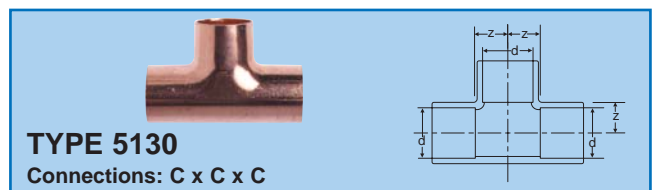

Cat. No.	Connections		Dimensions (mm)	
	d	a	z	
5130-06	06 mm	10	4	
5130-08	08 mm	12	5	
5130-10	10 mm	14	6	
5130-12	12 mm	16	7	
5130-14	14 mm	19	8	
5130-15	15 mm	19	8	
5130-16	16 mm	20	9	
5130-18	18 mm	23	10	
5130-22	22 mm	28	12	
5130-28	28 mm	34	15	
5130-35	35 mm	42	19	
5130-42	42 mm	50	23	
5130-54	54 mm	61	29	
5130-64	64 mm	73	40	
5130-67	67 mm	72	38	
5130-76	76 mm	80	46	
5130-89	89 mm	92	54	
5130-108	108 mm	112	64	
5130-133	133 mm	135	85	
5130-159	159 mm	160	100	

REDUCING TEES

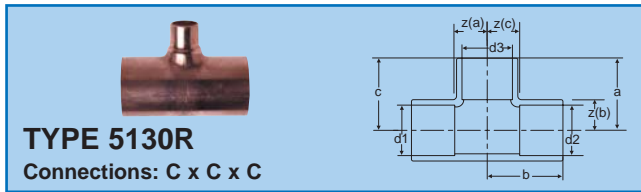

Cat. No.	Connections d1-d2-d3	Dimensions (mm)					
		a	b	c	z(a)	z(b)	z(c)
5130R-06-08B-06	06-08-06	13	12	13	7	5	7
5130R-06-10B-06	06-10-06	14	14	14	8	6	8
5130R-08-06B-06	08-06-06	12	11	12	5	5	6
5130R-08-06B-08	08-06-08	12	11	12	5	5	5
5130R-08-10B-08	08-10-08	15	14	15	8	6	8
5130R-10-06B-10	10-06-10	14	12	14	6	6	6
5130R-10-08B-08	10-08-08	14	13	14	6	6	7
5130R-10-08B-10	10-08-10	14	13	14	6	6	6
5130R-10-10B-08	10-10-08	14	14	15	6	6	8
5130R-10-12B-10	10-12-10	16,5	16	16,5	8,5	7	8,5
5130R-10-15B-10	10-15-10	19	18,5	19	11	7,5	11
5130R-12-06B-12	12-06-12	15	14,5	15	6	8,5	6
5130R-12-08B-12	12-08-12	15	14	15	6	7	6
5130R-12-10B-10	12-10-10	15	15	16,5	6	7	8,5
5130R-12-10B-12	12-10-12	15	15	15	6	7	6
5130R-12-12B-10	12-12-10	16	16	17,5	7	7	9
5130R-12-14B-12	12-14-12	19	19	19	10	8	10
5130R-12-15B-12	12-15-12	19,5	19	19,5	10,5	8	10,5
5130R-12-16B-12	12-16-12	20	19,5	20	11	8,5	11
5130R-12-18B-12	12-18-12	23	23	23	14	10	14
5130R-12-22B-12	12-22-12	27	28	27	18	12	18
5130R-14-10B-14	14-10-14	17	16	17	6	8	6
5130R-14-12B-12	14-12-12	18	17	18	7	8	9
5130R-14-12B-14	14-12-14	18	17	18	7	8	7
5130R-14-14B-12	14-14-12	19	19	20	8	8	10
5130R-14-16B-12	14-16-12	21	19,5	20	10	8,5	11
5130R-14-16B-14	14-16-14	21,5	19,5	21,5	10,5	8,5	10,5
5130R-14-18B-14	14-18-14	23,5	23	23,5	12,5	10	12,5
5130R-14-22B-14	14-22-14	27,5	27	27,5	16,5	11	16,5
5130R-15-06B-15	15-06-15	16	16,5	16	5	10,5	5
5130R-15-08B-15	15-08-15	16	16	16	5	9	5
5130R-15-10B-10	15-10-10	17	16,5	17	6	8,5	9
5130R-15-10B-12	15-10-12	17	16,5	18	6	8,5	9
5130R-15-10B-15	15-10-15	17	17	17	6	9	6
5130R-15-12B-10	15-12-10	18	18	19	7	9	11
5130R-15-12B-12	15-12-12	18	18	18	7	9	9
5130R-15-12B-15	15-12-15	18	18	18	7	9	7
5130R-15-15B-10	15-15-10	19	19	19	8	8	11
5130R-15-15B-12	15-15-12	19	19	19	8	8	10
5130R-15-18B-15	15-18-15	23	23	23	12	10	12
5130R-15-22B-15	15-22-15	27	28	27	16	12	16
5130R-15-28B-15	15-28-15	33	34	33	22	15	22
5130R-16-06B-16	16-06-16	16,5	15,5	16,5	5,5	9,5	5,5
5130R-16-10B-16	16-10-16	17	17	17	6	9	6
5130R-16-12B-12	16-12-12	18	18	18	7	9	9
5130R-16-12B-14	16-12-14	18	18	20,5	7	9	9,5
5130R-16-12B-16	16-12-16	18	18	18	7	9	7
5130R-16-14B-12	16-14-12	19	20	19	8	9	10
5130R-16-14B-14	16-14-14	19	20	20	8	9	9
5130R-16-14B-16	16-14-16	19	20	19	8	9	8
5130R-16-16B-12	16-16-12	20	20	20	9	9	11
5130R-16-16B-14	16-16-14	20	20	21	9	9	10
5130R-16-18B-14	16-18-14	22,5	23	23	11,5	10	12
5130R-16-18B-16	16-18-16	22,5	23	22,5	11,5	10	11,5
5130R-16-22B-16	16-22-16	26,5	28	26,5	15,5	12	15,5
5130R-18-06B-18	18-06-18	20	17	20	7	11	7
5130R-18-10B-18	18-10-18	20,5	18	20,5	7,5	10	7,5
5130R-18-12B-12	18-12-12	20	19	19,5	7	10	10,5
5130R-18-12B-14	18-12-14	20	19	20	7	10	9
5130R-18-12B-15	18-12-15	20	19	20	7	10	9
5130R-18-12B-16	18-12-16	20	19	19,5	7	10	8,5
5130R-18-12B-18	18-12-18	21	19	21	8	10	8
5130R-18-14B-12	18-14-12	21	21	20	8	10	11

REDUCING TEES (CONTINUED)

Cat. No.	Connections d1-d2-d3	Dimensions (mm)					
		a	b	c	z(a)	z(b)	z(c)
5130R-18-14B-14	18-14-14	21	21	21	8	10	10
5130R-18-14B-16	18-14-16	21	21	21	8	10	10
5130R-18-14B-18	18-14-18	21	21	21	8	10	8
5130R-18-15B-12	18-15-12	22	21	20	9	10	11
5130R-18-15B-15	18-15-15	22	21	22	9	10	11
5130R-18-15B-18	18-15-18	21	21	21	8	10	8
5130R-18-16B-14	18-16-14	22	21	22	9	10	11
5130R-18-16B-16	18-16-16	22	21	22	9	10	11
5130R-18-16B-18	18-16-18	22	21	22	9	10	9
5130R-18-18B-10	18-18-10	23	23	22	10	10	14
5130R-18-18B-12	18-18-12	23	23	21	10	10	13
5130R-18-18B-14	18-18-14	23	23	23	10	10	12
5130R-18-18B-15	18-18-15	23	23	23	10	10	12
5130R-18-18B-16	18-18-16	23	23	23	10	10	12
5130R-18-22B-15	18-22-15	27,5	28	27	14,5	12	16
5130R-18-22B-18	18-22-18	27,5	28	27,5	14,5	12	14,5
5130R-18-28B-18	18-28-18	33,5	34	33,5	20,5	15	20,5
5130R-22-06B-22	22-06-22	23	21	23	7	15	7
5130R-22-10B-22	22-10-22	23	21	23	7	13	7
5130R-22-12B-12	22-12-12	23	21	21	7	12	12
5130R-22-12B-14	22-12-14	23	21	22	7	12	11
5130R-22-12B-15	22-12-15	23	21	22	7	12	11
5130R-22-12B-18	22-12-18	23	21	23	7	12	10
5130R-22-12B-22	22-12-22	23	21	23	7	12	7
5130R-22-14B-14	22-14-14	24	23	23	8	12	12
5130R-22-14B-16	22-14-16	24	23	23	8	12	12
5130R-22-14B-18	22-14-18	24	23	24	8	12	11
5130R-22-14B-22	22-14-22	24	23	24	8	12	8
5130R-22-15B-12	22-15-12	25	23	22,5	9	12	13,5
5130R-22-15B-15	22-15-15	25	23	24	9	12	13
5130R-22-15B-18	22-15-18	25	24	25	9	12	12
5130R-22-15B-22	22-15-22	25	23	25	9	12	9
5130R-22-16B-16	22-16-16	25	23	23,5	9	12	12,5
5130R-22-16B-18	22-16-18	25	23	24	9	12	11
5130R-22-16B-22	22-16-22	25	23	25	9	12	9
5130R-22-18B-12	22-18-12	26	25	24	10	12	15
5130R-22-18B-14	22-18-14	26	25	25	10	12	14
5130R-22-18B-15	22-18-15	26	25	25	10	12	14
5130R-22-18B-16	22-18-16	26	25	25	10	12	14
5130R-22-18B-18	22-18-18	27	25	26	11	12	13
5130R-22-18B-22	22-18-22	27	25	27	11	12	11
5130R-22-22B-12	22-22-12	28	28	26	12	12	17
5130R-22-22B-14	22-22-14	28	28	27	12	12	16
5130R-22-22B-15	22-22-15	28	28	27	12	12	16
5130R-22-22B-16	22-22-16	28	28	26,5	12	12	15,5
5130R-22-22B-18	22-22-18	28	28	27	12	12	14
5130R-22-28B-15	22-28-15	35	34	33	19	15	22
5130R-22-28B-22	22-28-22	35	34	35	19	15	19
5130R-22-35B-22	22-35-22	43	42	43	27	19	27
5130R-28-10B-28	28-10-28	27	26	27	8	18	8
5130R-28-12B-28	28-12-28	26	24	26	7	15	7
5130R-28-14B-28	28-14-28	27	26	27	8	15	8
5130R-28-15B-15	28-15-15	28	26	26,5	9	15	15,5
5130R-28-15B-18	28-15-18	28	26	27	9	15	14
5130R-28-15B-22	28-15-22	28	26	28,5	9	15	12,5
5130R-28-15B-28	28-15-28	28	26	28	9	15	9
5130R-28-16B-16	28-16-16	28	26	32	9	15	21
5130R-28-16B-28	28-16-28	28	26	28	9	15	9
5130R-28-18B-15	28-18-15	29	28	28	10	15	17
5130R-28-18B-18	28-18-18	29	28	28,5	10	15	15,5
5130R-28-18B-22	28-18-22	29	28	30	10	15	14
5130R-28-18B-28	28-18-28	29	28	29	10	15	10
5130R-28-22B-15	28-22-15	31	31	30	12	15	19
5130R-28-22B-18	28-22-18	31	31	30,5	12	15	17,5
5130R-28-22B-22	28-22-22	31	31	32	12	15	16
5130R-28-22B-28	28-22-28	31	31	31	12	15	12
5130R-28-28B-12	28-28-12	34	34	33	15	15	24
5130R-28-28B-15	28-28-15	34	34	33	15	15	22
5130R-28-28B-16	28-28-16	34	34	34	15	15	23
5130R-28-28B-18	28-28-18	34	34	33,5	15	15	20,5
5130R-28-28B-22	28-28-22	34	34	35	15	15	19

REDUCING TEES (CONTINUED)

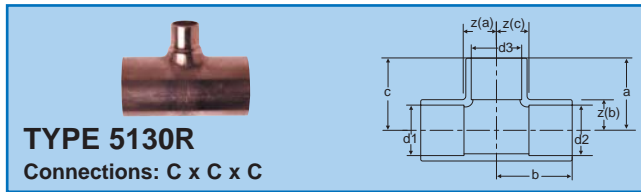

Cat. No.	Connections d1-d2-d3	a	b	c	Dimensions (mm) z(a) z(b) z(c)		
5130R-28-35B-28	28-35-28	43,5	42	43,5	24,5	19	24,5
5130R-35-15B-28	35-15-28	32,5	30	34	9,5	19	15
5130R-35-15B-35	35-15-35	32,5	30	32,5	9,5	19	9,5
5130R-35-18B-28	35-18-28	34	32	35	11	19	16
5130R-35-18B-35	35-18-35	34	32	34	11	19	11
5130R-35-22B-22	35-22-22	36	35	37,5	13	19	21,5
5130R-35-22B-28	35-22-28	36	35	37	13	19	18
5130R-35-22B-35	35-22-35	36	35	36	13	19	13
5130R-35-28B-22	35-28-22	38	38	40	15	19	24
5130R-35-28B-28	35-28-28	38	38	40	15	19	21
5130R-35-28B-35	35-28-35	38	38	38	15	19	15
5130R-35-35B-15	35-35-15	42	41	42	19	18	31
5130R-35-35B-18	35-35-18	42	41	42	19	18	29
5130R-35-35B-22	35-35-22	42	42	42,5	19	19	26,5
5130R-35-35B-28	35-35-28	42	42	42,5	19	19	23,5
5130R-35-42B-35	35-42-35	49,5	50	49,5	26,5	23	26,5
5130R-42-15B-42	42-15-42	36,5	34	36,5	9,5	23	9,5
5130R-42-18B-42	42-18-42	38	36	38	11	23	11
5130R-42-22B-35	42-22-35	40,5	39	40,5	13,5	23	17,5
5130R-42-22B-42	42-22-42	40	39	40	13	23	13
5130R-42-28B-28	42-28-28	42,5	42	43	15,5	23	24
5130R-42-28B-35	42-28-35	42,5	42	44	15,5	23	19
5130R-42-28B-42	42-28-42	43	42	43	16	23	16
5130R-42-35B-28	42-35-28	46	46	46	19	23	27
5130R-42-35B-35	42-35-35	46	46	46,5	19	23	23,5
5130R-42-35B-42	42-35-42	46,5	46	46,5	19,5	23	19,5
5130R-42-42B-22	42-42-22	50	50	49	23	23	33
5130R-42-42B-28	42-42-28	50	50	50	23	23	31
5130R-42-42B-35	42-42-35	50	50	50	23	23	27
5130R-42-54B-42	42-54-42	62	61	62	35	29	35
5130R-54-15B-54	54-15-54	41,5	40	41,5	9,5	29	9,5
5130R-54-18B-54	54-18-54	43	42	43	11	29	11
5130R-54-22B-42	54-22-42	46	45	47	14	29	20
5130R-54-22B-54	54-22-54	45	45	45	13	29	13
5130R-54-28B-42	54-28-42	49	48	49,5	17	29	22,5
5130R-54-28B-54	54-28-54	48	48	48	16	29	16
5130R-54-35B-35	54-35-35	52	52	51	20	29	28
5130R-54-35B-42	54-35-42	51	52	53	19	29	26
5130R-54-35B-54	54-35-54	51,5	52	51,5	19,5	29	19,5
5130R-54-42B-42	54-42-42	55	56	56,5	23	29	29,5
5130R-54-42B-54	54-42-54	55	56	55	23	29	23
5130R-54-54B-42	54-54-42	61	61	62	29	29	35
5130R-64-35B-64	64-35-64	58,5	64	58,5	25,5	40	25,5
5130R-64-42B-64	64-42-64	62	68	62	29	40	29
5130R-64-54B-64	64-54-64	67	70	67	34	37	34
5130R-76-35B-76	76-35-76	59,5	70	59,5	25,5	46	25,5
5130R-76-42B-76	76-42-76	63	74	63	29	46	29
5130R-76-54B-76	76-54-76	69	79	69	35	46	35
5130R-76-64B-76	76-64-76	74	79	74	40	46	40
5130R-89-35B-89	89-35-89	61,5	74,5	61,5	23,5	50,5	23,5
5130R-89-42B-89	89-42-89	68,5	82	68,5	30,5	54	30,5
5130R-89-54B-89	89-54-89	74,5	87	74,5	36,5	54	36,5
5130R-89-64B-89	89-64-89	79,5	87	79,5	41,5	54	41,5
5130R-89-76B-89	89-76-89	85,5	88	85,5	47,5	54	47,5
5130R-108-54B-108	108-54-108	85	97	85	37	64	37
5130R-108-64B-108	108-64-108	90	97	90	42	64	42
5130R-108-76B-108	108-76-108	96	98	96	48	64	48
5130R-108-89B-108	108-89-108	102,5	102	102,5	54,5	64	54,5
5130R-133-108B-133	133-108-133	139	142	139	89	94,5	89

REDUCING COUPLING

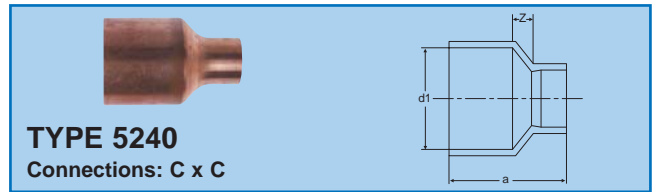

Cat. No.	Connections d1-d2	Dimensions (mm) a Z	
5240-08-06	08-06 mm	15	2
5240-10-06	10-06 mm	17	3
5240-10-08	10-08 mm	17	2,5
5240-12-06	12-06 mm	19	4
5240-12-08	12-08 mm	19	3
5240-12-10	12-10 mm	20	3
5240-14-10	14-10 mm	23	4
5240-14-12	14-12 mm	22	2,5
5240-15-08	15-08 mm	23	5
5240-15-10	15-10 mm	23	4
5240-15-12	15-12 mm	23	3
5240-15-14	15-14 mm	24	2,5
5240-16-10	16-10 mm	24	5
5240-16-12	16-12 mm	25	4,5
5240-16-14	16-14 mm	25	3
5240-16-15	16-15 mm	23	1
5240-18-10	18-10 mm	26	5
5240-18-12	18-12 mm	27	5
5240-18-14	18-14 mm	27	3,5
5240-18-15	18-15 mm	27	3
5240-18-16	18-16 mm	27	3
5240-22-10	22-10 mm	32	8
5240-22-12	22-12 mm	32	7
5240-22-14	22-14 mm	33	6
5240-22-15	22-15 mm	32	5
5240-22-16	22-16 mm	32	5
5240-22-18	22-18 mm	31	3
5240-28-12	28-12 mm	39	11
5240-28-14	28-14 mm	39	9
5240-28-15	28-15 mm	39	9
5240-28-16	28-16 mm	38	8
5240-28-18	28-18 mm	38	7
5240-28-22	28-22 mm	39	5
5240-35-15	35-15 mm	46	12
5240-35-18	35-18 mm	46	10
5240-35-22	35-22 mm	47	8,5
5240-35-28	35-28 mm	47	5
5240-42-18	42-18 mm	54	14
5240-42-22	42-22 mm	56	13
5240-42-28	42-28 mm	56	10
5240-42-35	42-35 mm	56	6
5240-54-22	54-22 mm	69	21
5240-54-28	54-28 mm	69	18
5240-54-35	54-35 mm	68	13
5240-54-42	54-42 mm	70	11
5240-64-35	64-35 mm	75	15
5240-64-42	64-42 mm	77	13
5240-64-54	64-54 mm	75	10
5240-67-54	67-54 mm	85	16
5240-70-54	70-54 mm	81	11
5240-70-64	70-64 mm	82	11
5240-76-54	76-54 mm	81	11
5240-76-64	76-64 mm	77	11
5240-76-70	76-70 mm	83	11
5240-80-54	80-54 mm	81	11
5240-80-64	80-64 mm	82	11
5240-80-70	80-70 mm	83	11
5240-80-76	80-76 mm	83	11
5240-89-76	89-76 mm	83	12
5240-108-89	108-89 mm	100	15
5240-133-76	133-76 mm	110	41
5240-133-108	133-108 mm	106	23
5240-159-108	159-108 mm	130	47
5240-159-133	159-133 mm	119	49

FITTING REDUCER

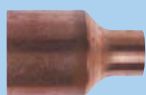

TYPE 5243

Connections: FTG x C

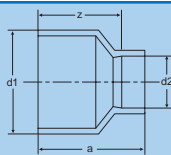

Cat. No.	Connections d1-d2	Dimensions (mm)	
		a	z
5243-08-06	08-06 mm	16	10
5243-10-06	10-06 mm	18	12
5243-10-08	10-08 mm	17,5	10
5243-12-06	12-06 mm	21	15
5243-12-08	12-08 mm	20	13
5243-12-10	12-10 mm	19,5	11,5
5243-14-10	14-10 mm	22	14
5243-14-12	14-12 mm	22	13
5243-15-08	15-08 mm	24	17
5243-15-10	15-10 mm	24	16
5243-15-12	15-12 mm	24	15
5243-15-14	15-14 mm	25	14
5243-16-10	16-10 mm	25	17
5243-16-12	16-12 mm	25	16
5243-16-14	16-14 mm	26	15
5243-16-15	16-15 mm	25	14
5243-18-10	18-10 mm	27	19
5243-18-12	18-12 mm	27	18
5243-18-14	18-14 mm	29	18
5243-18-15	18-15 mm	29	18
5243-18-16	18-16 mm	28	17
5243-22-10	22-10 mm	33	25
5243-22-12	22-12 mm	33	24
5243-22-14	22-14 mm	34	23
5243-22-15	22-15 mm	34	23
5243-22-16	22-16 mm	33,5	22,5
5243-22-18	22-18 mm	35	22
5243-28-12	28-12 mm	41	32
5243-28-14	28-14 mm	42	31
5243-28-15	28-15 mm	39	28
5243-28-16	28-16 mm	40	29
5243-28-18	28-18 mm	39	26
5243-28-22	28-22 mm	42	26
5243-35-15	35-15 mm	50	38
5243-35-18	35-18 mm	47	34
5243-35-22	35-22 mm	48	32
5243-35-28	35-28 mm	49	30
5243-42-15	42-15 mm	59,5	47,5
5243-42-18	42-18 mm	57	44
5243-42-22	42-22 mm	56	40
5243-42-28	42-28 mm	56	37
5243-42-35	42-35 mm	57	34
5243-54-22	54-22 mm	68	52
5243-54-28	54-28 mm	67	48
5243-54-35	54-35 mm	68	45
5243-54-42	54-42 mm	69	42
5243-64-35	64-35 mm	71	46
5243-64-42	64-42 mm	75	46
5243-64-54	64-54 mm	75	43
5243-67-35	67-35 mm	79	56
5243-67-42	67-42 mm	88	58
5243-67-54	67-54 mm	80	48
5243-70-54	70-54 mm	77	43
5243-70-64	70-64 mm	79	44
5243-76-35	76-35 mm	88	65
5243-76-42	76-42 mm	86	59
5243-76-54	76-54 mm	82	50
5243-76-64	76-64 mm	77	44
5243-76-70	76-70 mm	80	44
5243-80-54	80-54 mm	84	50
5243-80-64	80-64 mm	79	44
5243-80-67	80-67 mm	78,5	42,5
5243-89-76	89-76 mm	84	50
5243-108-54	108-54 mm	116	84
5243-108-64	108-64 mm	110	78
5243-108-76	108-76 mm	120	86
5243-108-89	108-89 mm	100	62
5243-133-76	133-76 mm	122	89
5243-133-89	133-89 mm	108	71
5243-133-108	133-108 mm	105	58
5243-159-108	159-108 mm	159	112
5243-159-133	159-133 mm	160	125

COUPLING - ROLLED STOP

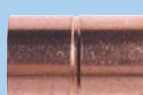

TYPE 5270

Connections: C x C

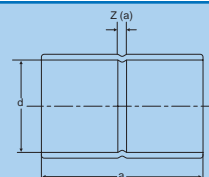

Cat. No.	Connections d	Dimensions (mm)	
		a	Z (a)
5270-06	06 mm	14	1
5270-08	08 mm	16	1
5270-10	10 mm	18	1
5270-12	12 mm	20	1,5
5270-14	14 mm	24	1,5
5270-15	15 mm	24	1,5
5270-16	16 mm	24	1,5
5270-18	18 mm	28	1,5
5270-22	22 mm	33	1,5
5270-28	28 mm	39	1,5
5270-35	35 mm	48	1,5
5270-42	42 mm	58	2
5270-54	54 mm	68	2
5270-64	64 mm	67	2
5270-67	67 mm	69	2
5270-70	70 mm	67	2
5270-76	76 mm	69	2
5270-80	80 mm	72	2
5270-89	89 mm	77	2
5270-108	108 mm	97	2
5270-133	133 mm	82	12
5270-159	159 mm	82	12

COUPLING - NO STOP



TYPE 5270S

Connections: C x C

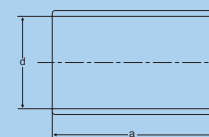

Cat. No.	Connections d	Dimensions (mm)	
		a	
5270S-12	12 mm	20	
5270S-15	15 mm	24	
5270S-18	18 mm	28	
5270S-22	22 mm	33	
5270S-28	28 mm	38	
5270S-35	35 mm	48,5	
5270S-42	42 mm	58	
5270S-54	54 mm	68	

CAP



TYPE 5301

Connections: C

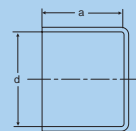

Cat. No.	Connections d	Dimensions (mm)	
		a	
5301-10	10 mm	9	
5301-12	12 mm	10	
5301-14	14 mm	11	
5301-15	15 mm	12	
5301-16	16 mm	13	
5301-18	18 mm	14	
5301-22	22 mm	17	
5301-28	28 mm	20	
5301-35	35 mm	25	
5301-42	42 mm	29	
5301-54	54 mm	34	
5301-64	64 mm	35	
5301-67	67 mm	35	
5301-76	76 mm	36	
5301-89	89 mm	40	
5301-108	108 mm	50	

Part. nr.	Pdf file
2001-VG	see Service manifolds, gauges and charging hoses
2001-VG	see Service manifolds, gauges and charging hoses
203-FA	see Tube working tools
2041-BT-2	see Fluid control components
2041-BT-2	see Fluid control components
2041-BT-2S2	see Fluid control components
2041-BT-2S2	see Fluid control components
2041-BT-3	see Fluid control components
2041-BT-3	see Fluid control components
2041-BT-3S3	see Fluid control components
2041-BT-3S3	see Fluid control components
2041-BT-4	see Fluid control components
2041-BT-4	see Fluid control components
2041-BT-4S4	see Fluid control components
2041-BT-4S4	see Fluid control components
2041-BT-4S5	see Fluid control components
2041-BT-4S5	see Fluid control components
2041-BT-5	see Fluid control components
2041-BT-5	see Fluid control components
2041-BT-5S5	see Fluid control components
2041-BT-5S5	see Fluid control components
2041-BT-5S6	see Fluid control components
2041-BT-5S6	see Fluid control components
2041-BT-5S7	see Fluid control components
2041-BT-5S7	see Fluid control components
205-P06	see Evacuating and charging equipment
205-P06	see Refrigeration accessories
205-P1	see Evacuating and charging equipment
205-P1	see Refrigeration accessories
205-P4	see Evacuating and charging equipment
205-P4	see Refrigeration accessories
206-FB	see Tube working tools
20-A	see Automatic access valves & fittings
21702-0	see Evacuating and charging equipment
21751	see Evacuating and charging equipment
227-FA	see Tube working tools
2444-RC	see Refrigeration accessories
25563	see Electronic measurement and control instruments
25860	see Refrigeration accessories
25863	see Refrigeration accessories
25869	see Refrigeration accessories
25870	see Refrigeration accessories
260-FHA	see Tube working tools
268	see Electronic measurement and control instruments
26880	see Tube working tools
26-C	see Automatic access valves & fittings
270-F-06	see Tube working tools
270-F-08	see Tube working tools
270-F-10	see Tube working tools
270-F-12	see Tube working tools
270-F-14	see Tube working tools
270-F-16	see Tube working tools
270-F-18	see Tube working tools
271-F	see Tube working tools
275-FS	see Tube working tools
275-FSC	see Tube working tools
275-FSM	see Tube working tools
27805	see Tube working tools
27806	see Tube working tools
27806M	see Tube working tools
27808	see Tube working tools
27808M	see Tube working tools
27810	see Tube working tools
27810M	see Tube working tools
27812	see Tube working tools
27812M	see Tube working tools
27814M	see Tube working tools
27816M	see Tube working tools
27818M	see Tube working tools
27820M	see Tube working tools
27-C	see Automatic access valves & fittings
2802-BC	see Service manifolds, gauges and charging hoses
2802-BC	see Service manifolds, gauges and charging hoses
2802-BC/247	see Service manifolds, gauges and charging hoses
2802-BC/247	see Service manifolds, gauges and charging hoses
2802-BC/4	see Service manifolds, gauges and charging hoses
2802-BC/447	see Service manifolds, gauges and charging hoses
2802-BPC	see Service manifolds, gauges and charging hoses
2802-BPC	see Service manifolds, gauges and charging hoses
2802-BPC/410	see Service manifolds, gauges and charging hoses
2802-BPC/410	see Service manifolds, gauges and charging hoses
2802-BPC/410/27	see Service manifolds, gauges and charging hoses
2802-BPC-1.0/410	see Service manifolds, gauges and charging hoses
2802-G-BC	see Service manifolds, gauges and charging hoses
2802-G-BC/247	see Service manifolds, gauges and charging hoses
2802-G-BC/4	see Service manifolds, gauges and charging hoses
2802-G-BC/447	see Service manifolds, gauges and charging hoses
2802-G-BPC	see Service manifolds, gauges and charging hoses
2804-BC	see Service manifolds, gauges and charging hoses
2804-BC/247	see Service manifolds, gauges and charging hoses
2804-BC/27	see Service manifolds, gauges and charging hoses
2804-BC/4	see Service manifolds, gauges and charging hoses
2804-BC/447	see Service manifolds, gauges and charging hoses
2804-BPC	see Service manifolds, gauges and charging hoses
2804-G-BC	see Service manifolds, gauges and charging hoses

[illegible]

[illegible]

- 3 -

[illegible]

[illegible]

[illegible]

[illegible]

- 7 -

Part. nr.	Pdf file
CRISTAL CLEAR	see Service manifolds, gauges and charging hoses
CRISTAL CLEAR	see Service manifolds, gauges and charging hoses
CRPEN	see Electronic measurement and control instruments
CRPENB	see Electronic measurement and control instruments
CRPENB	see Electronic measurement and control instruments
CRPENR	see Electronic measurement and control instruments
CRPENR	see Electronic measurement and control instruments
CRX-02	see Forged brass & steel fittings "NPT" & "NPT 45" SAE"
CRX-03	see Forged brass & steel fittings "NPT" & "NPT 45" SAE"
CRX-04	see Forged brass & steel fittings "NPT" & "NPT 45" SAE"
CRX-06	see Forged brass & steel fittings "NPT" & "NPT 45" SAE"
CRX-08	see Forged brass & steel fittings "NPT" & "NPT 45" SAE"
CRX-10	see Forged brass & steel fittings "NPT" & "NPT 45" SAE"
CRX-12	see Forged brass & steel fittings "NPT" & "NPT 45" SAE"
CRX-S-02	see Forged brass & steel fittings "NPT" & "NPT 45" SAE"
CRX-S-03	see Forged brass & steel fittings "NPT" & "NPT 45" SAE"
CRX-S-04	see Forged brass & steel fittings "NPT" & "NPT 45" SAE"
CRX-S-06	see Forged brass & steel fittings "NPT" & "NPT 45" SAE"
CRX-S-08	see Forged brass & steel fittings "NPT" & "NPT 45" SAE"
CRX-S-10	see Forged brass & steel fittings "NPT" & "NPT 45" SAE"
CRX-S-12	see Forged brass & steel fittings "NPT" & "NPT 45" SAE"
CRX-S-16	see Forged brass & steel fittings "NPT" & "NPT 45" SAE"
CRX-S-20	see Forged brass & steel fittings "NPT" & "NPT 45" SAE"
CRX-S-24	see Forged brass & steel fittings "NPT" & "NPT 45" SAE"
CSL-144-S	see Fluid control components
CSL-145-S	see Fluid control components
CSL-146-S	see Fluid control components
CSL-147-S	see Fluid control components
CSL-149-S	see Fluid control components
CST-080	see Electronic measurement and control instruments
CST-120	see Electronic measurement and control instruments
CT-34	see Service manifolds, gauges and charging hoses
CT-ACP	see Refrigeration accessories
CTP-1	see Tube working tools
CV-1G	see Automatic access valves & fittings
CV-2G	see Automatic access valves & fittings
CV-3G	see Automatic access valves & fittings
CW08-22	see Tube working tools
CW08-32	see Tube working tools
CW10-22	see Tube working tools
D02050	see Copper tubes, coils & solder fittings (Inch & Metric)
D03050	see Copper tubes, coils & solder fittings (Inch & Metric)
D04050	see Copper tubes, coils & solder fittings (Inch & Metric)
D05050	see Copper tubes, coils & solder fittings (Inch & Metric)
D06050	see Copper tubes, coils & solder fittings (Inch & Metric)
D08050	see Copper tubes, coils & solder fittings (Inch & Metric)
D-1 (WS-33)	see Refrigeration accessories
D10050	see Copper tubes, coils & solder fittings (Inch & Metric)
D12050	see Copper tubes, coils & solder fittings (Inch & Metric)
D14050	see Copper tubes, coils & solder fittings (Inch & Metric)
D18050	see Copper tubes, coils & solder fittings (Inch & Metric)
D22050	see Copper tubes, coils & solder fittings (Inch & Metric)
D26050	see Copper tubes, coils & solder fittings (Inch & Metric)
DB-009	see Refrigeration accessories
DB-061	see Refrigeration accessories
DB-152	see Refrigeration accessories
DB-157	see Refrigeration accessories
DB-162	see Refrigeration accessories
DC-5150	see Tube working tools
DETX	see Refrigeration accessories
DGT-1415C	see Electronic measurement and control instruments
DHC-06x09 mm	see Refrigeration accessories
DHC-06x09/1M	see Refrigeration accessories
DLC-040	see Electronic measurement and control instruments
DLC-040-E	see Electronic measurement and control instruments
DLC-052	see Electronic measurement and control instruments
DLC-060	see Electronic measurement and control instruments
DLC-080	see Electronic measurement and control instruments
DLC-080-E	see Electronic measurement and control instruments
DLC-120	see Electronic measurement and control instruments
DLC-120-E	see Electronic measurement and control instruments
DLC-160	see Electronic measurement and control instruments
DLC-160-E	see Electronic measurement and control instruments
DLC-200	see Electronic measurement and control instruments
DLC-240	see Electronic measurement and control instruments
DLC-240-E	see Electronic measurement and control instruments
DLC-320	see Electronic measurement and control instruments
DLC-360	see Electronic measurement and control instruments
DLC-400	see Electronic measurement and control instruments
DM-120C	see Electronic measurement and control instruments
DM-1676	see Fluid control components
DM-1677	see Fluid control components
DM-1678	see Fluid control components
DM-1679	see Fluid control components
DMF-S-02	see Forged brass & steel fittings "NPT" & "NPT 45" SAE"
DMF-S-03	see Forged brass & steel fittings "NPT" & "NPT 45" SAE"
DMF-S-04	see Forged brass & steel fittings "NPT" & "NPT 45" SAE"
DMF-S-06	see Forged brass & steel fittings "NPT" & "NPT 45" SAE"
DMF-S-08	see Forged brass & steel fittings "NPT" & "NPT 45" SAE"
DMF-S-10	see Forged brass & steel fittings "NPT" & "NPT 45" SAE"
DMF-S-12	see Forged brass & steel fittings "NPT" & "NPT 45" SAE"
DMF-S-16	see Forged brass & steel fittings "NPT" & "NPT 45" SAE"
DMF-S-20	see Forged brass & steel fittings "NPT" & "NPT 45" SAE"
DMF-S-24	see Forged brass & steel fittings "NPT" & "NPT 45" SAE"
DPS-300C	see Electronic measurement and control instruments

- 9 -

Part. nr.	Pdf file
HC-2341-1	see Electronic measurement and control instruments
HC-2341-150	see Electronic measurement and control instruments
HC-234-150	see Electronic measurement and control instruments
HC-2341-50	see Electronic measurement and control instruments
HC-234-50	see Electronic measurement and control instruments
HCT-212	see Tube working tools
HCT-B	see Tube working tools
HCTK-239	see Electronic measurement and control instruments
HCT-P	see Tube working tools
HCT-S	see Tube working tools
HDA-120-B	see Service manifolds, gauges and charging hoses
HDA-120-R	see Service manifolds, gauges and charging hoses
HDA-120-Y	see Service manifolds, gauges and charging hoses
HDA-36-B	see Service manifolds, gauges and charging hoses
HDA-36-R	see Service manifolds, gauges and charging hoses
HDA-36-R/410	see Service manifolds, gauges and charging hoses
HDA-36-Y	see Service manifolds, gauges and charging hoses
HDA-36-Y/410	see Service manifolds, gauges and charging hoses
HDA-60-B	see Service manifolds, gauges and charging hoses
HDA-60-R	see Service manifolds, gauges and charging hoses
HDA-60-R/410	see Service manifolds, gauges and charging hoses
HDA-60-Y	see Service manifolds, gauges and charging hoses
HDA-60-Y/410	see Service manifolds, gauges and charging hoses
HDA-72-B	see Service manifolds, gauges and charging hoses
HDA-72-R	see Service manifolds, gauges and charging hoses
HDA-72-Y	see Service manifolds, gauges and charging hoses
HDCS-36-B/410/V	see Service manifolds, gauges and charging hoses
HDCS-36-R/410/V	see Service manifolds, gauges and charging hoses
HDS-120-B/V	see Service manifolds, gauges and charging hoses
HDS-120-R/V	see Service manifolds, gauges and charging hoses
HDS-120-Y/V	see Service manifolds, gauges and charging hoses
HDS-12-B/V	see Service manifolds, gauges and charging hoses
HDS-12-R	see Service manifolds, gauges and charging hoses
HDS-12-R/V	see Service manifolds, gauges and charging hoses
HDS-12-Y	see Service manifolds, gauges and charging hoses
HDS-12-Y/V	see Service manifolds, gauges and charging hoses
HDS-36-B/V	see Service manifolds, gauges and charging hoses
HDS-36-R/V	see Service manifolds, gauges and charging hoses
HDS-36-R/V	see Service manifolds, gauges and charging hoses
HDS-36-Y/V	see Service manifolds, gauges and charging hoses
HDS-60-B/V	see Service manifolds, gauges and charging hoses
HDS-60-R/V	see Service manifolds, gauges and charging hoses
HDS-60-Y/V	see Evacuating and charging equipment
HDS-60-Y/V	see Evacuating and charging equipment
HDS-60-Y/V	see Service manifolds, gauges and charging hoses
HS56-12-B/V	see Service manifolds, gauges and charging hoses
HS56-12-R/V	see Service manifolds, gauges and charging hoses
HS56-12-Y/V	see Service manifolds, gauges and charging hoses
HS56-36-B	see Service manifolds, gauges and charging hoses
HS56-36-B/V	see Service manifolds, gauges and charging hoses
HS56-36-R	see Service manifolds, gauges and charging hoses
HS56-36-R/V	see Service manifolds, gauges and charging hoses
HS56-36-Y	see Service manifolds, gauges and charging hoses
HS56-36-Y/V	see Service manifolds, gauges and charging hoses
HS56-60-B	see Service manifolds, gauges and charging hoses
HS56-60-B/V	see Service manifolds, gauges and charging hoses
HS56-60-R	see Service manifolds, gauges and charging hoses
HS56-60-R/V	see Service manifolds, gauges and charging hoses
HS56-60-Y	see Service manifolds, gauges and charging hoses
HS56-60-Y/V	see Service manifolds, gauges and charging hoses
HS56-72-B	see Service manifolds, gauges and charging hoses
HS56-72-B/V	see Service manifolds, gauges and charging hoses
HS56-72-R	see Service manifolds, gauges and charging hoses
HS56-72-R/V	see Service manifolds, gauges and charging hoses
HS56-72-Y	see Service manifolds, gauges and charging hoses
HS56-72-Y/V	see Service manifolds, gauges and charging hoses
HDS-72-B/V	see Service manifolds, gauges and charging hoses
HDS-72-R/V	see Service manifolds, gauges and charging hoses
HDS-72-Y/V	see Service manifolds, gauges and charging hoses
HER-319	see Fluid control components
HNS4-04	see Forged brass & steel fittings "NPT" & "NPT 45" SAE"
HNS4-06	see Forged brass & steel fittings "NPT" & "NPT 45" SAE"
HNS4-08	see Forged brass & steel fittings "NPT" & "NPT 45" SAE"
HNS4-10	see Forged brass & steel fittings "NPT" & "NPT 45" SAE"
HNS4-12	see Forged brass & steel fittings "NPT" & "NPT 45" SAE"
HP-3700	see Fluid control components
HP-3701	see Fluid control components
HP-3702	see Fluid control components
HP-3703	see Fluid control components
HP-3704	see Fluid control components
HP-3706	see Fluid control components
HP-3738	see Fluid control components
HPBV-04P	see Fluid control components
HPBV-06MMP	see Fluid control components
HPBV-06P	see Fluid control components
HPBV-08P	see Fluid control components
HPBV-10MMP	see Fluid control components
HPBV-10P	see Fluid control components
HPBV-12MMP	see Fluid control components
HPBV-12P	see Fluid control components
HPBV-14P	see Fluid control components
HPBV-16MMP	see Fluid control components
HPBV-18P	see Fluid control components
HPBV-19MMP	see Fluid control components
HPBV-22MMP	see Fluid control components

Part. nr.	Pdf file
MF-1150C-048U	see Fluid control components
MF-1150C-230U	see Fluid control components
MF-1360C-110U	see Fluid control components
MF-1900C-024U	see Fluid control components
MF-4	see Evacuating and charging equipment
MF-4+LP-4	see Evacuating and charging equipment
MFF-S-02	see Forged brass & steel fittings "NPT" & "NPT 45" SAE
MFF-S-03	see Forged brass & steel fittings "NPT" & "NPT 45" SAE
MFF-S-04	see Forged brass & steel fittings "NPT" & "NPT 45" SAE
MFF-S-06	see Forged brass & steel fittings "NPT" & "NPT 45" SAE
MFF-S-08	see Forged brass & steel fittings "NPT" & "NPT 45" SAE
MFF-S-10	see Forged brass & steel fittings "NPT" & "NPT 45" SAE
MFF-S-12	see Forged brass & steel fittings "NPT" & "NPT 45" SAE
MFF-S-16	see Forged brass & steel fittings "NPT" & "NPT 45" SAE
MFF-S-20	see Forged brass & steel fittings "NPT" & "NPT 45" SAE
MFF-S-24	see Forged brass & steel fittings "NPT" & "NPT 45" SAE
MFF-S-32	see Forged brass & steel fittings "NPT" & "NPT 45" SAE
M-HDL-12-B	see Service manifolds, gauges and charging hoses
M-HDL-12-R	see Service manifolds, gauges and charging hoses
M-HDL-12-Y	see Service manifolds, gauges and charging hoses
M-HDL-6	see Evacuating and charging equipment
M-HDL-6-B	see Service manifolds, gauges and charging hoses
M-HDL-6-R	see Service manifolds, gauges and charging hoses
MI-CAP	see Fluid control components
MIR-1	see Service manifolds, gauges and charging hoses
MIR-1	see Tube working tools
MIR-1R	see Tube working tools
MIR-2	see Tube working tools
MIR-2	see Service manifolds, gauges and charging hoses
MIR-2R	see Tube working tools
MIR-3	see Tube working tools
MIR-3R	see Tube working tools
MIR-4	see Tube working tools
MIR-4R	see Tube working tools
MIR-5	see Tube working tools
MIR-5R	see Tube working tools
MK-040-DS	see Evacuating and charging equipment
MK-060-DS	see Evacuating and charging equipment
MK-120-DS	see Evacuating and charging equipment
MK-180-DS	see Evacuating and charging equipment
MK-240-DS	see Evacuating and charging equipment
MK-280-DS	see Evacuating and charging equipment
M-MM-02	see Forged brass & steel fittings "NPT" & "NPT 45" SAE
M-MM-03	see Forged brass & steel fittings "NPT" & "NPT 45" SAE
M-MM-04	see Forged brass & steel fittings "NPT" & "NPT 45" SAE
M-MM-06	see Forged brass & steel fittings "NPT" & "NPT 45" SAE
M-MM-08	see Forged brass & steel fittings "NPT" & "NPT 45" SAE
M-MM-10	see Forged brass & steel fittings "NPT" & "NPT 45" SAE
M-MM-12	see Forged brass & steel fittings "NPT" & "NPT 45" SAE
M-MM-16	see Forged brass & steel fittings "NPT" & "NPT 45" SAE
MMS-200	see Fluid control components
MMS-80	see Fluid control components
MP-02	see Refrigeration accessories
MP-02C	see Refrigeration accessories
MP-03	see Refrigeration accessories
MP-03C	see Refrigeration accessories
MP-04	see Refrigeration accessories
MP-04C	see Refrigeration accessories
MP-06	see Refrigeration accessories
MP-06C	see Refrigeration accessories
MP-08	see Refrigeration accessories
MP-08C	see Refrigeration accessories
MP-12	see Refrigeration accessories
MP-12C	see Refrigeration accessories
MP-18	see Refrigeration accessories
MP-18C	see Refrigeration accessories
MPF-M10	see Refrigeration accessories
MPF-M12	see Refrigeration accessories
MPF-M16	see Refrigeration accessories
MPR-M08	see Refrigeration accessories
MPR-M10	see Refrigeration accessories
MPR-M12	see Refrigeration accessories
MPR-M16	see Refrigeration accessories
MR-14-BH	see Service manifolds, gauges and charging hoses
MR-14-RH	see Service manifolds, gauges and charging hoses
MR-14-VK	see Service manifolds, gauges and charging hoses
MR-14-VS	see Service manifolds, gauges and charging hoses
MR-MM-032	see Forged brass & steel fittings "NPT" & "NPT 45" SAE
MR-MM-042	see Forged brass & steel fittings "NPT" & "NPT 45" SAE
MR-MM-043	see Forged brass & steel fittings "NPT" & "NPT 45" SAE
MR-MM-064	see Forged brass & steel fittings "NPT" & "NPT 45" SAE
MR-MM-084	see Forged brass & steel fittings "NPT" & "NPT 45" SAE
MR-MM-082	see Forged brass & steel fittings "NPT" & "NPT 45" SAE
MR-MM-086	see Forged brass & steel fittings "NPT" & "NPT 45" SAE
MR-MM-106	see Forged brass & steel fittings "NPT" & "NPT 45" SAE
MR-MM-108	see Forged brass & steel fittings "NPT" & "NPT 45" SAE
MS-04	see Fluid control components
MS-06	see Fluid control components
MS-08	see Fluid control components
MS-10	see Fluid control components
MS-12	see Fluid control components
MS-14	see Fluid control components
MS-18	see Fluid control components
MS-22	see Fluid control components
MS-26	see Fluid control components

Part. nr.	Pdf file
MS-34	see Fluid control components
MSK-08	see Tube working tools
MSSK-26	see Tube working tools
MT-02	see Forged brass & steel fittings "NPT" & "NPT 45" SAE"
MT-03	see Forged brass & steel fittings "NPT" & "NPT 45" SAE"
MT-04	see Forged brass & steel fittings "NPT" & "NPT 45" SAE"
MT-06	see Forged brass & steel fittings "NPT" & "NPT 45" SAE"
MT-08	see Forged brass & steel fittings "NPT" & "NPT 45" SAE"
MT-10	see Forged brass & steel fittings "NPT" & "NPT 45" SAE"
MT-12	see Forged brass & steel fittings "NPT" & "NPT 45" SAE"
MT-16	see Forged brass & steel fittings "NPT" & "NPT 45" SAE"
MT-20	see Forged brass & steel fittings "NPT" & "NPT 45" SAE"
MT-24	see Forged brass & steel fittings "NPT" & "NPT 45" SAE"
MTS-04	see Fluid control components
MTS-06	see Fluid control components
MTU-06	see Copper tubes, coils & solder fittings (Inch & Metric)
MTU-08	see Copper tubes, coils & solder fittings (Inch & Metric)
MTU-10	see Copper tubes, coils & solder fittings (Inch & Metric)
MTU-12	see Copper tubes, coils & solder fittings (Inch & Metric)
MTU-15	see Copper tubes, coils & solder fittings (Inch & Metric)
MTU-16	see Copper tubes, coils & solder fittings (Inch & Metric)
MTU-18	see Copper tubes, coils & solder fittings (Inch & Metric)
MTU-22	see Copper tubes, coils & solder fittings (Inch & Metric)
MTU-28	see Copper tubes, coils & solder fittings (Inch & Metric)
MTU-35	see Copper tubes, coils & solder fittings (Inch & Metric)
MULTI-R-COMBI/V2	see Evacuating and charging equipment
MV-0077	see Automatic access valves & fittings
MV-0099	see Automatic access valves & fittings
MV-0101	see Automatic access valves & fittings
MV-0111	see Automatic access valves & fittings
MV-1010	see Automatic access valves & fittings
MV-1050	see Automatic access valves & fittings
MV-1060	see Automatic access valves & fittings
MV-1080	see Automatic access valves & fittings
MV-1200	see Automatic access valves & fittings
MV-1212	see Automatic access valves & fittings
MV-1414	see Automatic access valves & fittings
MV-1414C	see Automatic access valves & fittings
MV-1428	see Automatic access valves & fittings
MV-1438	see Automatic access valves & fittings
MV-1440	see Automatic access valves & fittings
MV-1441	see Automatic access valves & fittings
MV-1444	see Automatic access valves & fittings
MV-1446	see Automatic access valves & fittings
MV-1454	see Automatic access valves & fittings
MV-1777	see Automatic access valves & fittings
MV-1808	see Automatic access valves & fittings
MV-1818	see Automatic access valves & fittings
MV-1818C	see Automatic access valves & fittings
MV-2000	see Automatic access valves & fittings
MV-2010	see Automatic access valves & fittings
MV-2010 (QC-E4)	see Automatic access valves & fittings
MV-2012	see Automatic access valves & fittings
MV-2014	see Automatic access valves & fittings
MV-2018	see Automatic access valves & fittings
MV-2019	see Automatic access valves & fittings
MV-2020	see Automatic access valves & fittings
MV-2022	see Automatic access valves & fittings
MV-2022	see Automatic access valves & fittings
MV-2024	see Automatic access valves & fittings
MV-2028	see Automatic access valves & fittings
MV-2035	see Automatic access valves & fittings
MV-2037	see Automatic access valves & fittings
MV-2038	see Automatic access valves & fittings
MV-2041	see Automatic access valves & fittings
MV-2050	see Automatic access valves & fittings
MV-2060	see Automatic access valves & fittings
MV-2070	see Automatic access valves & fittings
MV-2070	see Automatic access valves & fittings
MV-2090	see Automatic access valves & fittings
MV-2094	see Automatic access valves & fittings
MV-2098	see Automatic access valves & fittings
MV-2120	see Automatic access valves & fittings
MV-2140	see Automatic access valves & fittings
MV-2160	see Automatic access valves & fittings
MV-2210	see Automatic access valves & fittings
MV-2215	see Automatic access valves & fittings
MV-2216	see Automatic access valves & fittings
MV-2219	see Automatic access valves & fittings
MV-2220	see Automatic access valves & fittings
MV-2225	see Automatic access valves & fittings
MV-2235	see Automatic access valves & fittings
MV-2243	see Automatic access valves & fittings
MV-2245	see Automatic access valves & fittings
MV-2245	see Forged brass & steel fittings "NPT" & "NPT 45" SAE"
MV-2250	see Automatic access valves & fittings
MV-2380	see Automatic access valves & fittings
MV-2500	see Automatic access valves & fittings
MV-2525	see Automatic access valves & fittings
MV-2540	see Automatic access valves & fittings
MV-2541	see Automatic access valves & fittings
MV-2542	see Automatic access valves & fittings
MV-2580	see Automatic access valves & fittings
MV-2594	see Automatic access valves & fittings
MV-2595	see Automatic access valves & fittings

[illegible][illegible]

Part. nr.	Pdf file
QCS-5/16x1/4	see Service manifolds, gauges and charging hoses
QCS-5/16x1/4	see Automatic access valves & fittings
QC-S64	see Automatic access valves & fittings
QVA-03	see Automatic access valves & fittings
QVA-03	see Evacuating and charging equipment
QVA-03	see Service manifolds, gauges and charging hoses
QVA-05	see Evacuating and charging equipment
QVA-05	see Service manifolds, gauges and charging hoses
QVA-05	see Automatic access valves & fittings
QVA-103	see Automatic access valves & fittings
QVA-105	see Automatic access valves & fittings
QVA-SET	see Automatic access valves & fittings
QVA-SET1	see Automatic access valves & fittings
QWIKCHECK	see Refrigeration accessories
R-600A-BP	see Service manifolds, gauges and charging hoses
R-600A-HP	see Service manifolds, gauges and charging hoses
RA-500	see Electronic measurement and control instruments
RA-500P	see Electronic measurement and control instruments
RACK-06	see Tube working tools
RACK-08	see Tube working tools
RB-1	see Tube working tools
RB-4240	see Service manifolds, gauges and charging hoses
RB-4240	see Copper tubes, coils & solder fittings (Inch & Metric)
RCH-10	see Evacuating and charging equipment
RCH-10	see Evacuating and charging equipment
RCH-10	see Evacuating and charging equipment
RCH-10	see Refrigeration accessories
RCO-420	see Refrigeration accessories
RCYL-12L	see Evacuating and charging equipment
RCYL-30L	see Evacuating and charging equipment
RCYL-50L	see Evacuating and charging equipment
RED-FF-S-0021	see Forged brass & steel fittings "NPT" & "NPT 45" SAE"
RED-FF-S-0032	see Forged brass & steel fittings "NPT" & "NPT 45" SAE"
RED-FF-S-0042	see Forged brass & steel fittings "NPT" & "NPT 45" SAE"
RED-FF-S-0043	see Forged brass & steel fittings "NPT" & "NPT 45" SAE"
RED-FF-S-0062	see Forged brass & steel fittings "NPT" & "NPT 45" SAE"
RED-FF-S-0063	see Forged brass & steel fittings "NPT" & "NPT 45" SAE"
RED-FF-S-0064	see Forged brass & steel fittings "NPT" & "NPT 45" SAE"
RED-FF-S-0082	see Forged brass & steel fittings "NPT" & "NPT 45" SAE"
RED-FF-S-0083	see Forged brass & steel fittings "NPT" & "NPT 45" SAE"
RED-FF-S-0084	see Forged brass & steel fittings "NPT" & "NPT 45" SAE"
RED-FF-S-0086	see Forged brass & steel fittings "NPT" & "NPT 45" SAE"
RED-FF-S-0102	see Forged brass & steel fittings "NPT" & "NPT 45" SAE"
RED-FF-S-0103	see Forged brass & steel fittings "NPT" & "NPT 45" SAE"
RED-FF-S-0104	see Forged brass & steel fittings "NPT" & "NPT 45" SAE"
RED-FF-S-0106	see Forged brass & steel fittings "NPT" & "NPT 45" SAE"
RED-FF-S-0108	see Forged brass & steel fittings "NPT" & "NPT 45" SAE"
RED-FF-S-0122	see Forged brass & steel fittings "NPT" & "NPT 45" SAE"
RED-FF-S-0123	see Forged brass & steel fittings "NPT" & "NPT 45" SAE"
RED-FF-S-0124	see Forged brass & steel fittings "NPT" & "NPT 45" SAE"
RED-FF-S-0126	see Forged brass & steel fittings "NPT" & "NPT 45" SAE"
RED-FF-S-0128	see Forged brass & steel fittings "NPT" & "NPT 45" SAE"
RED-FF-S-0162	see Forged brass & steel fittings "NPT" & "NPT 45" SAE"
RED-FF-S-0163	see Forged brass & steel fittings "NPT" & "NPT 45" SAE"
RED-FF-S-0164	see Forged brass & steel fittings "NPT" & "NPT 45" SAE"
RED-FF-S-0166	see Forged brass & steel fittings "NPT" & "NPT 45" SAE"
RED-FF-S-0168	see Forged brass & steel fittings "NPT" & "NPT 45" SAE"
RED-FF-S-0208	see Forged brass & steel fittings "NPT" & "NPT 45" SAE"
RED-FF-S-1210	see Forged brass & steel fittings "NPT" & "NPT 45" SAE"
RED-FF-S-1612	see Forged brass & steel fittings "NPT" & "NPT 45" SAE"
RED-FF-S-2012	see Forged brass & steel fittings "NPT" & "NPT 45" SAE"
RED-FF-S-2016	see Forged brass & steel fittings "NPT" & "NPT 45" SAE"
RED-FF-S-2412	see Forged brass & steel fittings "NPT" & "NPT 45" SAE"
RED-FF-S-2416	see Forged brass & steel fittings "NPT" & "NPT 45" SAE"
RED-FF-S-2420	see Forged brass & steel fittings "NPT" & "NPT 45" SAE"
RED-MF-0032	see Forged brass & steel fittings "NPT" & "NPT 45" SAE"
RED-MF-0042	see Forged brass & steel fittings "NPT" & "NPT 45" SAE"
RED-MF-0043	see Forged brass & steel fittings "NPT" & "NPT 45" SAE"
RED-MF-0062	see Forged brass & steel fittings "NPT" & "NPT 45" SAE"
RED-MF-0064	see Forged brass & steel fittings "NPT" & "NPT 45" SAE"
RED-MF-0084	see Forged brass & steel fittings "NPT" & "NPT 45" SAE"
RED-MF-0086	see Forged brass & steel fittings "NPT" & "NPT 45" SAE"
RED-MF-0106	see Forged brass & steel fittings "NPT" & "NPT 45" SAE"
RED-MF-0108	see Forged brass & steel fittings "NPT" & "NPT 45" SAE"
RED-MF-0128	see Forged brass & steel fittings "NPT" & "NPT 45" SAE"
RED-MF-1210	see Forged brass & steel fittings "NPT" & "NPT 45" SAE"
RED-MF-S-0032	see Forged brass & steel fittings "NPT" & "NPT 45" SAE"
RED-MF-S-0042	see Forged brass & steel fittings "NPT" & "NPT 45" SAE"
RED-MF-S-0043	see Forged brass & steel fittings "NPT" & "NPT 45" SAE"
RED-MF-S-0062	see Forged brass & steel fittings "NPT" & "NPT 45" SAE"
RED-MF-S-0063	see Forged brass & steel fittings "NPT" & "NPT 45" SAE"
RED-MF-S-0064	see Forged brass & steel fittings "NPT" & "NPT 45" SAE"
RED-MF-S-0082	see Forged brass & steel fittings "NPT" & "NPT 45" SAE"
RED-MF-S-0083	see Forged brass & steel fittings "NPT" & "NPT 45" SAE"
RED-MF-S-0084	see Forged brass & steel fittings "NPT" & "NPT 45" SAE"
RED-MF-S-0086	see Forged brass & steel fittings "NPT" & "NPT 45" SAE"
RED-MF-S-0104	see Forged brass & steel fittings "NPT" & "NPT 45" SAE"
RED-MF-S-0106	see Forged brass & steel fittings "NPT" & "NPT 45" SAE"
RED-MF-S-0108	see Forged brass & steel fittings "NPT" & "NPT 45" SAE"
RED-MF-S-0122	see Forged brass & steel fittings "NPT" & "NPT 45" SAE"
RED-MF-S-0123	see Forged brass & steel fittings "NPT" & "NPT 45" SAE"
RED-MF-S-0124	see Forged brass & steel fittings "NPT" & "NPT 45" SAE"
RED-MF-S-0126	see Forged brass & steel fittings "NPT" & "NPT 45" SAE"
RED-MF-S-0128	see Forged brass & steel fittings "NPT" & "NPT 45" SAE"
RED-MF-S-0164	see Forged brass & steel fittings "NPT" & "NPT 45" SAE"

Part. nr.	Pdf file
SUNISO-4GS-20	see Refrigeration accessories
SUNISO-5G-04	see Refrigeration accessories
SUNISO-SL32-04	see Refrigeration accessories
SUPER-3790	see Refrigeration accessories
SUPER-947	see Refrigeration accessories
SV2W-38/110	see Evacuating and charging equipment
SV2W-38/220	see Evacuating and charging equipment
SV2W-38/627-VRP-110	see Evacuating and charging equipment
SV2W-38/627-VRP-220	see Evacuating and charging equipment
SWM-4D-41	see Tube working tools
T1-04A	see Forged brass & steel fittings "NPT" & "NPT 45" SAE
T1-04B	see Forged brass & steel fittings "NPT" & "NPT 45" SAE
T1-04C	see Forged brass & steel fittings "NPT" & "NPT 45" SAE
T1-06B	see Forged brass & steel fittings "NPT" & "NPT 45" SAE
T1-06C	see Forged brass & steel fittings "NPT" & "NPT 45" SAE
T1-08C	see Forged brass & steel fittings "NPT" & "NPT 45" SAE
T1-08D	see Forged brass & steel fittings "NPT" & "NPT 45" SAE
T1-10C	see Forged brass & steel fittings "NPT" & "NPT 45" SAE
T1-10D	see Forged brass & steel fittings "NPT" & "NPT 45" SAE
T2-04	see Forged brass & steel fittings "NPT" & "NPT 45" SAE
T2-05	see Forged brass & steel fittings "NPT" & "NPT 45" SAE
T2-06	see Forged brass & steel fittings "NPT" & "NPT 45" SAE
T2-08	see Forged brass & steel fittings "NPT" & "NPT 45" SAE
T2-10	see Forged brass & steel fittings "NPT" & "NPT 45" SAE
T2-12	see Forged brass & steel fittings "NPT" & "NPT 45" SAE
T3-04A	see Forged brass & steel fittings "NPT" & "NPT 45" SAE
T3-04B	see Forged brass & steel fittings "NPT" & "NPT 45" SAE
T3-06B	see Forged brass & steel fittings "NPT" & "NPT 45" SAE
T3-08D	see Forged brass & steel fittings "NPT" & "NPT 45" SAE
T3-10D	see Forged brass & steel fittings "NPT" & "NPT 45" SAE
T3-12E	see Forged brass & steel fittings "NPT" & "NPT 45" SAE
T3F-02	see Forged brass & steel fittings "NPT" & "NPT 45" SAE
T3F-03	see Forged brass & steel fittings "NPT" & "NPT 45" SAE
T3F-04	see Forged brass & steel fittings "NPT" & "NPT 45" SAE
T3F-06	see Forged brass & steel fittings "NPT" & "NPT 45" SAE
T3F-08	see Forged brass & steel fittings "NPT" & "NPT 45" SAE
T3F-10	see Forged brass & steel fittings "NPT" & "NPT 45" SAE
T3F-12	see Forged brass & steel fittings "NPT" & "NPT 45" SAE
T3F-16	see Forged brass & steel fittings "NPT" & "NPT 45" SAE
T3F-S-02	see Forged brass & steel fittings "NPT" & "NPT 45" SAE
T3F-S-03	see Forged brass & steel fittings "NPT" & "NPT 45" SAE
T3F-S-04	see Forged brass & steel fittings "NPT" & "NPT 45" SAE
T3F-S-06	see Forged brass & steel fittings "NPT" & "NPT 45" SAE
T3F-S-08	see Forged brass & steel fittings "NPT" & "NPT 45" SAE
T3F-S-10	see Forged brass & steel fittings "NPT" & "NPT 45" SAE
T3F-S-12	see Forged brass & steel fittings "NPT" & "NPT 45" SAE
T3F-S-16	see Forged brass & steel fittings "NPT" & "NPT 45" SAE
T3F-S-20	see Forged brass & steel fittings "NPT" & "NPT 45" SAE
T3F-S-24	see Forged brass & steel fittings "NPT" & "NPT 45" SAE
T6-4	see Forged brass & steel fittings "NPT" & "NPT 45" SAE
TAHL-5	see Electronic measurement and control instruments
TB-03	see Tube working tools
TB-06	see Tube working tools
TB-06	see Service manifolds, gauges and charging hoses
TB-16	see Tube working tools
TB-16	see Service manifolds, gauges and charging hoses
TB-364-04	see Tube working tools
TB-364-05/8mm	see Tube working tools
TB-364-05/8mm	see Tube working tools
TB-364-06	see Tube working tools
TB-364-06mm	see Tube working tools
TB-364-08	see Tube working tools
TB-364-10	see Tube working tools
TB-364-10mm	see Tube working tools
TB-364-12	see Tube working tools
TB-364-12/H	see Tube working tools
TB-364-12mm	see Tube working tools
TB-364-15mm	see Tube working tools
TB-364-16mm	see Tube working tools
TC-0316	see Tube working tools
TC-0316-H	see Tube working tools
TC-0328	see Tube working tools
TC-0328-H	see Tube working tools
TC-0432-ZR	see Tube working tools
TC-0432-ZRH	see Tube working tools
TC-0638-R	see Tube working tools
TC-0638-RH	see Tube working tools
TC-1000	see Tube working tools
TC-1000-SP	see Tube working tools
TC-10168-Z	see Tube working tools
TC-10168-ZC	see Tube working tools
TC-1020	see Tube working tools
TC-1050	see Tube working tools
TC-1050-SP	see Tube working tools
TC-127	see Service manifolds, gauges and charging hoses
TC-127	see Tube working tools
TC-2050	see Tube working tools
TC-206	see Tube working tools
TC-274	see Service manifolds, gauges and charging hoses
TC-274	see Service manifolds, gauges and charging hoses
TC-274	see Tube working tools
TC-274	see Service manifolds, gauges and charging hoses
TC-307	see Service manifolds, gauges and charging hoses
TC-307	see Tube working tools
TC-312	see Tube working tools

[illegible]

Part. nr.	Pdf file
VASC-10 mm	see Fluid control components
VASC-11	see Fluid control components
VASC-12 mm	see Fluid control components
VASC-16 mm	see Fluid control components
VASC-18 mm	see Fluid control components
VASC-22 mm	see Fluid control components
VASC-28 mm	see Fluid control components
VASC-35 mm	see Fluid control components
VASC-42 mm	see Fluid control components
VASC-54 mm	see Fluid control components
VASC-82	see Fluid control components
VASC-83	see Fluid control components
VASC-84	see Fluid control components
VASC-85	see Fluid control components
VASC-86	see Fluid control components
VG-10	see Tube working tools
VG-12	see Tube working tools
VG-12ING	see Tube working tools
VG-14	see Tube working tools
VG-14G	see Tube working tools
VG-14I	see Tube working tools
VG-15	see Tube working tools
VG-16	see Tube working tools
VG-17	see Tube working tools
VG-18	see Tube working tools
VG-19	see Tube working tools
VN—05-13/1056/V2	see Refrigeration accessories
VN—10-20/1103/V2	see Refrigeration accessories
VNT—18-30/46/V2	see Refrigeration accessories
VNT—25-40/25/V2	see Refrigeration accessories
VNT—34-45/25/V2	see Refrigeration accessories
VOC-10	see Tube working tools
VOC-10	see Fluid control components
VOC-15	see Tube working tools
VOC-15	see Fluid control components
VOC-18	see Tube working tools
VOC-18	see Fluid control components
VPC-40	see Evacuating and charging equipment
VPF-40	see Evacuating and charging equipment
VT-400	see Evacuating and charging equipment
W3-V-80	see Service manifolds, gauges and charging hoses
WA-1000	see Tube working tools
WB-1	see Tube working tools
WBO-100	see Refrigeration accessories
WBO-100N	see Refrigeration accessories
WBO-120	see Refrigeration accessories
WBO-120N	see Refrigeration accessories
WBO-150R	see Refrigeration accessories
WBO-250	see Refrigeration accessories
WBO-K10	see Refrigeration accessories
WBO-K10N	see Refrigeration accessories
WBO-K12	see Refrigeration accessories
WBO-K12N	see Refrigeration accessories
WBO-K15	see Refrigeration accessories
WBO-K15R	see Refrigeration accessories
WBO-K25	see Refrigeration accessories
WCP-010/230V	see Refrigeration accessories
WCP-020/230V	see Refrigeration accessories
WDT-128-BODY	see Electronic measurement and control instruments
WDT-128C	see Electronic measurement and control instruments
WDT-128R	see Electronic measurement and control instruments
WKL-5	see Tube working tools
WM-80-B	see Service manifolds, gauges and charging hoses
WM-80-R	see Service manifolds, gauges and charging hoses
WPP-9	see Tube working tools
WS-005	see Electronic measurement and control instruments
WS-005-1L-1/4	see Electronic measurement and control instruments
WS-005-1L-5/16	see Electronic measurement and control instruments
WS-005-1L-7/16	see Electronic measurement and control instruments
WS-055	see Electronic measurement and control instruments
WS-150	see Electronic measurement and control instruments
WS-30	see Evacuating and charging equipment
WS-AC	see Electronic measurement and control instruments
WS-AC-EU	see Electronic measurement and control instruments
WS-AC-UK	see Electronic measurement and control instruments
WS-AC-USA	see Electronic measurement and control instruments
WS-ASV	see Electronic measurement and control instruments
WT-389	see Electronic measurement and control instruments
WT-389/P	see Electronic measurement and control instruments
XLD-6050	see Electronic measurement and control instruments
XPC-06M	see Tube working tools
XPC-07I	see Tube working tools
XPC-T	see Tube working tools
ZERICE	see Refrigeration accessories
ZEROL-150-5L	see Refrigeration accessories